

UNITED STATES
DEPARTMENT OF THE INTERIOR
BUREAU OF LAND MANAGEMENT

APPLICATION FOR PERMIT TO DRILL, DEEPEN, OR PLUG BACK

1a. TYPE OF WORK

DRILL ☒

DEEPEN ☐

PLUG BACK ☐

b. TYPE OF WELL

OIL
WELL ☒

GAS
WELL ☐

OTHER

SINGLE
ZONE ☐

MULTIPLE
ZONE ☐

2. NAME OF OPERATOR

McClellan Oil Corporation

3. ADDRESS OF OPERATOR

P. O. Dr. 730 Roswell, NM 88202

4. LOCATION OF WELL (Report location clearly and in accordance with any State requirements.)

At surface

1980' FNL & 660' FEL

At proposed prod. zone

SAME

14. DISTANCE IN MILES AND DIRECTION FROM NEAREST TOWN OR POST OFFICE*

7 miles east of Lake Arthur, NM

10. DISTANCE FROM PROPOSED*

LOCATION TO NEAREST
PROPERTY OR LEASE LINE, FT.
(Also to nearest drlg. unit line, if any)

660'

16. NO. OF ACRES IN LEASE

720

17. NO. OF ACRES ASSIGNED
TO THIS WELL

40

18. DISTANCE FROM PROPOSED LOCATION*
TO NEAREST WELL, DRILLING, COMPLETED,
OR APPLIED FOR, ON THIS LEASE, FT.

N/A

19. PROPOSED DEPTH

530'

20. ROTARY OR CABLE TOOLS

Rotary Air

21. ELEVATIONS (Show whether DF, RT, GR, etc.)

3463 GL

22. APPROX. DATE WORK WILL START*

December 29, 1988

23.

PROPOSED CASING AND CEMENTING PROGRAM

SIZE OF HOLE	SIZE OF CASING	WEIGHT PER FOOT	SETTING DEPTH	QUANTITY OF CEMENT
17"	13 3/8"	54.5#	40'	6 yds to set
7 7/8"	4 1/2"	10.5#	530'	150 ex "C" - circulate

Propose to drill a well to a depth of 530' to test the Queen formation. If commercial production is indicated, will run 4 1/2" casing and attempt completion.

Mud Program: None planned since well to be drilled with air. Will mud up if unexpected abnormal pressures encountered.

BOP Program: A Model 7068 rotating head with maximum of 1500 psi and steady pressure of 500 psi will be used. In the event of a gas encounter, gas will go out the blewey line and can be flared. If necessary will mud up normal way through mud pump. See Exhibit "E"

IN ABOVE SPACE DESCRIBE PROPOSED PROGRAM: If proposal is to deepen or plug back, give data on present productive zone and proposed new productive zone. If proposal is to drill or deepen directionally, give pertinent data on subsurface locations and measured and true vertical depths. Give blowout preventer program, if any.

24.

Agent for:

SIGNED

George R. Smith

TITLE

McClellan Oil Corp.

DATE

October 28, 1988

(This space for Federal or State office use)

PERMIT NO.

APPROVAL DATE

APPROVED BY

Area Manager

TITLE

S/Phil Kirk

DATE

DEC 5 1988

APPROVAL OF THIS APPLICATION DOES NOT WARRANT OR CERTIFY THAT THE APPLICANT HOLDS LEGAL OR EQUITABLE TITLE TO THOSE RIGHTS IN THE SUBJECT LEASE WHICH WOULD ENTITLE THE APPLICANT TO CONDUCT OPERATIONS THEREON.

PLEASE BE ADVISED THAT THERE WILL BE NO EXCAVATION OF FEDERALLY OWNED MINERAL MATERIAL FOR CONSTRUCTION OF THE ACCESS ROAD OR PAD WITHOUT PAYMENT IN ADVANCE.

Title 18 U.S.C. Section 1001, makes it a crime for any person knowingly and willfully to make to any department or agency of the United States any false, fictitious or fraudulent statements or representations as to any matter within its jurisdiction.

All distances must be from the outer boundaries of the Section.

Operator McClellan Oil Corporation			Lease L.A. Federal		Well No. 1
Unit Letter H	Section 30	Township 15 South	Range 27 East	County Chaves	
Actual Footage Location of Well:					
1980 feet from the North line and		660 feet from the East line			
Ground Level Elev. 3463	Producing Formation Queen	Pool Wildcat QUEEN	Dedicated Acreage: 40		Acre

1. Outline the acreage dedicated to the subject well by colored pencil or hatchure marks on the plat below.
2. If more than one lease is dedicated to the well, outline each and identify the ownership thereof (both as to working interest and royalty).
3. If more than one lease of different ownership is dedicated to the well, have the interests of all owners been consolidated by communitization, unitization, force-pooling, etc?

☐ Yes ☐ No If answer is "yes," type of consolidation _____

If answer is "no," list the owners and tract descriptions which have actually been consolidated. (Use reverse side of this form if necessary.) _____

No allowable will be assigned to the well until all interests have been consolidated (by communitization, unitization, forced-pooling, or otherwise) or until a non-standard unit, eliminating such interests, has been approved by the Division.

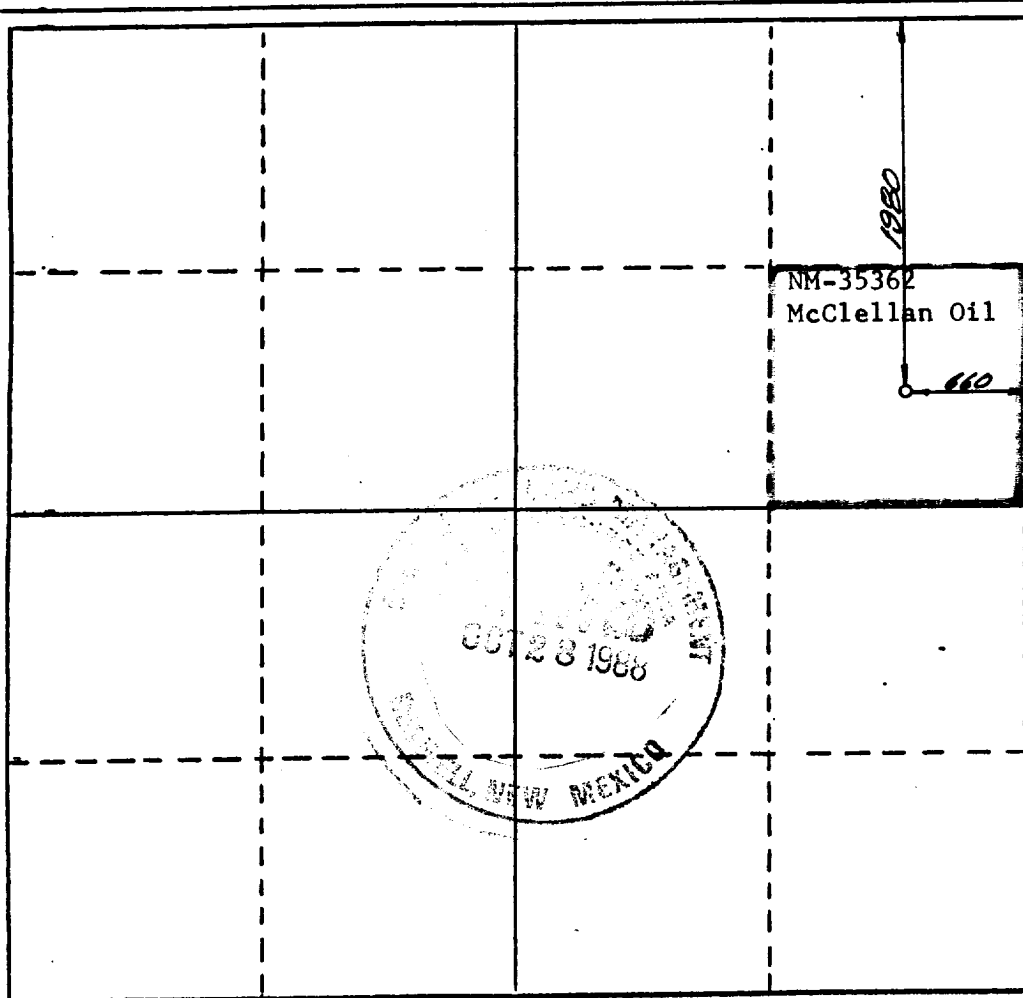
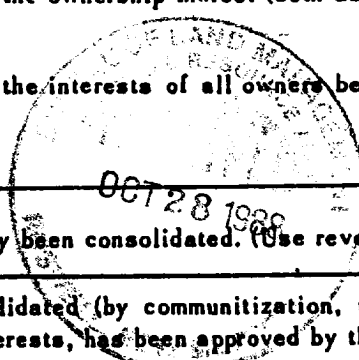

CERTIFICATION

I hereby certify that the information contained herein is true and complete to the best of my knowledge and belief.

Mark McClellan

Name
Mark McClellan
Position
Geologist
Company
McClellan Oil Corp.
Date
October 11, 1988

I hereby certify that the well location shown on this plat was plotted from field notes of actual surveys made by me or under my supervision, and that the same is true and correct to the best of my knowledge and belief.

7 October 1988

Date Surveyed
P.R. Patton
Registered Land Surveyor
8112
Certificate No. **1112**

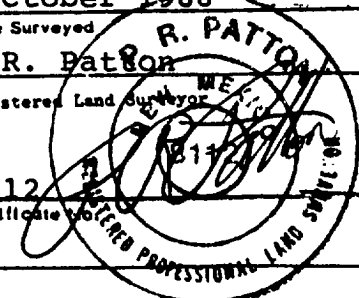

Model 7068



**for 10",
12",
and 13⁵/₈"
BOP
stacks.**

This model has an integral body with both side outlet and a lower API flange for mounting on the top of BOP stacks.

The 10" size is available in a standard and "Shorty" versions. The "Shorty", 7068-S, is approximately 30% shorter than the standard, an advantage in stacks where there is limited space beneath the table.

All heads have full bores when the drive bushing assembly is removed. The drive bushing assembly will pass a 17¹/₂" table, and is interchangeable with Model 8068.

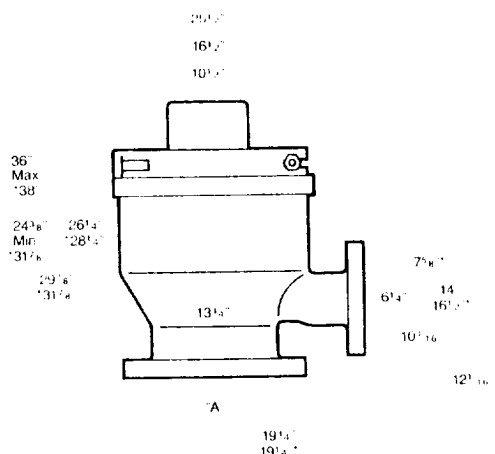
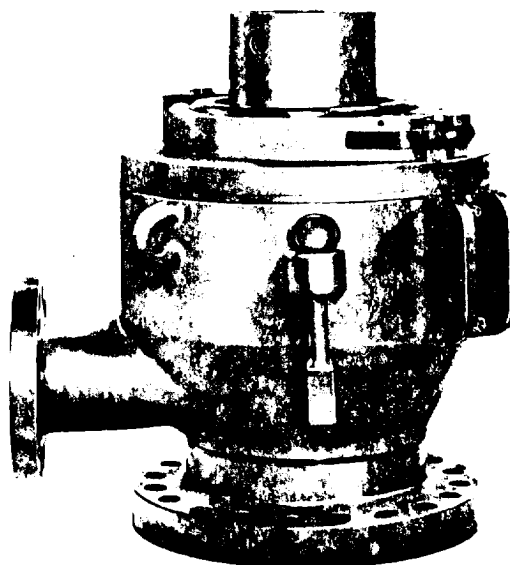

SPECIFICATIONS

SIZE	LOWER FLANGE	MAXIMUM BORE (A)	SIDE OUTLET	HEIGHT	
				W/STD. BUSHING	W/SHORT BUSHING
10"	10"-3000/5000# combination	11 1/4"	6"-2000#	36"	29 7/8"
10" SHORTY	10"-3000/5000# combination	11 1/4"	7" Threaded (Male)	—	24 3/8"
12"	12"-3000#	14"	6"-2000#	36"	29 7/8"
13 5/8" *	13 5/8"-5000#	13 5/8"	8"-2000#	38"	31 7/8"

KELLY BUSHINGS AVAILABLE: 3 1/2" Hex or Square, 4 1/4" Hex or Square, and 5 1/4" Hex only.

STRIPPER RUBBERS AVAILABLE: 2 7/8", 3 1/2", 4 1/2", 5" and 5 1/2".

(Stationary casing Stripper Rubbers from 6 5/8" thru 10 3/4" on special order).

Other sizes on special order.

When ordering, specify: (1) Model Number, (2) Lower Flange Size, (3) Kelly Size and (5) High Temperature Model, if desired.

EXHIBIT "E"
MCCLELLAN OIL CORPORATION
L. A. Federal, Well No. 1
BOP Specifications

APPLICATION FOR DRILLING

McCLELLAN OIL CORPORATION
L. A. Federal, Well No. 1
1980' FNL & 660' FEL, Sec. 30-T15S-R27E
Chaves County, New Mexico
Lease No.: NM-35362
(Exploratory Well)

In conjunction with Form 3160-3, Application for Permit to Drill subject well, McClellan Oil Corporation submits the following items of pertinent information in accordance with BLM requirements:

1. The geologic surface formation is recent Permian with quaternary alluvium and other surficial deposits.
2. The estimated tops of geologic markers are as follows:

Seven-Rivers	105'
Queen	480'
Total Depth	530'

3. The estimated depths at which water, oil or gas formations are anticipated to encountered:

Water: Surface water between 100' to 300'.

Oil: Queen at or below 480'.

Gas: None.

4. Proposed Casing Program: See Form 3160-3.
5. Pressure Control Equipment: See Form 3160-3 and Exhibit "E".
6. Mud Program: See Form 3160-3.
7. Auxiliary Equipment: Model 7068 rotating head.
8. Testing, Logging, and Coring Program:

Drill Stem Tests: None.

Logging: From surface casing to T.D.: CNL-Gamma Ray/Neutron.

Coring: None planned.

9. No abnormal pressures or temperatures are anticipated.
10. Anticipated starting date: December 29, 1988.
Anticipated completion of drilling operations: Approximately 5 days.



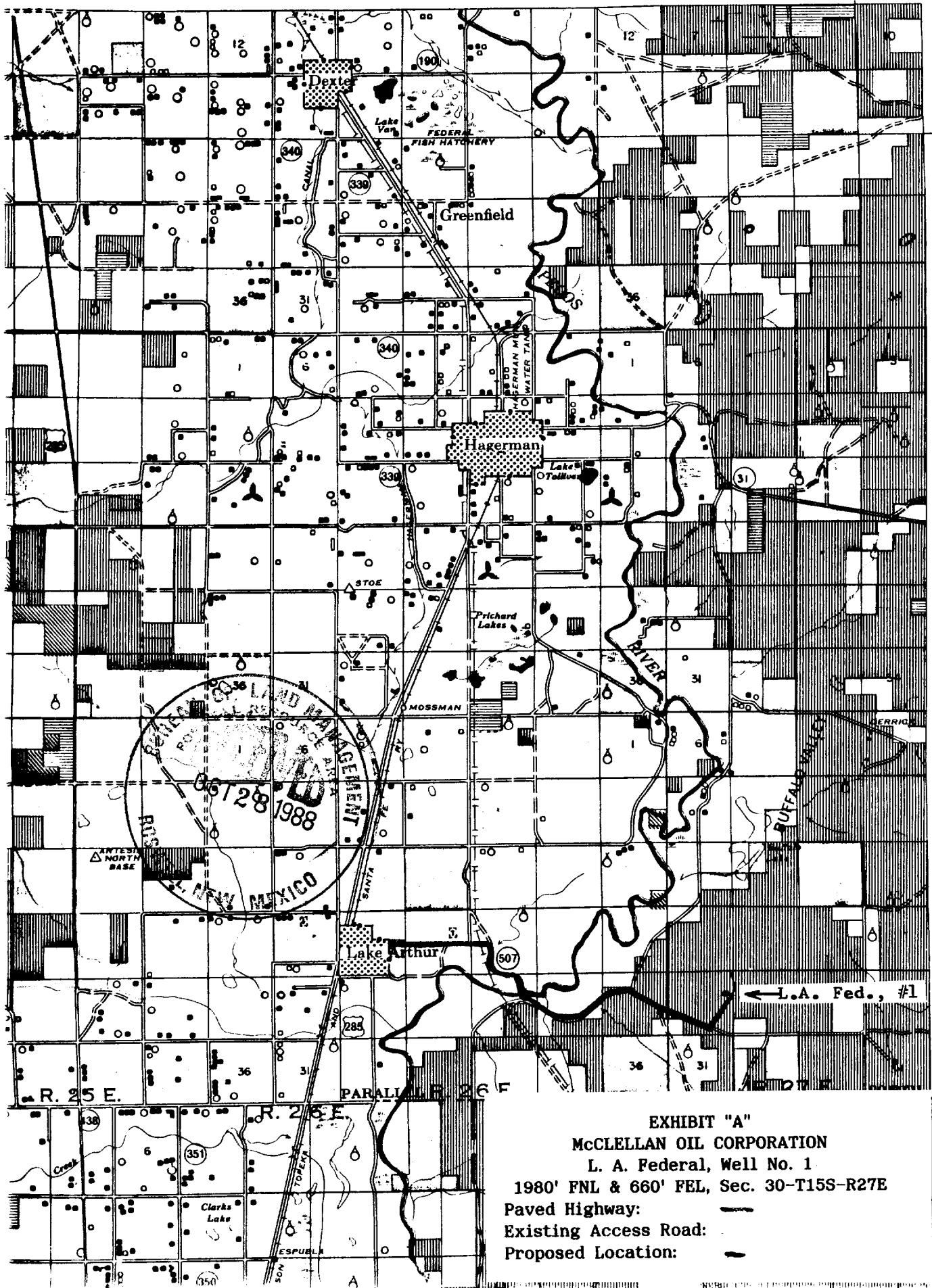

T. 13 S.

T. 14 S.

T. 15 S.

SE-19

EXHIBIT "A"

McCLELLAN OIL CORPORATION

L. A. Federal, Well No. 1

1980' FNL & 660' FEL, Sec. 30-T15S-R27E

Paved Highway: —

Existing Access Road: —

Proposed Location: —

East

Preferred location size @ 150' x 150' Minimum

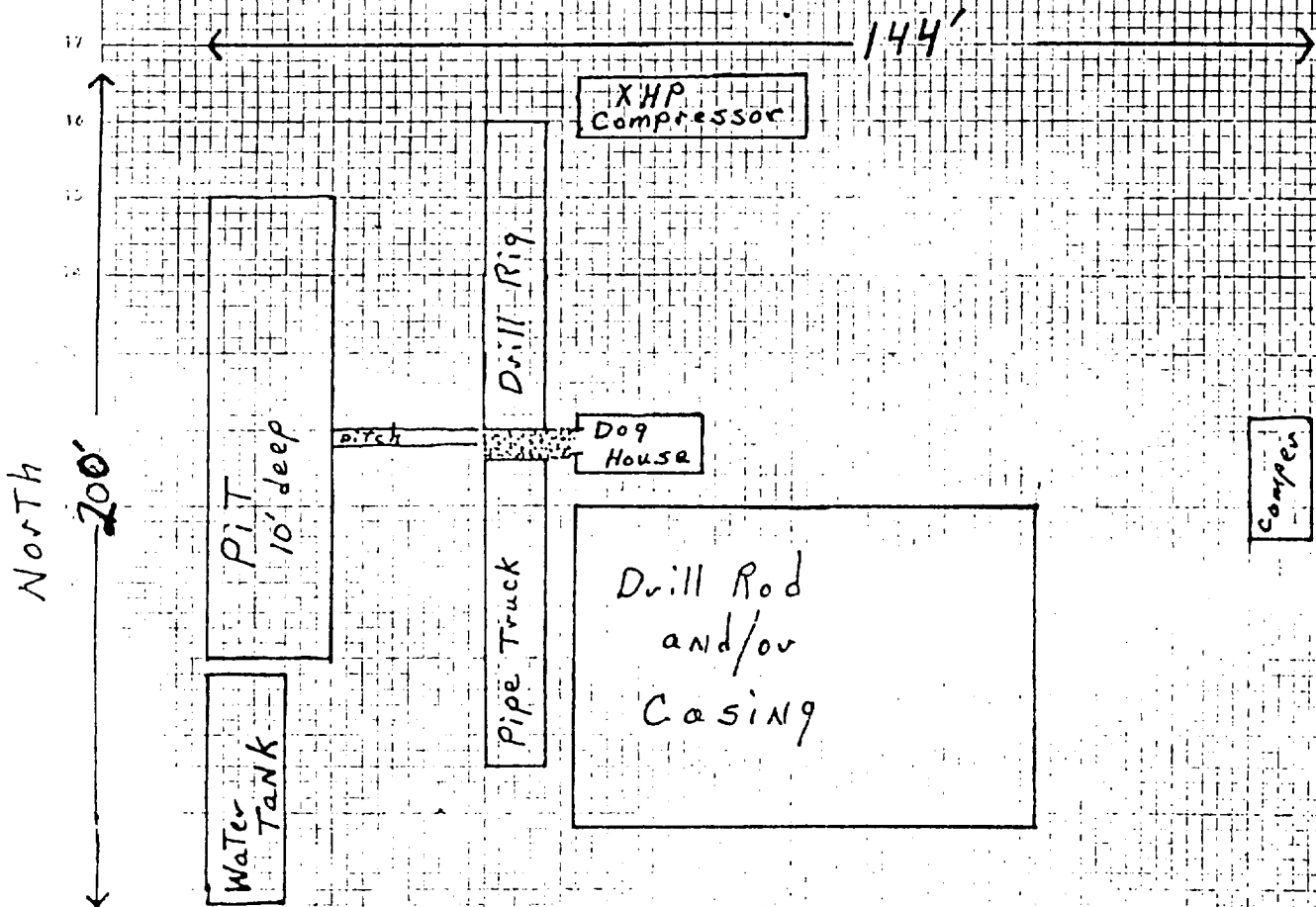

SCALE: 1 square = 2'



EXHIBIT "D"
McCLELLAN OIL CORPORATION
L. A. Federal, Well No. 1
Rig Layout

West