

NEW MEXICO OIL CONSERVATION COMMISSION  
WELL LOCATION AND ACREAGE DEDICATION PLAT

RECEIVED  
C-128  
Effective 1-1-65

Amended 27 1991

All distances must be from the outer boundaries of the Section.

Operator <b>SIETE OIL &amp; GAS CORPORATION</b>			Lease <b>Mojave Federal</b>			Well No. <b>O. G. D.</b>		
Unit Letter <b>P</b>	Section <b>15</b>	Township <b>15 South</b>	Range <b>27 East</b>	County <b>Chaves County, N.M.</b>				
Actual Footage Location of Well: <b>990</b> feet from the <b>South</b> line and <b>990</b> feet from the <b>East</b> line								
Ground Level Elev. <b>3461.</b>	Producing Formation <b>Atoka/Morrow</b>		Pool <b>Buffalo Valley Penn</b>			Dedicated Acreage: <b>320</b> Acres		

1. Outline the acreage dedicated to the subject well by colored pencil or hachure marks on the plat below.
2. If more than one lease is dedicated to the well, outline each and identify the ownership thereof (both as to working interest and royalty).
3. If more than one lease of different ownership is dedicated to the well, have the interests of all owners been consolidated by communitization, unitization, force-pooling, etc?

☐ Yes ☐ No If answer is "yes," type of consolidation \_\_\_\_\_

If answer is "no," list the owners and tract descriptions which have actually been consolidated. (Use reverse side of this form if necessary.) \_\_\_\_\_

No allowable will be assigned to the well until all interests have been consolidated (by communitization, unitization, forced-pooling, or otherwise) or until a non-standard unit, eliminating such interests, has been approved by the Commission.

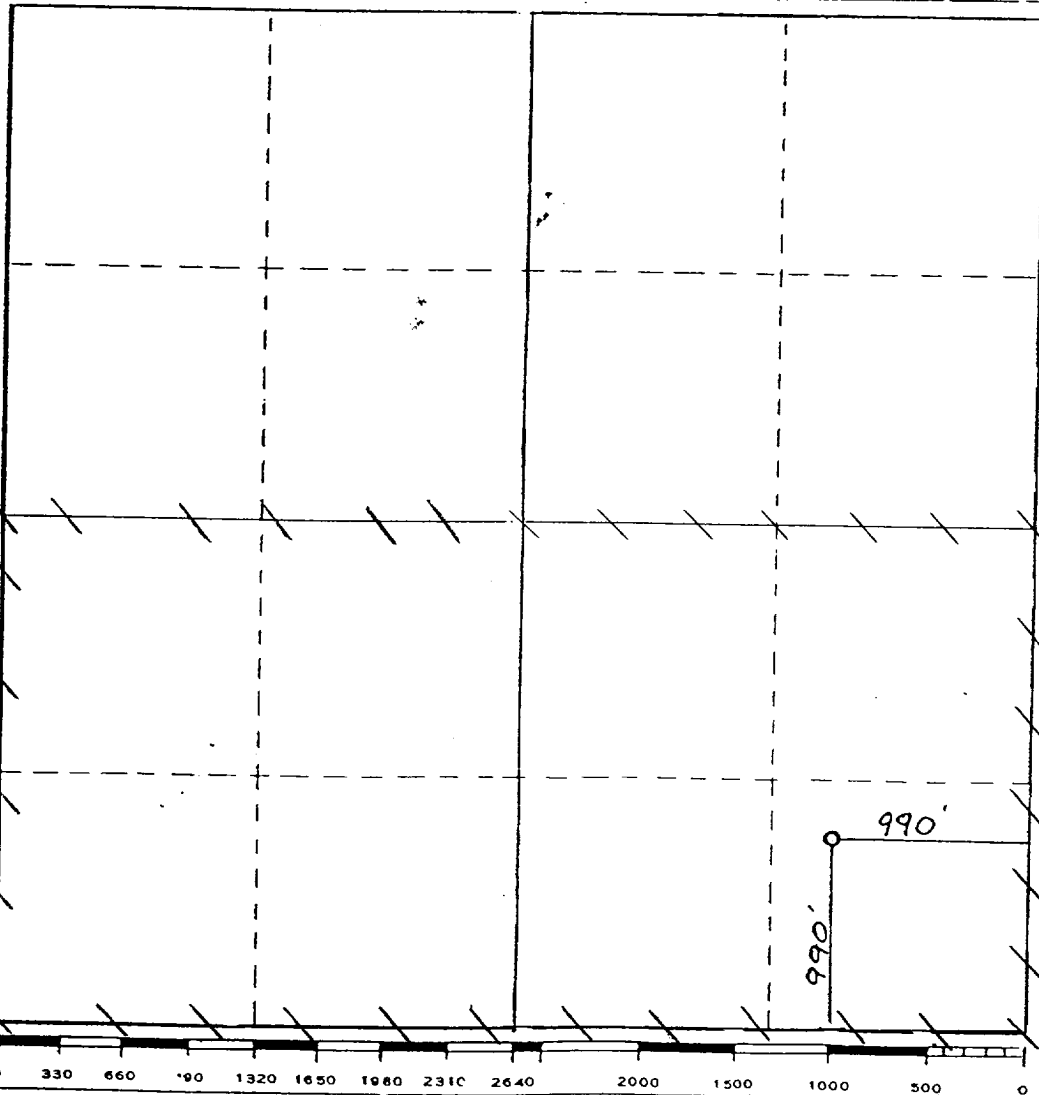

CERTIFICATION

I hereby certify that the information contained herein is true and complete to the best of my knowledge and belief.

*Cathy Batley-Jelly*  
Name

Drilling Technician  
Position  
Siete Oil and Gas Corporation

Company  
November, 26, 1991  
Date

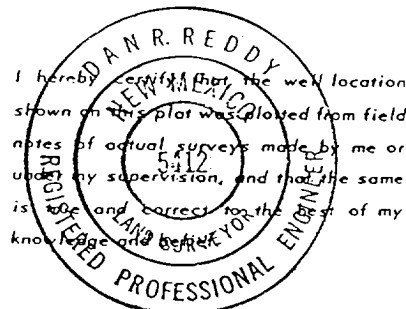

Date Surveyed  
February 13, 1991  
Registered Professional Engineer  
and/or Land Surveyor

*Dan R. Reddy*  
Certificate No.  
NM PE&PS NO. 5412