

DISTRICT I
1625 N. French Dr., Hobbs, NM 88240

DISTRICT II
811 South First, Artesia, NM 88210

DISTRICT III
1000 Rio Brazos Rd., Aztec, NM 87410

DISTRICT IV
2040 South Pacheco, Santa Fe, NM 87501

State of New Mexico
Energy, Minerals and Natural Resources Department
OIL CONSERVATION DIVISION
PO BOX 2088
Santa Fe, NM 87504-2088

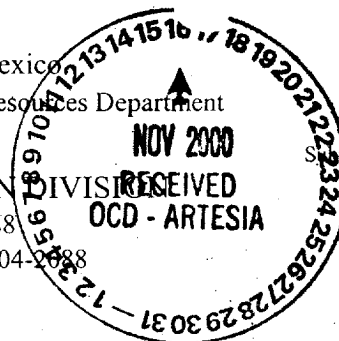

Form C-101
Revised March 17, 1999
Instructions on back
Submit to appropriate District Office
State Lease - 6 Copies
Fee Lease - 5 Copies

☐ AMENDED REPORT

APPLICATION FOR PERMIT TO DRILL, RE-ENTER, DEEPEN, PLUGBACK, OR ADD A ZONE

¹ Operator Name and Address Yates Petroleum Corporation 105 South Fourth Street Artesia, New Mexico 88210		² OGRID Number 025575
		³ API Number 30- 005- 63313
⁴ Property Code 24844	⁵ Property Name Windmill "ATI" State	⁶ Well No. 4

⁷ Surface Location

UL or lot no.	Section	Township	Range	Lot Idn	Feet from the	North/South Line	Feet from the	East/West Line	County
L	16	15S	28E		1650'	South	660'	West	Chaves

⁸ Proposed Bottom Hole Location If Different From Surface

UL or lot no.	Section	Township	Range	Lot Idn	Feet from the	North/South Line	Feet from the	East/West Line	County
⁹ Proposed Pool 1 Buffalo Valley					¹⁰ Proposed Pool 2				

¹¹ Work Type Code N	¹² Well Type Code G	¹³ Cable/Rotary R	¹⁴ Lease Type Code S	¹⁵ Ground Level Elevation 3570'
¹⁶ Multiple N	¹⁷ Proposed Depth 9300'	¹⁸ Formation Morrow	¹⁹ Contractor Not Determined	²⁰ Spud Date ASAP

Minimum WOC time / ²¹ Proposed Casing and Cement Program

Hole Size	Casing Size	Casing weight/feet	Setting Depth	Sacks of Cement	Estimated TOC
14 3/4	11 3/4	42#	400'	260 sx	Surface
11	8 5/8	24#	1900'	445 sx	**
7 7/8	5 1/2	17#	9300'	450 sx	**

**Cement to cover all oil, gas and waterbearing zones.

²² Describe the proposed program. If this application is to DEEPEN or PLUG BACK give the data on the present productive zone and proposed new productive zone. Describe the blowout prevention program, if any. Use additional sheets if necessary.

Yates Petroleum Corporation proposes to drill and test the Morrow and intermediate formations. Approximately 400' of surface casing will be set and cement circulated to shut off gravel and cavings. If commercial, production casing will be run and cemented, will perforate and stimulate as needed for production.

MUD PROGRAM: 0-400' FW/Native Mud; 400'-1900' Brine; 1900-8000' Cut Brine; 8000'-9300' Salt Gel/Starch

BOPE PROGRAM: A 3000# BOPE will be installed on the 8 5/8" casing and tested daily.

²³ I hereby certify that the information given above is true and complete to the best of my knowledge and belief.

Signature: *Pat Perez*

Printed name: Pat Perez

Title: Regulatory Agent

Date: 11/15/00

Phone: (505) 748-1471

OIL CONSERVATION DIVISION

Approved by:

Title:

Approval Date: NOV 19 2000

Expiration Date: NOV 15-01

Conditions of Approval

Attached ☐

DISTRICT I
1828 N. French Dr., Hobbs, NM 88240
DISTRICT II
811 South First, Artesia, NM 88210
DISTRICT III
1000 Rio Brazos Rd., Aztec, NM 87410
DISTRICT IV
2040 South Pacheco, Santa Fe, NM 87506

State of New Mexico
Energy, Minerals and Natural Resources Department

Form C-102
Revised March 17, 1999
Instruction on back
Submit to Appropriate District Office
State Lease - 4 Copies
Fee Lease - 3 Copies

OIL CONSERVATION DIVISION
P.O. Box 2088
Santa Fe, New Mexico 87504-2088

☐ AMENDED REPORT

WELL LOCATION AND ACREAGE DEDICATION PLAT

API Number	Pool Code	Pool Name Buffalo Valley
Property Code	Property Name WINDMILL "ATI" STATE	Well Number 4
OGED No. 025575	Operator Name YATES PETROLEUM CORPORATION	Elevation 3570

Surface Location

UL or lot No. L	Section 16	Township 15S	Range 28E	Lot Idn	Feet from the 1650	North/South line SOUTH	Feet from the 660	East/West line WEST	County CHAVES
--------------------	---------------	-----------------	--------------	---------	-----------------------	---------------------------	----------------------	------------------------	------------------

Bottom Hole Location If Different From Surface

UL or lot No.	Section	Township	Range	Lot Idn	Feet from the	North/South line	Feet from the	East/West line	County
Dedicated Acres	Joint or Infill	Consolidation Code	Order No.						

NO ALLOWABLE WILL BE ASSIGNED TO THIS COMPLETION UNTIL ALL INTERESTS HAVE BEEN CONSOLIDATED
OR A NON-STANDARD UNIT HAS BEEN APPROVED BY THE DIVISION

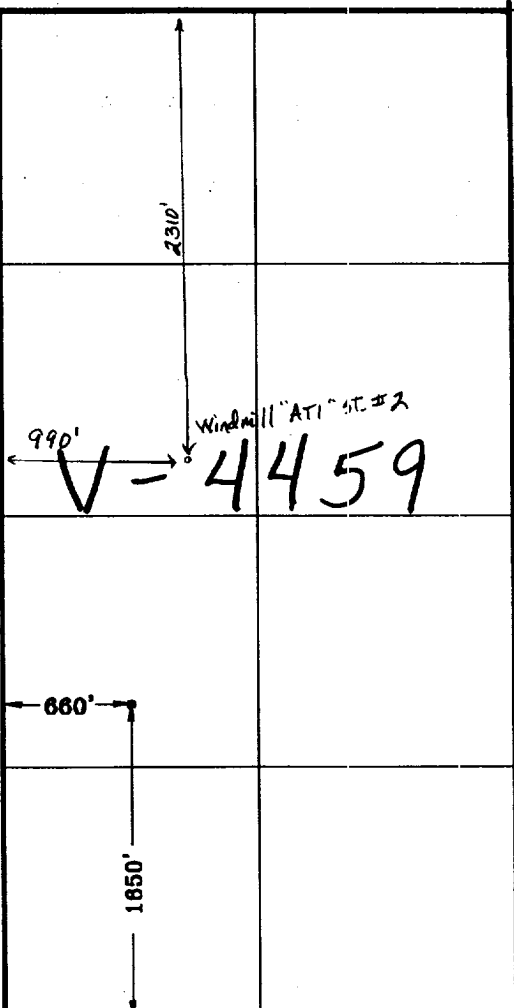
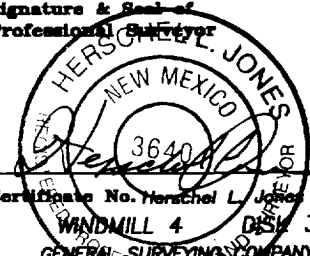
	OPERATOR CERTIFICATION I hereby certify the the information contained herein is true and complete to the best of my knowledge and belief. <u>Pat Perez</u> Signature <u>Pat Perez</u> Printed Name <u>Regulatory Agent</u> Title <u>November 15, 2000</u> Date			
	SURVEYOR CERTIFICATION I hereby certify that the well location shown on this plat was plotted from field notes of actual surveys made by me or under my supervision, and that the same is true and correct to the best of my belief. <u>10/26/2000</u> Date Surveyed Signature & Seal of Professional Surveyor  Certificate No. <u>Herschel L. Jones</u> RLS 3640 <u>WINDMILL 4</u> DISK 36 GENERAL SURVEYING COMPANY			

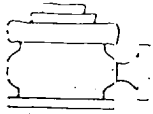

Yates Petroleum Corporation

BOP-3

Typical 3,000 psi Pressure System Schematic Annular with Double Ram Preventer Stack

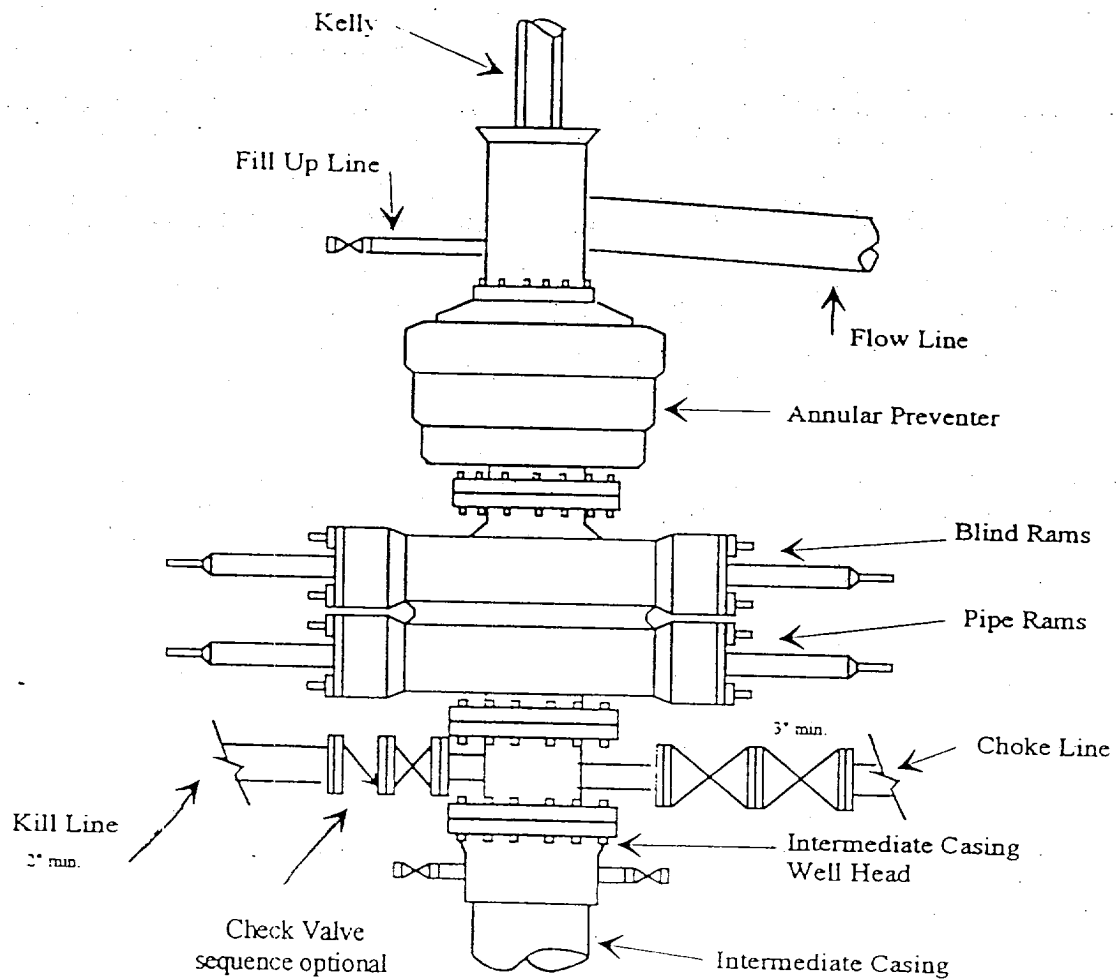

Typical 3,000 psi choke manifold assembly with at least these minimum features

