

U. S. Land Office _____
 Las Cruces
 Lease or permit No. _____
 069151-A

(NOV. 1936)
Indian Agency

Allottee

Lease No.

DEPA
ROBERT F. EVANS
ACTING DISTRICT ENGINEER

(SUBMIT IN TRIPLICATE)

UNITED STATES

DEPARTMENT OF THE INTERIOR

GEOLOGICAL SURVEY

SUNDRY NOTICES AND REPORTS ON WELLS

NOTICE OF INTENTION TO DRILL.....		SUBSEQUENT REPORT OF WATER SHUT-OFF.....	
NOTICE OF INTENTION TO CHANGE PLANS.....	X	SUBSEQUENT REPORT OF SHOOTING OR ACIDIZING.....	
NOTICE OF INTENTION TO TEST WATER SHUT-OFF.....	X	SUBSEQUENT REPORT OF ALTERING CASING.....	
NOTICE OF INTENTION TO RE-DRILL OR REPAIR WELL.....		SUBSEQUENT REPORT OF REDRILLING OR REPAIR.....	
NOTICE OF INTENTION TO SHOOT OR ACIDIZE.....		SUBSEQUENT REPORT OF ABANDONMENT.....	
NOTICE OF INTENTION TO PULL OR ALTER CASING.....		SUPPLEMENTARY WELL HISTORY.....	
NOTICE OF INTENTION TO ABANDON WELL.....			

(INDICATE ABOVE BY CHECK MARK NATURE OF REPORT, NOTICE, OR OTHER DATA)

Well No. 1-Federal is located 330 ft. from S line and 330 ft. from W line of sec. 11, April 11, 1956

(1/4 Sec. and Sec. 1b)

Empire Industries
 (Incorporated) (S-1)

(17)

~~(S)~~

U.S.P. Meridian

(County or Subdivision)

New ~~black~~ territory

The elevation of the derrick floor above sea level is 3515 ft.

APR 14 1959

DETAILS OF WORK

(State names of and expected depths to objective sands; show sizes, weights, and lengths of proposed casings; indicate mudding jobs, cementing points, and all other important proposed work)

We propose to drill to an expected depth of approximate 750 feet or production in the Seven Rivers, expected around 450 feet. We propose to set an approximate 300 feet 8 5/8" pipe, shut off surface water. If we make a well cement 7" on or through the pay section.

Approval is subject to State Engineer's regulations required on "application for permit to drill for oil" in Water Basin.

Box 810

Roswell, New Mexico

I understand that this plan of work must receive approval in writing by the Geological Survey before operations may be commenced.

Company ~~Bob Johnson~~

Address.....~~Box 577~~

~~Artesia, New Mexico~~

By

Title ~~Operator~~

DEPARTMENT OF THE ARMY
OFFICE OF THE CHIEF OF STAFF
WASHINGTON, D. C.

STANDARDIZATION AND REPORTING OF DATA

The purpose of this report is to provide a summary of the data collected during the study. The data was collected from a series of experiments conducted over a period of six months. The results of the experiments are presented in the following tables. The data shows that there is a significant correlation between the variables studied. The results of the experiments are presented in the following tables.

TABLE I. Summary of Data Collected During the Study.

The data was collected from a series of experiments conducted over a period of six months. The results of the experiments are presented in the following tables. The data shows that there is a significant correlation between the variables studied.

The results of the experiments are presented in the following tables. The data shows that there is a significant correlation between the variables studied.

TABLE II. Summary of Data Collected During the Study.

The data was collected from a series of experiments conducted over a period of six months. The results of the experiments are presented in the following tables. The data shows that there is a significant correlation between the variables studied.

The results of the experiments are presented in the following tables. The data shows that there is a significant correlation between the variables studied.

TABLE III. Summary of Data Collected During the Study.

The data was collected from a series of experiments conducted over a period of six months. The results of the experiments are presented in the following tables. The data shows that there is a significant correlation between the variables studied.

The results of the experiments are presented in the following tables. The data shows that there is a significant correlation between the variables studied.

TABLE IV. Summary of Data Collected During the Study.

The data was collected from a series of experiments conducted over a period of six months. The results of the experiments are presented in the following tables. The data shows that there is a significant correlation between the variables studied.

The results of the experiments are presented in the following tables. The data shows that there is a significant correlation between the variables studied.

TABLE V. Summary of Data Collected During the Study.

NEW MEXICO OIL CONSERVATION COMMISSION

WELL LOCATION AND ACREAGE DEDICATION PLAT

FORM C-128
Revised 5/1/57

SEE INSTRUCTIONS FOR COMPLETING THIS FORM ON THE REVERSE SIDE

SECTION A

Operator Bob Johnson			Lease LC 060157 - A			Well No. 1		
Unit Letter U	Section 11	Township 17	Range 27	County Ready				
Actual Footage Location of Well: 330 feet from the West line and 330 feet from the South line								
Ground Level Elev. 3515'	Producing Formation even Fivers			Pool Empire			Dedicated Acreage: 11-17-27 Acres	

1. Is the Operator the only owner in the dedicated acreage outlined on the plat below? YES ☒ NO ☐ ("Owner" means the person who has the right to drill into and to produce from any pool and to appropriate the production either for himself or for himself and another. (65-3-29 (e) NMSA 1935 Comp.)
2. If the answer to question one is "no," have the interests of all the owners been consolidated by communitization agreement or otherwise? YES ☐ NO ☐ . If answer is "yes," Type of Consolidation **Record Owner**
3. If the answer to question two is "no," list all the owners and their respective interests below:

Owner	Land Description

RECEIVED
APR 14 1959
GEOLOGICAL SURVEY
ARTESIA, NEW MEXICO

SECTION B

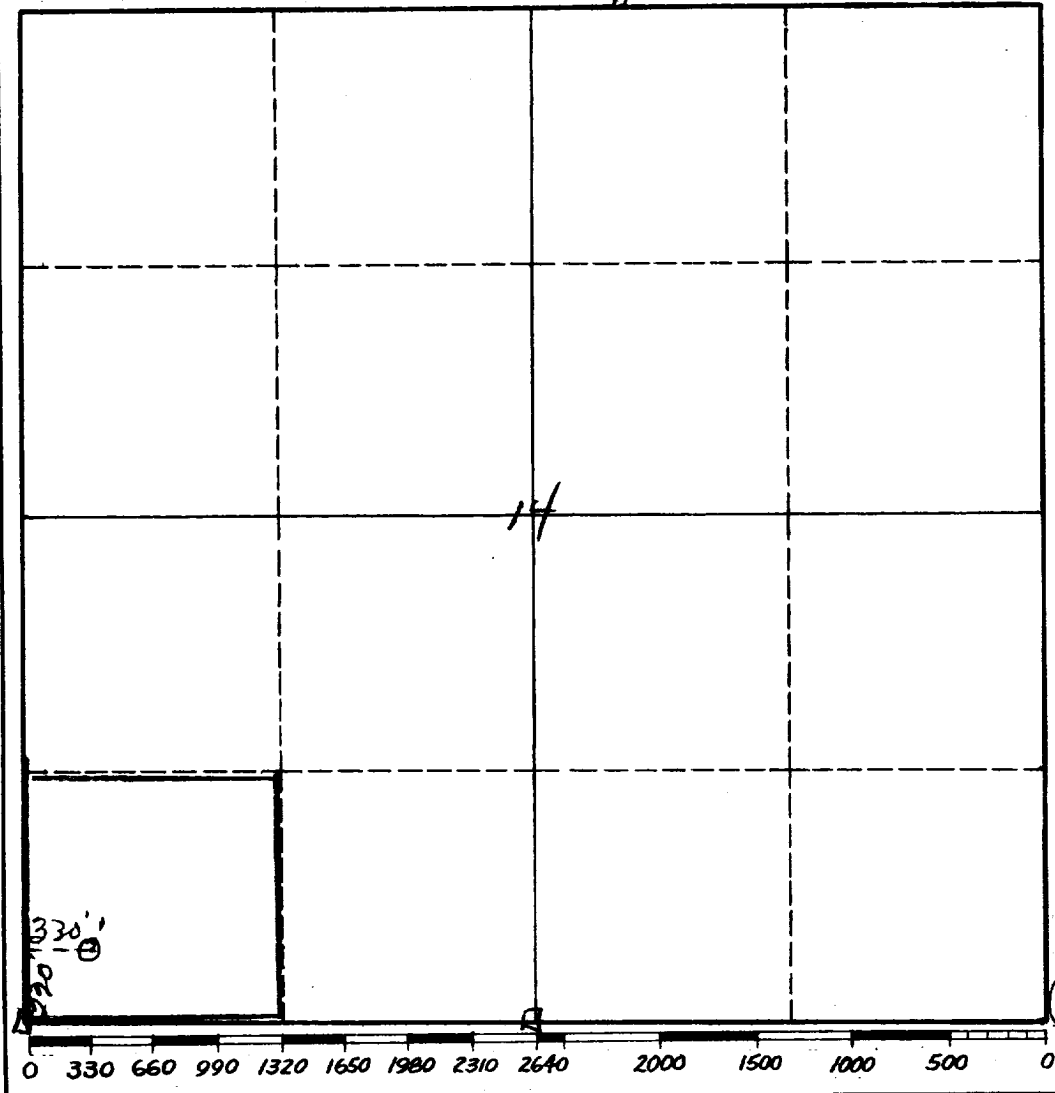

CERTIFICATION

I hereby certify that the information in SECTION A above is true and complete to the best of my knowledge and belief.

Name Bob Johnson
Position Operator
Company Bob Johnson
Date April 11, 1959

I hereby certify that the well location shown on the plat in SECTION B was plotted from field notes of actual surveys made by me or under my supervision, and that the same is true and correct to the best of my knowledge and belief.

Date Surveyed April 11, 1959
Registered Professional Engineer and/or Land Surveyor James H. Brown
Certificate No. 542

TMS

INSTRUCTIONS FOR COMPLETION OF FORM C-128

1. Operator shall furnish and certify to the information called for in Section A.
2. Operator shall outline the dedicated acreage for *both* oil and gas wells on the plat in Section B.
3. A registered professional engineer or land surveyor registered in the State of New Mexico or approved by the Commission shall show on the plat the location of the well and certify this information in the space provided.
4. All distances shown on the plat must be from the outer boundaries of the Section.
5. If additional space is needed for listing owners and their respective interests as required in question 3 of Section A, please use space below.