

Form 9-331a
(Feb. 1951)Land Office New MexicoLease No. 045254Unit Lease

(SUBMIT IN TRIPLICATE)

UNITED STATES

DEPARTMENT OF THE INTERIOR

GEOLOGICAL SURVEY

RECEIVED

30-215-00571

SEP 29 1960

SUNDRY NOTICES AND REPORTS ON WELLS

D. C. C.

ARTESIA, OFFICE

NOTICE OF INTENTION TO DRILL.....	<input checked="" type="checkbox"/>	SUBSEQUENT REPORT OF WATER SHUT-OFF.....	
NOTICE OF INTENTION TO CHANGE PLANS.....		SUBSEQUENT REPORT OF SHOOTING OR ACIDIZING.....	
NOTICE OF INTENTION TO TEST WATER SHUT-OFF.....		SUBSEQUENT REPORT OF ALTERING CASING.....	
NOTICE OF INTENTION TO RE-DRILL OR REPAIR WELL.....		SUBSEQUENT REPORT OF RE-DRILLING OR REPAIR.....	
NOTICE OF INTENTION TO SHOOT OR ACIDIZE.....		SUBSEQUENT REPORT OF ABANDONMENT.....	
NOTICE OF INTENTION TO PULL OR ALTER CASING.....		SUPPLEMENTARY WELL HISTORY.....	
NOTICE OF INTENTION TO ABANDON WELL.....			

(INDICATE ABOVE BY CHECK MARK NATURE OF REPORT, NOTICE, OR OTHER DATA)

E. S. Hitchcock 27

September 23, 1960

Well No. 1 is located 1980 ft. from N line and 1980 ft. from W line of sec. 27SE 1/4 NW 1/4 Sec. 27
(1/4 Sec. and Sec. No.)16S
(Twp.)27E
(Range)NMPM
(Meridian)Dog Canyon CD
(Field)Eddy
(County or Subdivision)New Mexico
(State or Territory)

RECEIVED

SEP 27 1960

The elevation of the derrick floor above sea level is _____ ft.

U. S. GEOLOGICAL SURVEY
ARTESIA, NEW MEXICO

DETAILS OF WORK

(State names of and expected depths to objective sands; show sizes, weights, and lengths of proposed casings; indicate mudding jobs, cementing points, and all other important proposed work)

It is our intention to drill a well with rotary tools at the above location to a total depth of approximately 1400'. All casing points will be cemented in accordance with approved methods of the U. S. Geological Survey and any other special requirements will be complied with.

It is planned to use the following casing pattern: 8 3/4" hole to be drilled, 7" casing to be set at approximately 150' and cemented with 100 sacks, cement to be circulated; 6 3/4" hole to be drilled, 4 1/2" casing to be set at approximately 1400' and cemented with 250 sacks, cement to be circulated.

Approval to produce this well upon completion is also requested.

I understand that this plan of work must receive approval in writing by the Geological Survey before operations may be commenced.

Company Continental Oil CompanyAddress Rowley Bldg.Artesia, New Mexico

USGS-6 HLJ WAM File

By _____

Title District Superintendent

NEW MEXICO OIL CONSERVATION COMMISSION
WELL LOCATION AND ACREAGE DEDICATION PLAT

FORM C-128
Revised 5/1/57

SEE INSTRUCTIONS FOR COMPLETING THIS FORM ON THE REVERSE SIDE

SECTION A

Operator Continental Oil Company		Lease Hitchcock 27		Well No. 1
Unit Letter F	Section 27	Township 16 South	Range 27 East	County Madison
Actual Footage Location of Well: 1900 feet from the North line and 1980 feet from the West line				
Ground Level Elev. 3451	Producing Formation Premier		Pool Big Canyon	Dedicated Acreage: 40 Acres

1. Is the Operator the only owner in the dedicated acreage outlined on the plat below? YES ☒ NO ____ . ("Owner" means the person who has the right to drill into and to produce from any pool and to appropriate the production either for himself or for himself and another. (65-3-29 (e) NMSA 1935 Comp.)
2. If the answer to question one is "no," have the interests of all the owners been consolidated by communitization agreement or otherwise? YES ____ NO ____ . If answer is "yes," Type of Consolidation **RECEIVED**
3. If the answer to question two is "no," list all the owners and their respective interests below:

Owner	Land Description
	SEP 27 1960 U. S. GEOLOGICAL SURVEY ARTESIA, NEW MEXICO

SECTION B

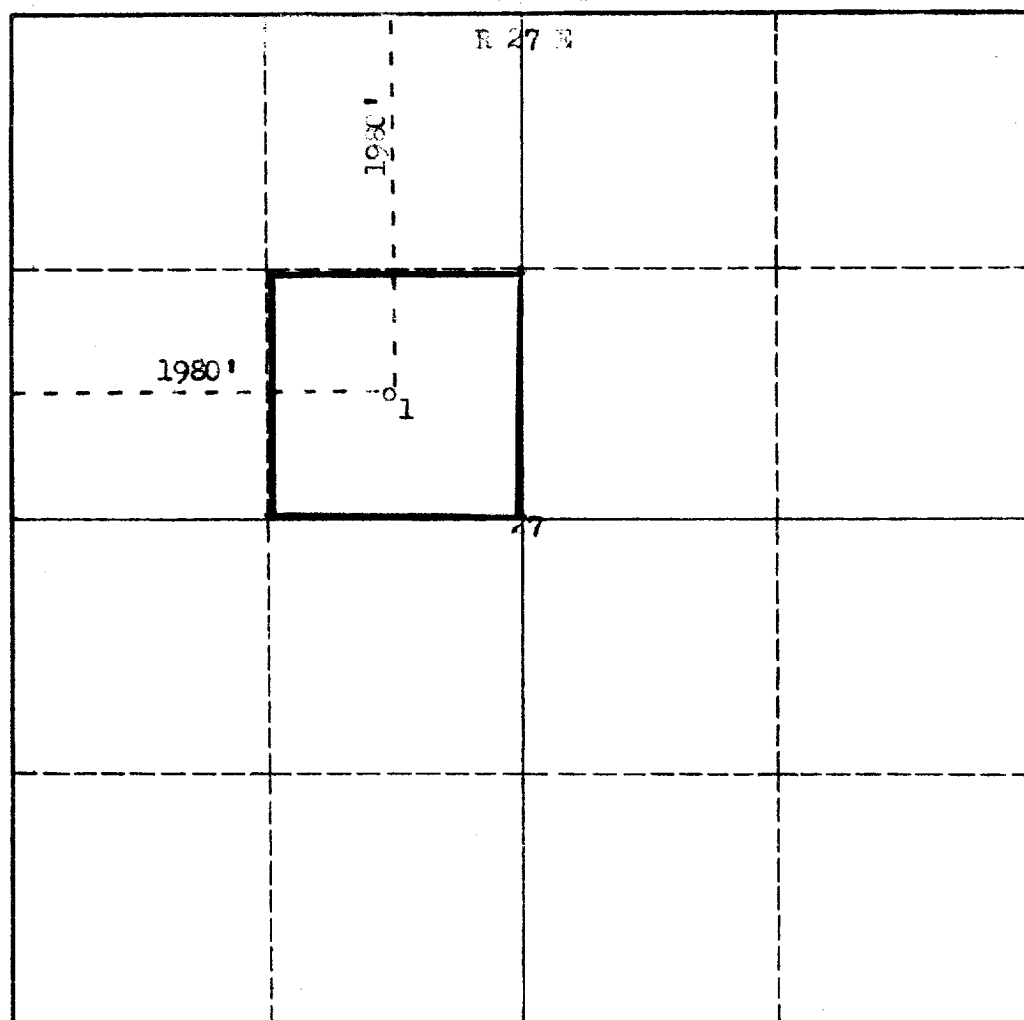

CERTIFICATION

I hereby certify that the information in SECTION A above is true and complete to the best of my knowledge and belief.

Name	O. H. Hesser
Position	District Superintendent
Company	Continental Oil Company
Date	9-26-60

I hereby certify that the well location shown on the plat in SECTION B was plotted from field notes of actual surveys made by me or under my supervision, and that the same is true and correct to the best of my knowledge and belief.

Date Surveyed	Sept. 23, 1960
Registered Professional Engineer and/or Land Surveyor	James A. Brown
Certificate No.	N.M.L.S. No. 542

0 330 660 990 1320 1650 1980 2310 2640 2000 1500 1000 500 0

INSTRUCTIONS FOR COMPLETION OF FORM C-128

1. Operator shall furnish and certify to the information called for in Section A.
2. Operator shall outline the dedicated acreage for *both* oil and gas wells on the plat in Section B.
3. A registered professional engineer or land surveyor registered in the State of New Mexico or approved by the Commission shall show on the plat the location of the well and certify this information in the space provided.
4. All distances shown on the plat must be from the outer boundaries of the Section.
5. If additional space is needed for listing owners and their respective interests as required in question 3 of Section A, please use space below.