

ILLEGIBLE

and Office Santa Fe, N.M.

Case No. LC 062623-8

U. S. GEOLOGICAL SURVEY  
RECEIVED

SUBJECT TO LIKE APPROVAL BY STATE ENGINEER.  
NEER, P. O. BOX 810, ROSWELL, NEW MEXICO

# SUNDRY NOTICES AND REPORTS ON WELLS

MAY 10 1960  
30-015-00575  
ARTESIA, NEW MEXICO

NOTICE OF INTENTION TO DRILL.....	<input checked="" type="checkbox"/>	SUBSEQUENT REPORT OF WATER SHUT-OFF.....	
NOTICE OF INTENTION TO CHANGE PLANS.....		SUBSEQUENT REPORT OF SHOOTING OR ACIDIZING.....	
NOTICE OF INTENTION TO TEST WATER SHUT-OFF.....		SUBSEQUENT REPORT OF ALTERING CASING.....	
NOTICE OF INTENTION TO RE-DRILL OR REPAIR WELL.....		SUBSEQUENT REPORT OF RE-DRILLING OR REPAIR.....	
NOTICE OF INTENTION TO SHOOT OR ACIDIZE.....		SUBSEQUENT REPORT OF ABANDONMENT.....	
NOTICE OF INTENTION TO PULL OR ALTER CASING.....		SUPPLEMENTARY WELL HISTORY.....	
NOTICE OF INTENTION TO ABANDON WELL.....			

(INDICATE ABOVE BY CHECK MARK NATURE OF REPORT, NOTICE, OR OTHER DATA)

3 Hanson Federal May 9, 1960  
Well No. \_\_\_\_\_ is located 1940 ft. from [N] line and 1940 ft. from [E] line of sec. 27  
C. NELSON  
XXXXXX 27 16-1 27-E N.M.P.M. **RECEIVED**  
(1/4 Sec. and Sec. No.) (Twp.) (Range) (Meridian)  
Indes. Edley Edley New Mexico  
(Field) (County or Subdivision) (State or Territory)

The elevation of the derrick floor above sea level is 3445 ft. Ground **U. S. GEOLOGICAL SURVEY**  
**ARTESIA, NEW MEXICO**

## DETAILS OF WORK

(State names of and expected depths to objective sands; show sizes, weights, and lengths of proposed casings; indicate mudding jobs, cementing points, and all other important proposed work)

It is proposed to drill a Premier sand test to an approximate depth of 1500' with the following casing program:

7" 120' w/circ. lined  
4-1/2" 1500' w/circ. lined

APPROVAL IS SUBJECT TO STATE ENGINEERS REGULATIONS REQUIRED ON "APPLICATION FOR PERMIT TO DRILL FOR OIL" IN WATER BASIN. BOX 810, ROSWELL, NEW MEXICO

New Mexico Engineers Office has been notified and verbal approval granted.

I understand that this plan of work must receive approval in writing by the Geological Survey before operations may be commenced.

Company Wayne J. Spears

Address 201 Three Cross Drive

Roswell, New Mexico

By Wayne J. Spears  
Title Owner

NEW MEXICO OIL CONSERVATION COMMISSION  
WELL LOCATION AND ACREAGE DEDICATION PLAT

FORM C-128  
Revised 5/1/57

SEE INSTRUCTIONS FOR COMPLETING THIS FORM ON THE REVERSE SIDE

SECTION A

Operator <b>Wayne J. Spears</b>		Lease <b>Hanson-Federal</b>		Well No. <b>3-A</b>	
Unit Letter	Section <b>27</b>	Township <b>16 South</b>	Range <b>27 East</b>	County <b>Eddy</b>	
Actual Footage Location of Well: <b>660 1980</b> feet from the <b>South</b> line and <b>1980</b> feet from the <b>West</b> line					
Ground Level Elev. <b>3445</b>	Producing Formation		Pool		Dedicated Acreage: Acres

1. Is the Operator the only owner in the dedicated acreage outlined on the plat below? YES \_\_\_\_\_ NO \_\_\_\_\_. ("Owner" means the person who has the right to drill into and to produce from any pool and to appropriate the production either for himself or for himself and another. (65-3-29 (e) NMSA 1935 Comp.)
2. If the answer to question one is "no," have the interests of all the owners been consolidated by communitization agreement or otherwise? YES \_\_\_\_\_ NO \_\_\_\_\_. If answer is "yes," Type of Consolidation \_\_\_\_\_
3. If the answer to question two is "no," list all the owners and their respective interests below:

RECEIVED

Owner	Land Description
	<b>MAY 10 1960</b> <b>U. S. GEOLOGICAL SURVEY</b> <b>ARTESIA, NEW MEXICO</b>

SECTION B

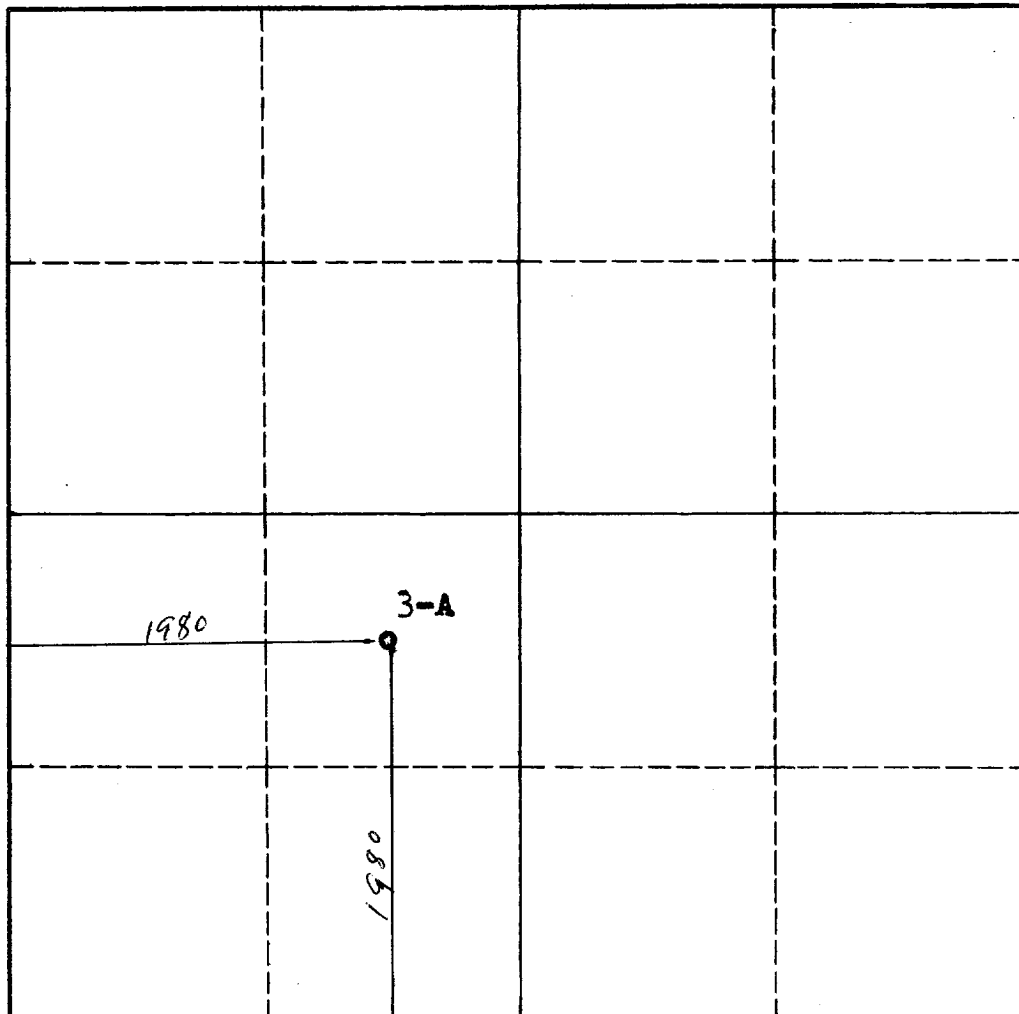

CERTIFICATION

I hereby certify that the information in SECTION A above is true and complete to the best of my knowledge and belief.

Name <b>Wayne J. Spears</b>
Position <b>Operator</b>
Company
Date <b>5-10-60</b>

I hereby certify that the well location shown on the plat in SECTION B was plotted from field notes of actual surveys made by me or under my supervision, and that the same is true and correct to the best of my knowledge and belief.

Date Surveyed <b>May 6, 1960</b>
Registered Professional Engineer and/or Land Surveyor <b>John A. Mathis Jr.</b>
Certificate No. <b>1502</b>

0 330 660 990 1320 1650 1980 2310 2640 2000 1500 1000 500 0

## INSTRUCTIONS FOR COMPLETION OF FORM C-128

1. Operator shall furnish and certify to the information called for in Section A.
2. Operator shall outline the dedicated acreage for *both* oil and gas wells on the plat in Section B.
3. A registered professional engineer or land surveyor registered in the State of New Mexico or approved by the Commission shall show on the plat the location of the well and certify this information in the space provided.
4. All distances shown on the plat must be from the outer boundaries of the Section.
5. If additional space is needed for listing owners and their respective interests as required in question 3 of Section A, please use space below.