

(SUBMIT IN TRIPLICATE)

Land Office Santa Fe, N.M.

Lease No. LC 062623-B

Unit **RECEIVED**



UNITED STATES
DEPARTMENT OF THE INTERIOR
GEOLOGICAL SURVEY

JUN 20 1960
30-015-00527
D. C. C.
ARTESIA, OFFICE

SUBJECT TO LIKE APPROVAL BY STATE ENGINEER
NEER, P. O. BOX 810, ROSWELL, NEW MEXICO

SUNDRY NOTICES AND REPORTS ON WELLS

NOTICE OF INTENTION TO DRILL	<input checked="" type="checkbox"/>	SUBSEQUENT REPORT OF WATER SHUT-OFF	
NOTICE OF INTENTION TO CHANGE PLANS		SUBSEQUENT REPORT OF SHOOTING OR ACIDIZING	
NOTICE OF INTENTION TO TEST WATER SHUT-OFF		SUBSEQUENT REPORT OF ALTERING CASING	
NOTICE OF INTENTION TO RE-DRILL OR REPAIR WELL		SUBSEQUENT REPORT OF RE-DRILLING OR REPAIR	
NOTICE OF INTENTION TO SHOOT OR ACIDIZE		SUBSEQUENT REPORT OF ABANDONMENT	
NOTICE OF INTENTION TO PULL OR ALTER CASING		SUPPLEMENTARY WELL HISTORY	
NOTICE OF INTENTION TO ABANDON WELL			

(INDICATE ABOVE BY CHECK MARK NATURE OF REPORT, NOTICE, OR OTHER DATA)

June 15, 1960

4 Hanson Federal "A"
Well No. _____ is located 990 ft. from ☒ line and 1650 ft. from ☒ line of sec. 27

NW 1/4 Sec. 27, T. 16 S., R. 27 E. N.M.P.M.
(1/4 Sec. and Sec. No.) (Twp.) (Range) (Meridian)

~~Dog Canyon~~ Eddy New Mexico
(Field) (County or Subdivision) (State or Territory)

The elevation of the derrick floor above sea level is 3428 ft.

DETAILS OF WORK

(State names of and expected depths to objective sands; show sizes, weights, and lengths of proposed casings; indicate mudding jobs, cementing points, and all other important proposed work)

It is proposed to drill a 1400' Permian sand rotary test with the following casing program;

7" @ 150' w/circ.
4 1/2" @ 1400' w/circ.

RECEIVED

JUN 15 1960

U. S. GEOLOGICAL SURVEY
ARTESIA, NEW MEXICO

APPROVAL IS SUBJECT TO STATE
ENGINEERS REGULATIONS REQUIRED
ON "APPLICATION FOR PERMIT TO
DRILL FOR OIL" IN WATER BASIN.
BOX 810, ROSWELL, NEW MEXICO

I understand that this plan of work must receive approval in writing by the Geological Survey before operations may be commenced.

Company Wayne J. Spears

Address 201 Three Cross Drive

Roswell, New Mexico

By Wayne J. Spears
Title Operator

NEW MEXICO OIL CONSERVATION COMMISSION
WELL LOCATION AND ACREAGE DEDICATION PLAT

FORM C-128
Revised 5/1/57

SEE INSTRUCTIONS FOR COMPLETING THIS FORM ON THE REVERSE SIDE

SECTION A

Operator Wayne J. Spears		Lease Hanson Federal "A"		Well No. 4-A
Unit Letter	Section 27	Township 16 South	Range 27 East	County Eddy
Actual Footage Location of Well: 990 feet from the South line and 1650 feet from the West line				
Ground Level Elev. 3428	Producing Formation Grayburg		Pool Dog Canyon	Dedicated Acreage: 40 Acres

1. Is the Operator the only owner in the dedicated acreage outlined on the plat below? YES _____ NO X. ("Owner" means the person who has the right to drill into and to produce from any pool and to appropriate the production either for himself or for himself and another. (65-3-29 (e) NMSA 1935 Comp.)
2. If the answer to question one is "no," have the interests of all the owners been consolidated by communitization agreement or otherwise? YES X NO _____. If answer is "yes," Type of Consolidation Farmout
3. If the answer to question two is "no," list all the owners and their respective interests below:

Owner	Land Description
	JUN 15 1960 U. S. GEOLOGICAL SURVEY ARTESIA, NEW MEXICO

SECTION B

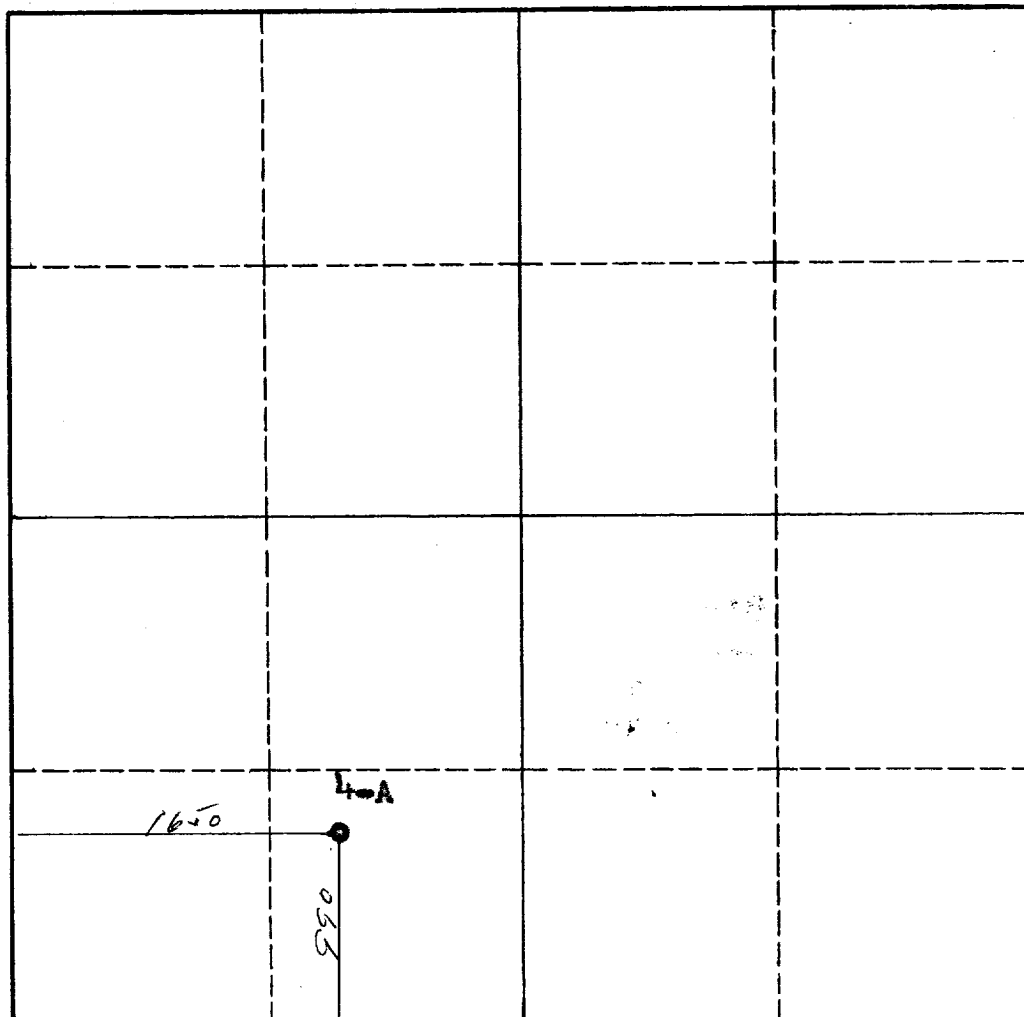

CERTIFICATION

I hereby certify that the information in SECTION A above is true and complete to the best of my knowledge and belief.

Name

Position

Company

Date

Operator

Wayne J. Spears

June 15, 1960

I hereby certify that the well location shown on the plat in SECTION B was plotted from field notes of actual surveys made by me or under my supervision, and that the same is true and correct to the best of my knowledge and belief.

Date Surveyed

Registered Professional Engineer and/or Land Surveyor

Certificate No.

June 9, 1960

John A. Mathis Jr.

1502

INSTRUCTIONS FOR COMPLETION OF FORM C-128

1. Operator shall furnish and certify to the information called for in Section A.
2. Operator shall outline the dedicated acreage for *both* oil and gas wells on the plat in Section B.
3. A registered professional engineer or land surveyor registered in the State of New Mexico or approved by the Commission shall show on the plat the location of the well and certify this information in the space provided.
4. All distances shown on the plat must be from the outer boundaries of the Section.
5. If additional space is needed for listing owners and their respective interests as required in question 3 of Section A, please use space below.