

(SUBMIT IN TRIPLICATE)

UNITED STATES  
DEPARTMENT OF THE INTERIOR  
GEOLOGICAL SURVEY

Land Office .....

Lease No. NM 028

Unit .....

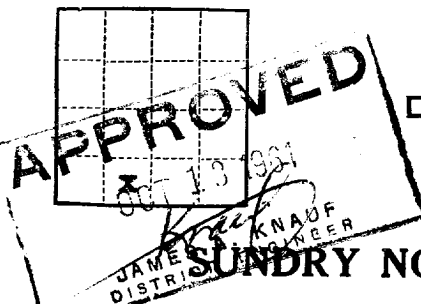
RECEIVED  
30-015-01254  
OCT 11 1961

## SUNDRY NOTICES AND REPORTS ON WELLS

NOTICE OF INTENTION TO DRILL.....	<input checked="" type="checkbox"/>	SUBSEQUENT REPORT OF WATER SHUT-OFF.....	
NOTICE OF INTENTION TO CHANGE PLANS.....		SUBSEQUENT REPORT OF SHOOTING OR ACIDIZING.....	
NOTICE OF INTENTION TO TEST WATER SHUT-OFF.....		SUBSEQUENT REPORT OF ALTERING CASING.....	
NOTICE OF INTENTION TO RE-DRILL OR REPAIR WELL.....		SUBSEQUENT REPORT OF RE-DRILLING OR REPAIR.....	
NOTICE OF INTENTION TO SHOOT OR ACIDIZE.....		SUBSEQUENT REPORT OF ABANDONMENT.....	
NOTICE OF INTENTION TO PULL OR ALTER CASING.....		SUPPLEMENTARY WELL HISTORY.....	
NOTICE OF INTENTION TO ABANDON WELL.....			

(INDICATE ABOVE BY CHECK MARK NATURE OF REPORT, NOTICE, OR OTHER DATA)

Artesia, New Mexico October 10, 1961

Humble 19"

Well No. 1 is located 660 ft. from ~~XXX~~ [S] line and 1980 ft. from ~~XXX~~ [W] line of sec. 9SESW Sec. 9 16S 28E N.M.P.M.  
(1/4 Sec. and Sec. No.) (Twp.) (Range) (Meridian)Wildcat Eddy New Mexico  
(Field) (County or Subdivision) (State or Territory)

Ground level

The elevation of the ~~XXXXXX~~ above sea level is 3376 ft.

OCT 10 1961

## DETAILS OF WORK

(State names of and expected depths to objective sands; show sizes, weights, and lengths of proposed casings; indicate mudding jobs, cementing points, and all other important proposed work)

U. S. GEOLOGICAL SURVEY  
ARTESIA, NEW MEXICO

We propose to drill a wildcat well at the above location to test the San Andres formation to a depth of approximately 1900 feet.

We expect to possibly need to run casing to shut off water as follows:

10 3/4" at approximately 125 feet

8 5/8" at approximately 450 feet

7" at approximately 1250 feet

If oil or gas in commercial quantities is encountered we will pull the 10" and 7" and cement the 8 5/8" with a squeeze job to your satisfaction, run a production string of either 4 1/2" or 5 1/2" and cement with 100 sacks or enough to cement above the red sand.

Understand that this plan of work must receive approval in writing by the Geological Survey before operations may be commenced.

Company Kincaid &amp; Watson Drilling Company

Address P.O. Box 498

Artesia, New Mexico

By

Title Assistant Secretary

NUMBER OF COPIES RECEIVED	
DISTRIBUTION	
SANTA FE	
FILE	
U.S.G.S.	
LAND OFFICE	
TRANSPORTER	OIL GAS
PRORATION OFFICE	
OPERATOR	

**NEW MEXICO OIL CONSERVATION COMMISSION**  
**WELL LOCATION AND ACREAGE DEDICATION PLAT**  
 SEE INSTRUCTIONS FOR COMPLETING THIS FORM ON THE REVERSE SIDE

FORM C-128  
 Revised 5/1/57

**SECTION A**

Operator <b>Kineaid &amp; Watson Drilling Co.</b>		Lease <b>Humble 9</b>		Well No. <b>1</b>
Unit Letter <b>N</b>	Section <b>9</b>	Township <b>16 South</b>	Range <b>28 East</b>	County <b>Eddy</b>
Actual Footage Location of Well: <b>660</b> feet from the <b>South</b> line and <b>1980</b> feet from the <b>West</b> line				
Ground Level Elev. <b>3376</b>	Producing Formation <b>San Andrea</b>	Pool <b>Wildcat</b>	Dedicated Acreage: <b>40</b> Acres	

- Is the Operator the only owner in the dedicated acreage outlined on the plat below? YES ☒ NO \_\_\_\_ . ("Owner" means the person who has the right to drill into and to produce from any pool and to appropriate the production either for himself or for himself and another. (65-3-29 (e) NMSA 1935 Comp.)
- If the answer to question one is "no," have the interests of all the owners been consolidated by communitization agreement or otherwise? YES \_\_\_\_ NO \_\_\_\_ . If answer is "yes," Type of Consolidation \_\_\_\_\_
- If the answer to question two is "no," list all the owners and their respective interests below: \_\_\_\_\_

Owner	Land Description <b>OCT 10 1961</b>
	<b>SURVEY</b>
	<b>NEW MEXICO</b>

**SECTION B**

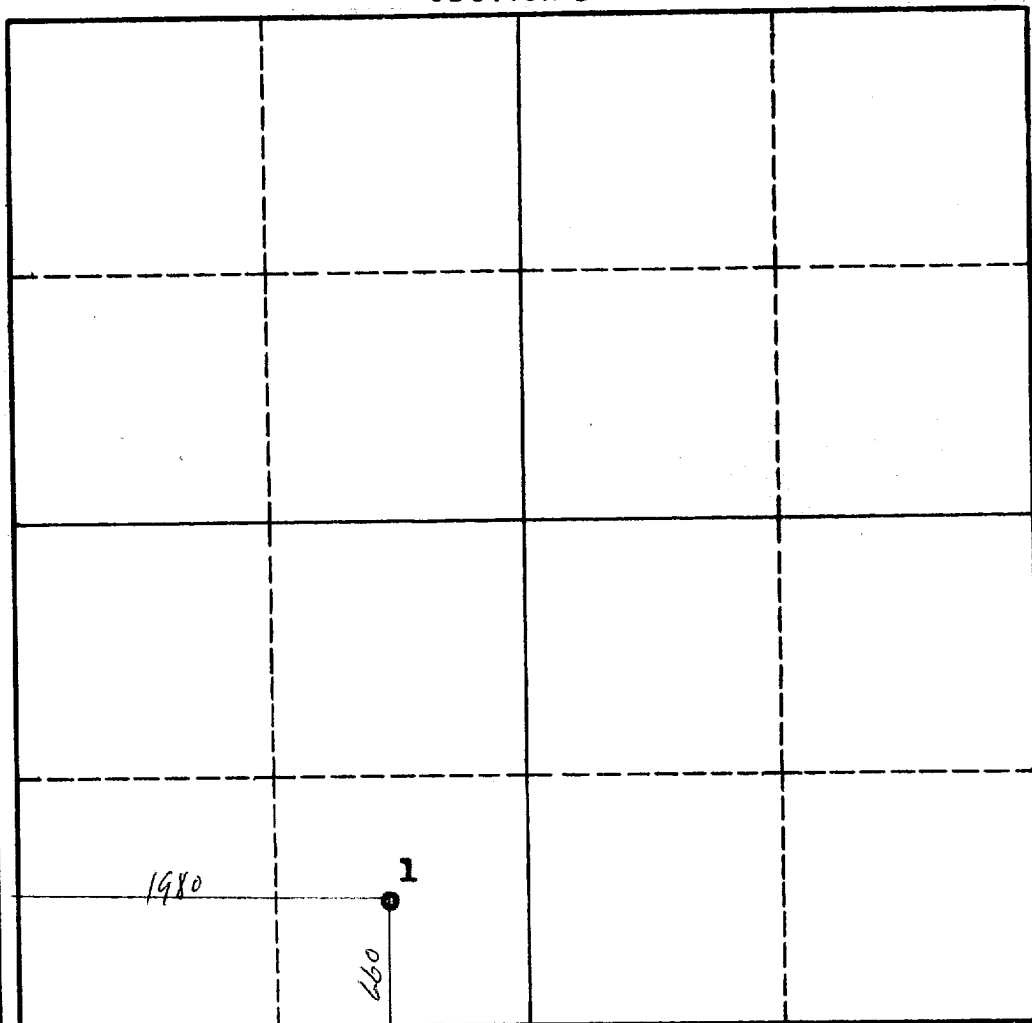

**CERTIFICATION**

I hereby certify that the information in SECTION A above is true and complete to the best of my knowledge and belief.

Name *Greg Holmer*  
 Position **Assistant Secretary**  
 Company **Kineaid & Watson Drlg. Co.**  
 Date **October 10, 1961**

I hereby certify that the well location shown on the plat in SECTION B was plotted from field notes of actual surveys made by me or under my supervision, and that the same is true and correct to the best of my knowledge and belief.

Date Surveyed **Oct., 10, 1961**  
 Registered Professional Engineer and/or Land Surveyor

*John A. Mathis Jr.*  
 Certificate No. **1502**

0 330 660 990 1320 1650 1980 2310 2640 2000 1500 1000 500 0

## INSTRUCTIONS FOR COMPLETION OF FORM C-128

1. Operator shall furnish and certify to the information called for in Section A.
2. Operator shall outline the dedicated acreage for *both* oil and gas wells on the plat in Section B.
3. A registered professional engineer or land surveyor registered in the State of New Mexico or approved by the Commission shall show on the plat the location of the well and certify this information in the space provided.
4. All distances shown on the plat must be from the outer boundaries of the Section.
5. If additional space is needed for listing owners and their respective interests as required in question 3 of Section A, please use space below.