

(SUBMIT IN TRIPLICATE)

UNITED STATES  
DEPARTMENT OF THE INTERIOR  
GEOLOGICAL SURVEY

Land Office Santa Fe

Lease No. NM 01908

Unit RECEIVED  
30-015-01262  
MAR 5 1963

SUNDRY NOTICES AND REPORTS ON WELLS

NOTICE OF INTENTION TO DRILL	<input checked="" type="checkbox"/>	SUBSEQUENT REPORT OF WATER SHUT-OFF	
NOTICE OF INTENTION TO CHANGE PLANS		SUBSEQUENT REPORT OF SHOOTING OR ACIDIZING	
NOTICE OF INTENTION TO TEST WATER SHUT-OFF		SUBSEQUENT REPORT OF ALTERING CASING	
NOTICE OF INTENTION TO RE-DRILL OR REPAIR WELL		SUBSEQUENT REPORT OF RE-DRILLING OR REPAIR	
NOTICE OF INTENTION TO SHOOT OR ACIDIZE		SUBSEQUENT REPORT OF ABANDONMENT	
NOTICE OF INTENTION TO PULL OR ALTER CASING		SUPPLEMENTARY WELL HISTORY	
NOTICE OF INTENTION TO ABANDON WELL			

(INDICATE ABOVE BY CHECK MARK NATURE OF REPORT, NOTICE, OR OTHER DATA)

Barbara Federal  
Well No. 1 is located 2275 ft. from S line and 1620 ft. from E line of sec. 22  
NW/4 (Section) 22 16 South 28 East NM (Range)  
Wildcat (Field) 16 or Subdivision New Mexico (State)

The elevation of the derrick floor above sea level is 3554 ft.

DETAILS OF WORK

(State names of and expected depths to objective sands; show sizes, weights, and lengths of proposed casings; indicate mudding jobs, cementing points, and all other important proposed work)

Propose to re-enter and clean out the existing abandoned hole originally drilled as the W.G. Roeder #1 McWhorter in 1925. Test was drilled on the location described above. Completion attempt will be made at an approximately 3000'. Will run an estimated 230' of 10 3/4" casing and 1230' of 8 5/8" casing. Neither string will be cemented. If production is indicated, 4 1/2" will be set at TD and cemented above the Queen water, and the 10 3/4", and 8 5/8" will be pulled.

Cortez Drilling Co. will be the contractor.

*Old well erroneously shown to be 1620 feet from south line*

I understand that this plan of work must receive approval in writing by the Geological Survey before operation may be commenced.

Company Jack L. McClellan

Address Box 848, Roswell, New Mexico

By

Title

Operator

RECEIVED  
FEB 25 1963  
U. S. GEOLOGICAL SURVEY  
ARTESIA, NEW MEXICO

NUMBER OF COPIES RECEIVED	
DISTRIBUTION	
SANTA FE	
FILE	
U.S.G.S	
LAND OFFICE	
TRANSPORTER	OIL GAS
PRODUCTION OFFICE	
OPERATOR	

**NEW MEXICO OIL CONSERVATION COMMISSION**  
**WELL LOCATION AND ACREAGE DEDICATION PLAT**  
 SEE INSTRUCTIONS FOR COMPLETING THIS FORM ON THE REVERSE SIDE

FORM C-128  
 Revised 5/1/57

**SECTION A**

Operator <b>Jack McClellan</b>		Lease <b>Barbara Federal</b>		Well No. <b>1</b>
Unit Letter <b>J</b>	Section <b>22</b>	Township <b>T-16-S</b>	Range <b>R-28-E</b>	County <b>Eddy</b>
Actual Footage Location of Well: <b>1620</b> feet from the <b>East</b> line and <b>2275</b> feet from the <b>South</b> line				
Ground Level Elev. <b>3665</b>	Producing Formation	Pool	Dedicated Acreage: <b>40</b> Acres	

1. Is the Operator the only owner in the dedicated acreage outlined on the plat below? YES \_\_\_\_\_ NO \_\_\_\_\_. ("Owner" means the person who has the right to drill into and to produce from any pool and to appropriate the production either for himself or for himself and another. (65-3-29 (e) NMSA 1935 Comp.)
2. If the answer to question one is "no," have the interests of all the owners been consolidated by communitization agreement or otherwise? YES \_\_\_\_\_ NO \_\_\_\_\_. If answer is "yes," Type of Consolidation \_\_\_\_\_
3. If the answer to question two is "no," list all the owners and their respective interests below:

Owner	Land Description

**SECTION B**

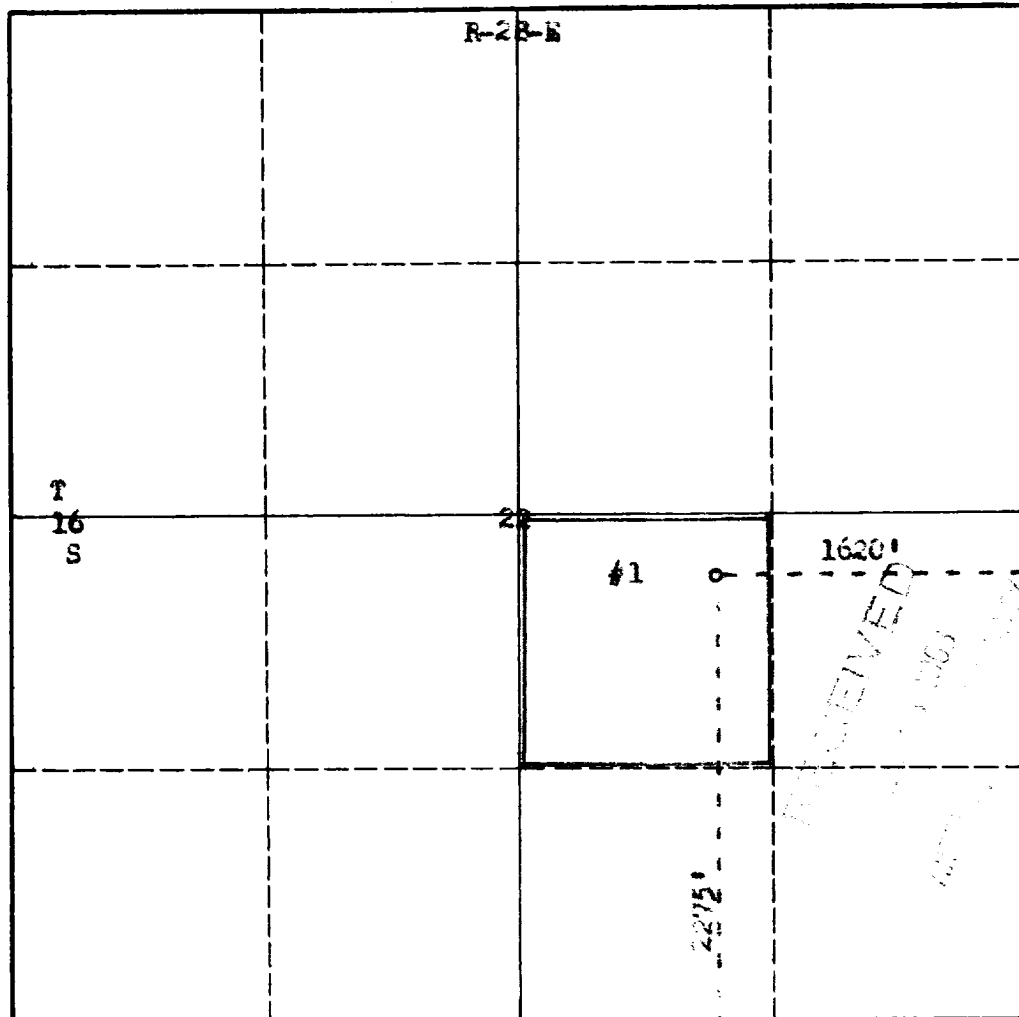

**CERTIFICATION**

I hereby certify that the information in SECTION A above is true and complete to the best of my knowledge and belief.

Name <i>Joe Shewey</i>
Position <i>(Agent)</i>
Company <b>Jack McClellan</b>
Date <b>February 26, 1963</b>

I hereby certify that the well location shown on the plat in SECTION B was plotted from field notes of actual surveys made by me or under my supervision, and that the same is true and correct to the best of my knowledge and belief.

Date Surveyed <b>February 26, 1963</b>
Registered Professional Engineer and/or Land Surveyor <i>James H. Brown</i>
Certificate No. <b>542</b>

## INSTRUCTIONS FOR COMPLETION OF FORM C-128

1. Operator shall furnish and certify to the information called for in Section A.
2. Operator shall outline the dedicated acreage for *both* oil and gas wells on the plat in Section B.
3. A registered professional engineer or land surveyor registered in the State of New Mexico or approved by the Commission shall show on the plat the location of the well and certify this information in the space provided.
4. All distances shown on the plat must be from the outer boundaries of the Section.
5. If additional space is needed for listing owners and their respective interests as required in question 3 of Section A, please use space below.