

COPY TO O. C. C.

Budget Bureau 42-R358.3.  
Approval expires 12-31-55.

(SUBMIT IN TRIPLICATE)

Land Office

Lease No. **KCH3378**  
**LC063578**

Unit

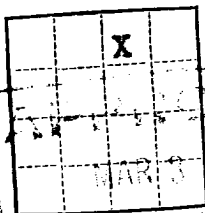
**30-015-01275**UNITED STATES  
DEPARTMENT OF THE INTERIOR  
GEOLOGICAL SURVEYROBERT C. EVANS  
ACTING DISTRICT ENGINEER

## SUNDRY NOTICES AND REPORTS ON WELLS

NOTICE OF INTENTION TO DRILL	<input checked="" type="checkbox"/>	SUBSEQUENT REPORT OF WATER SHUT-OFF	
NOTICE OF INTENTION TO CHANGE PLANS		SUBSEQUENT REPORT OF SHOOTING OR ACIDIZING	
NOTICE OF INTENTION TO TEST WATER SHUT-OFF		SUBSEQUENT REPORT OF ALTERING CASING	
NOTICE OF INTENTION TO RE-DRILL OR REPAIR WELL		SUBSEQUENT REPORT OF RE-DRILLING OR REPAIR	
NOTICE OF INTENTION TO SHOOT OR ACIDIZE		SUBSEQUENT REPORT OF ABANDONMENT	
NOTICE OF INTENTION TO PULL OR ALTER CASING		SUPPLEMENTARY WELL HISTORY	
NOTICE OF INTENTION TO ABANDON WELL			

(INDICATE ABOVE BY CHECK MARK NATURE OF REPORT, NOTICE, OR OTHER DATA)

Artesia, New Mexico March 3, 1959

So. Union Federal

Well No. 5 is located 660 ft. from [N] line and 1980 ft. from [E] line of sec. 34NWNE 34  
(1/4 Sec. and Sec. No.)16S  
(Twp.)28E  
(Range)N.M.P.M.  
(Meridian)

MAR 3 1959

Wildcat  
(Field)Edgy  
(County or Subdivision)New Mexico  
(State or Territory)

ARTESIA, NEW MEXICO

The elevation of the derrick floor above sea level is \_\_\_\_\_ ft.

## DETAILS OF WORK

(State names of and expected depths to objective sands; show sizes, weights, and lengths of proposed casings; indicate mudding jobs, cementing points, and all other important proposed work)

We propose to drill a well to test the Grayburg-San Andres formation to a depth not to exceed 2,000 feet.

We propose the following casing program:

10 3/4" casing at approx. 135 feet to shut off surface water  
8 5/8" casing at approx. 400 feet and cement with 50 sacks.  
7" through red sand if needed, to be pulled  
5 1/2" Oil String to be cemented with 100 sacks.

I understand that this plan of work must receive approval in writing by the Geological Survey before operations may be commenced.

Company Kincaid & WatsonAddress Box 536Artesia, New Mexico

By

Rex Holmer

Title

Agent

NEW MEXICO OIL CONSERVATION COMMISSION  
Well Location and Acreage Dedication Plat

Section A.

Date January 21, 1959

Operator Kincaid & Watson Lease Southern Union Federal  
Well No. 5 Unit Letter B Section 34 Township 16 South Range 28 East NMPM  
Located 660 Feet From North Line, 1980 Feet From East Line  
County Albany G. L. Elevation \_\_\_\_\_ Dedicated Acreage 60 Acres  
Name of Producing Formation Grayburg-San Andres Pool Wildcat

1. Is the Operator the only owner\* in the dedicated acreage outlined on the plat below?  
Yes Yes No \_\_\_\_\_.
2. If the answer to question one is "no," have the interests of all the owners been consolidated by communitization agreement or otherwise? Yes \_\_\_\_\_ No \_\_\_\_\_. If answer is "yes," Type of Consolidation \_\_\_\_\_
3. If the answer to question two is "no," list all the owners and their respective interests below:

Owner

Land Description

**RECEIVED**  
MAR 3 1959

REGIONAL SURVEY  
ARTESIA, NEW MEXICO

Section B

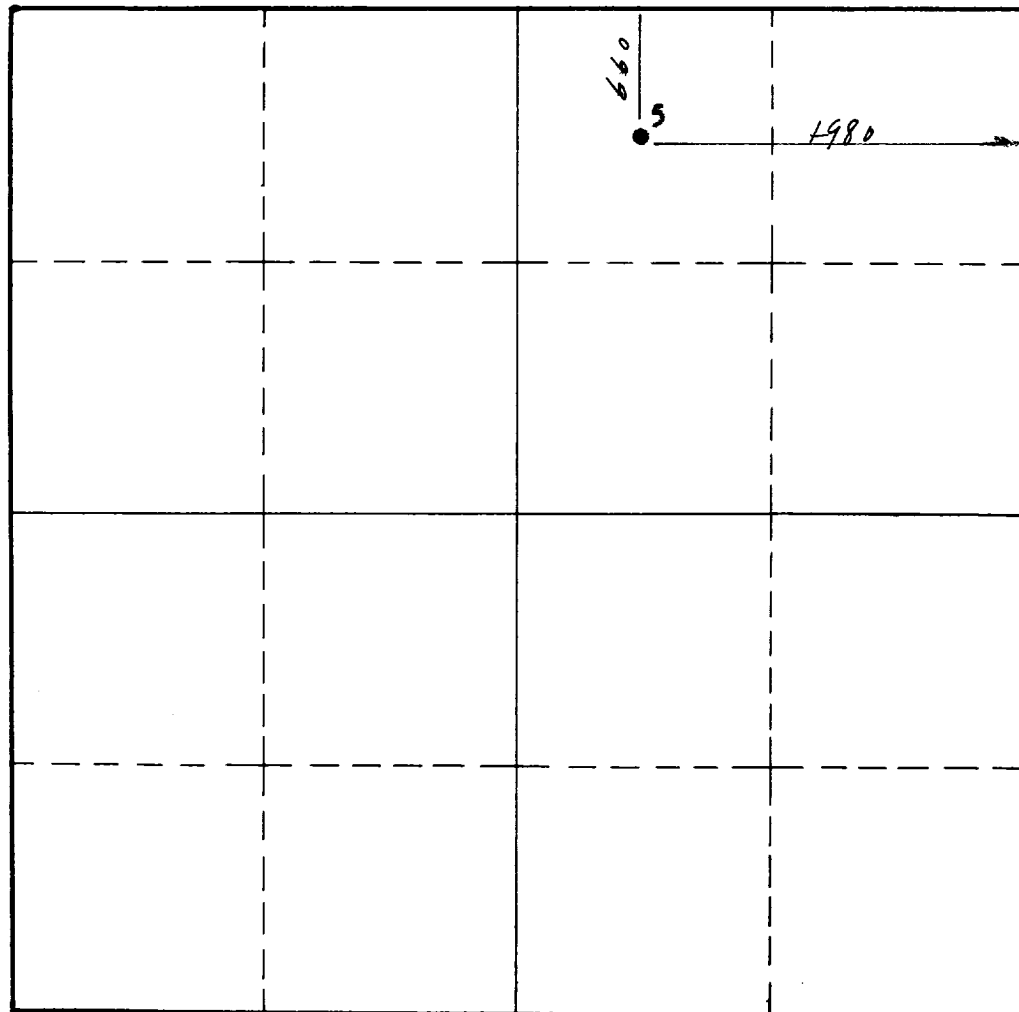

This is to certify that the information in Section A above is true and complete to the best of my knowledge and belief.

Kincaid & Watson  
(Operator)  
John A. Martin Agent  
(Representative)

Box 536, Artesia, New Mex.  
Address

This is to certify that the well location shown on the plat in Section B was plotted from field notes of actual surveys made by me or under my supervision and that the same is true and correct to the best of my knowledge and belief.

Date Surveyed Jan. 21, 1959

John A. Martin  
Registered Professional  
Engineer and/or Land Surveyor.

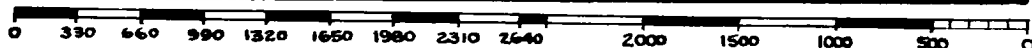

(See instructions for completing this form on the reverse side)

Certificate No. 1502

## INSTRUCTIONS FOR COMPLETION

1. Operator shall furnish and certify to the information called for in Section A.
2. Operator shall outline the dedicated acreage for both oil and gas wells on the plat in Section B.
3. A registered professional engineer or land surveyor registered in the State of New Mexico or approved by the Commission shall show on the plat the location of the well and certify this information in the space provided.
4. All distances shown on the plat must be from the outer boundaries of Section.
5. If additional space is needed for listing owners and their respective interests as required in question 3, Section A, please use space below

\* "Owner" means the person who has the right to drill into and to produce from any pool and to appropriate the production either for himself or for himself and another. (65-3-29 (e) NMSA 1953 Comp.)