

NOTICE OF INTENTION TO DRILL

Notice must be given to the District Office of the Oil Conservation Commission and approval obtained before drilling or recompletion begins. If changes in the proposed plan are considered advisable, a copy of this notice showing such changes will be returned to the sender. Submit this notice in QUINTUPLICATE. One copy will be returned following approval. See additional instructions in Rules and Regulations of the Commission. If State Land submit 6 Copies Attach Form C-128 in triplicate to first 3 copies of form C-101

(Place)

(Date)

OIL CONSERVATION COMMISSION
SANTA FE, NEW MEXICO

Gentlemen:

You are hereby notified that it is our intention to commence the Drilling of a well to be known as
John B. Castle & H. Brace Wiggell

(Company or Operator)

Superior State

(Lease)

Well No. **1**

(Unit)

The well is

located **1980** feet from the **North** line and **1980** feet from the

East

line of Section **11**, T. **-17-S**, R. **-28-E**, NMPM.

(GIVE LOCATION FROM SECTION LINE)

Wildcat Red fork

Eddy

County

If State Land the Oil and Gas Lease is No. **E-7254**

If patented land the owner is

Address

We propose to drill well with drilling equipment as follows: **Cable tools to 300', rotary drilling to 2500'.**

The status of plugging bond is **applied for and will be submitted for approval.**

Drilling Contractor **Technical Drilling Service, Inc.**

We intend to complete this well in the **Grayburg**

formation at an approximate depth of **2200** feet.

CASING PROGRAM

We propose to use the following strings of Casing and to cement them as indicated:

Size of Hole	Size of Casing	Weight per Foot	New or Second Hand	Depth	Sacks Cement
10"	8-5/8"	24#	2nd	300'	50
6-1/4"	4-1/2"	9-1/2#	New	2200'	100

If changes in the above plans become advisable we will notify you immediately.

ADDITIONAL INFORMATION (If recompletion give full details of proposed plan of work.)

Approved **DEC 2 1956**, 19.....
Except as follows:

OIL CONSERVATION COMMISSION

By **ML Armstrong**

Sincerely yours,

H. Brace
John B. CASTLE & WIGZELL

(Company or Operator)

By

Position **Partner**

Send Communications regarding well to

Name **Castle & Wiggell**

Address **Box 868, Midland, Texas**

NEW MEXICO OIL CONSERVATION COMMISSION
Well Location and Acreage Dedication Plat

Section A.

Date 12 - 2 - 58

Operator CASTLE & WIGZELL John B. Castle & H. Brace Wigzell
Lease Superior - State
Well No. 1 Unit Letter G Section 11 Township 17 S Range 28 E NMPM
Located 1980 Feet From North Line, 1980 Feet From East Line
County Eddy G. L. Elevation 3613 Dedicated Acreage 40 Acres
Name of Producing Formation Grayburg Pool Wildcat

1. Is the Operator the only owner* in the dedicated acreage outlined on the plat below?
Yes X No .
2. If the answer to question one is "no," have the interests of all the owners been consolidated by communitization agreement or otherwise? Yes No . If answer is "yes," Type of Consolidation
3. If the answer to question two is "no," list all the owners and their respective interests below:

Owner

Land Description

Section. B

R28E

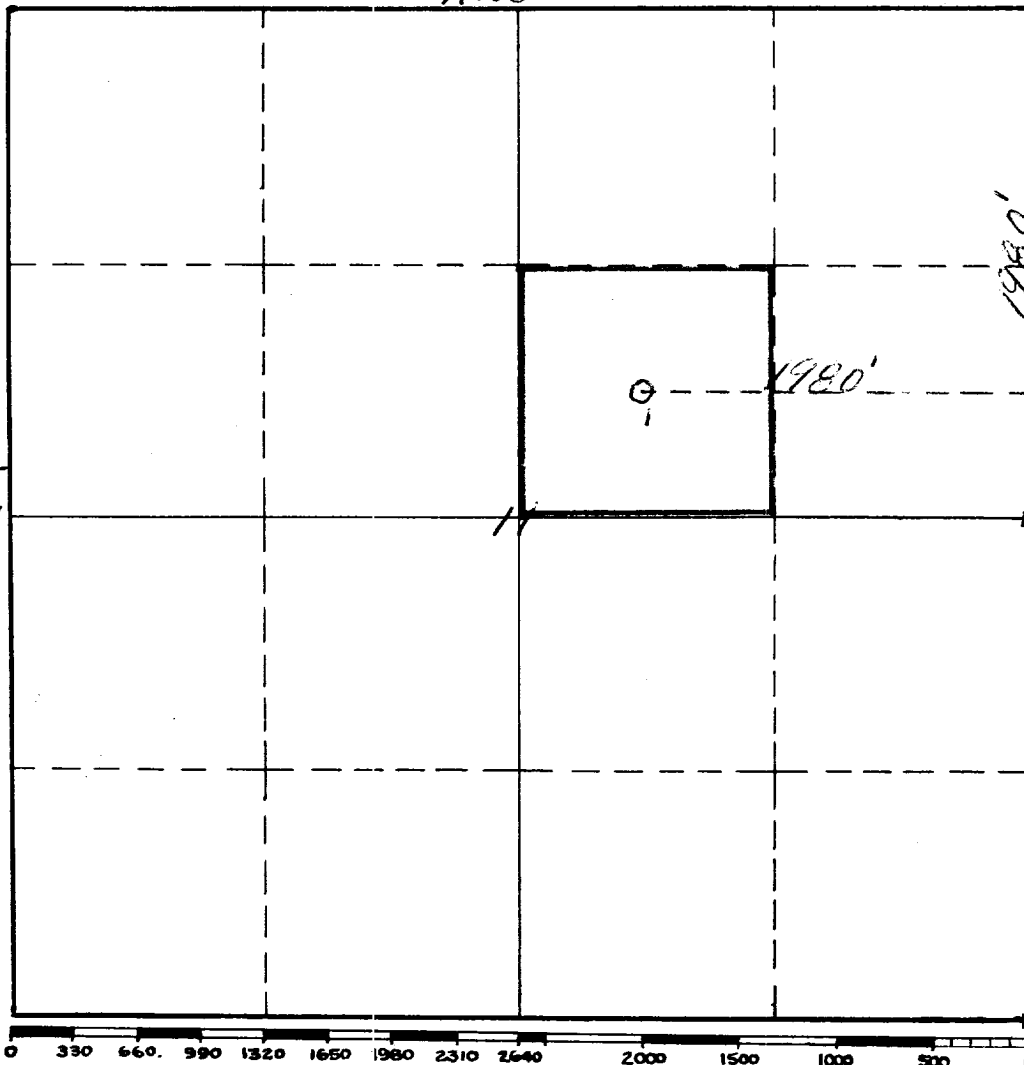

This is to certify that the information in Section A above is true and complete to the best of my knowledge and belief.

CASTLE & WIGZELL

(Operator)

H. Brace Wigzell
(Representative)

Box 868, Midland, Texas

Address

This is to certify that the well location shown on the plat in Section B was plotted from field notes of actual surveys made by me or under my supervision and that the same is true and correct to the best of my knowledge and belief.

Date Surveyed November 7th 1958

James H. Brown
Registered Professional
Engineer and/or Land Surveyor.

Certificate No. 542

(See instructions for completing this form on the reverse side)