

STAKING PLAT

G. Kelley Stant

~~PRICE AND GROUT~~

Superior State

3

Operator

Lease

Well

Eddy

County, New Mexico

990 feet from East and 2310 feet from North lines of

Section 12, Township 17, Range 28

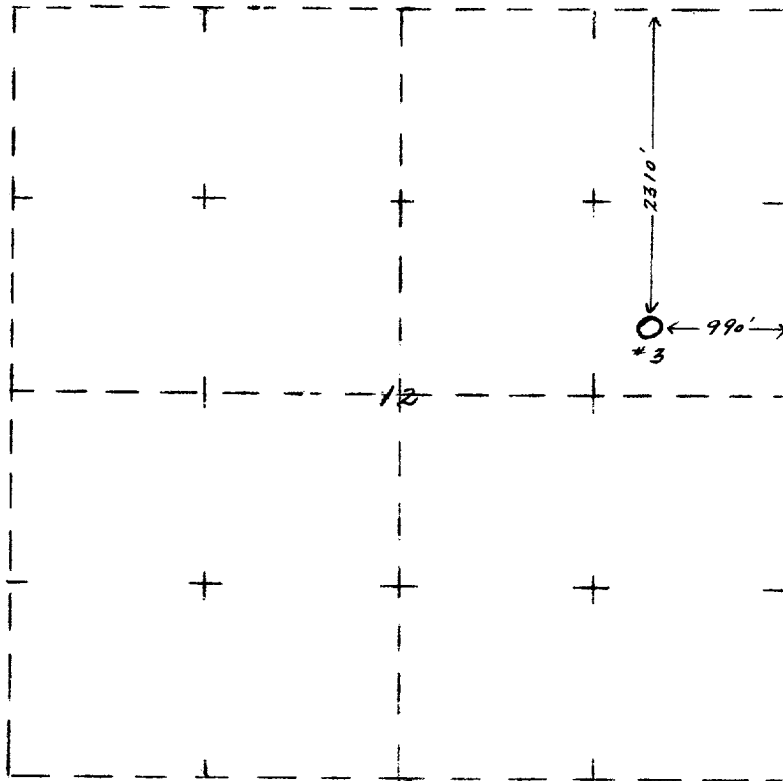

Certificate

The undersigned is registered as a Land Surveyor in the State of New Mexico and hereby swears that this plat was prepared from field notes made under his direction, and that it is true and correct to the best of his knowledge and belief.

Vilas P. Sheldon
Vilas P. Sheldon