

(SUBMIT IN TRIPLICATE)

UNITED STATES
DEPARTMENT OF THE INTERIOR
GEOLOGICAL SURVEY

Land Office

Lease No. NM012896

Unit

RECEIVED

FEB 7 1961

D. C. C.
ARTESIA, OFFICE

NOTICE OF INTENTION TO DRILL	<input checked="" type="checkbox"/>	SUBSEQUENT REPORT OF WATER SHUT-OFF	
NOTICE OF INTENTION TO CHANGE PLANS		SUBSEQUENT REPORT OF SHOOTING OR ACIDIZING	
NOTICE OF INTENTION TO TEST WATER SHUT-OFF		SUBSEQUENT REPORT OF ALTERING CASING	
NOTICE OF INTENTION TO RE-DRILL OR REPAIR WELL		SUBSEQUENT REPORT OF RE-DRILLING OR REPAIR	
NOTICE OF INTENTION TO SHOOT OR ACIDIZE		SUBSEQUENT REPORT OF ABANDONMENT	
NOTICE OF INTENTION TO PULL OR ALTER CASING		SUPPLEMENTARY WELL HISTORY	
NOTICE OF INTENTION TO ABANDON WELL			

(INDICATE ABOVE BY CHECK MARK NATURE OF REPORT, NOTICE, OR OTHER DATA)

Artesia, New Mexico 2-6-61, 19

Aztec Federal

Well No. 3 is located 2310 ft. from ~~XXX~~ ^[N] line and 990 ft. from ~~XXX~~ ^[E] line of sec. 15SENE Sec. 15 17 South 28 East N.M.P.M.
($\frac{1}{4}$ Sec. and Sec. No.) (Twp.) (Range) (Meridian)Red Lake
(Field)Eddy
(County or Subdivision)New Mexico
(State or Territory)

The elevation of the derrick floor above sea level is 3627 ft. (627)

DETAILS OF WORK

(State names of and expected depths to objective sands; show sizes, weights, and lengths of proposed casings; indicate mudding jobs, cementing points, and all other important proposed work)

We propose to drill a well to test the Premier pay section at approximately 2150 feet.

We propose the following casing program.

8 5/8" at Approximately 450 feet - 50 sacks

5 1/2" to total depth or through pay section - 100 sacks.

I understand that this plan of work must receive approval in writing by the Geological Survey before operations may be commenced.

Company Kincaid & Watson Drilling Company

Address Box 498

Artesia, New Mexico

By

Title Agent

FEB 6 1961

NUMBER OF COPIES RECEIVED	
DISTRIBUTION	
SANTA FE	
FILE	
U.S.G.S.	
LAND OFFICE	
TRANSPORTER	OIL GAS
PRODUCTION OFFICE	
OPERATOR	

NEW MEXICO OIL CONSERVATION COMMISSION
WELL LOCATION AND ACREAGE DEDICATION PLAT
 SEE INSTRUCTIONS FOR COMPLETING THIS FORM ON THE REVERSE SIDE

FORM C-128
Revised 5/1/57

SECTION A

Operator Kincaid & Watson Drilling Co.		Lease Aztec		Well No. 3	
Unit Letter H	Section 15	Township 17 South	Range 28 East	County Eddy	
Actual Footage Location of Well: 2310 feet from the North line and 990 feet from the East line					
Ground Level Elev. 3627	Producing Formation Permian		Pool Red Lake	Dedicated Acreage: 40 Acres	

1. Is the Operator the only owner in the dedicated acreage outlined on the plat below? YES YES NO _____. ("Owner" means the person who has the right to drill into and to produce from any pool and to appropriate the production either for himself or for himself and another. (65-3-29 (e) NMSA 1935 Comp.)
2. If the answer to question one is "no," have the interests of all the owners been consolidated by communitization agreement or otherwise? YES ____ NO _____. If answer is "yes," Type of Consolidation _____
3. If the answer to question two is "no," list all the owners and their respective interests below:

Owner	Land Description
	FEB - 1961

SECTION B

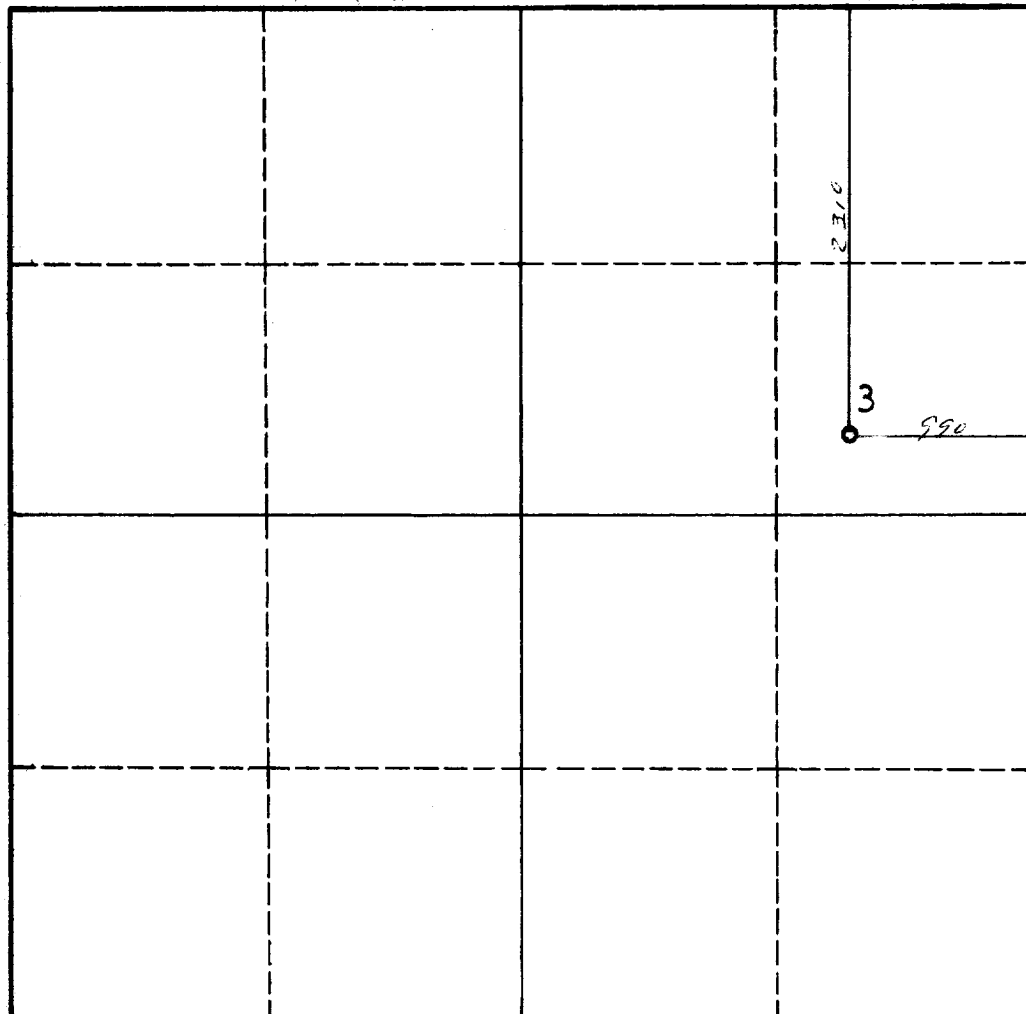

CERTIFICATION

I hereby certify that the information in SECTION A above is true and complete to the best of my knowledge and belief.

Name	<i>[Signature]</i>
Position	Agent
Company	Kincaid & Watson Drilling Company
Date	February 6, 1961

I hereby certify that the well location shown on the plat in SECTION B was plotted from field notes of actual surveys made by me or under my supervision, and that the same is true and correct to the best of my knowledge and belief.

Date Surveyed	February 3, 1961
Registered Professional Engineer and/or Land Surveyor	<i>[Signature]</i>

Certificate No.
1502

0 330 660 990 1320 1650 1980 2310 2640 2000 1500 1000 500 0