

NUMBER OF COPIES RECEIVED	
DISTRIBUTION	
SANTA FE	
FILE	
U.S.G.S.	
LAND OFFICE	
TRANSPORTER	OIL
	GAS
PRODUCTION OFFICE	
OPERATOR	

NEW MEXICO OIL CONSERVATION COMMISSION
WELL LOCATION AND ACREAGE DEDICATION PLAT
 SEE INSTRUCTIONS FOR COMPLETING THIS FORM ON THE REVERSE SIDE

FORM C-128
 Revised 5/1/57

SECTION A

Operator Simms & Reese			Lease Hartle		Well No. 7
Unit Letter L	Section 18	Township T-17-S	Range R-28-E	County Eddy	
Actual Footage Location of Well: 990 feet from the West line and 1650 feet from the South line					
Ground Level Elev. 3565	Producing Formation	Pool Empire (Y.S.R.)	Dedicated Acreage: Acres		

1. Is the Operator the only owner in the dedicated acreage outlined on the plat below? YES _____ NO _____. ("Owner" means the person who has the right to drill into and to produce from any pool and to appropriate the production either for himself or for himself and another. (65-3-29 (e) NMSA 1935 Comp.)
2. If the answer to question one is "no," have the interests of all the owners been consolidated by communization agreement or otherwise? YES _____ NO _____. If answer is "yes," Type of Consolidation _____
3. If the answer to question two is "no," list all the owners and their respective interests below:

Owner	Land Description
	JAN 6 1965

O. C. C.
ARTESIA, OFFICE
CERTIFICATION

SECTION B

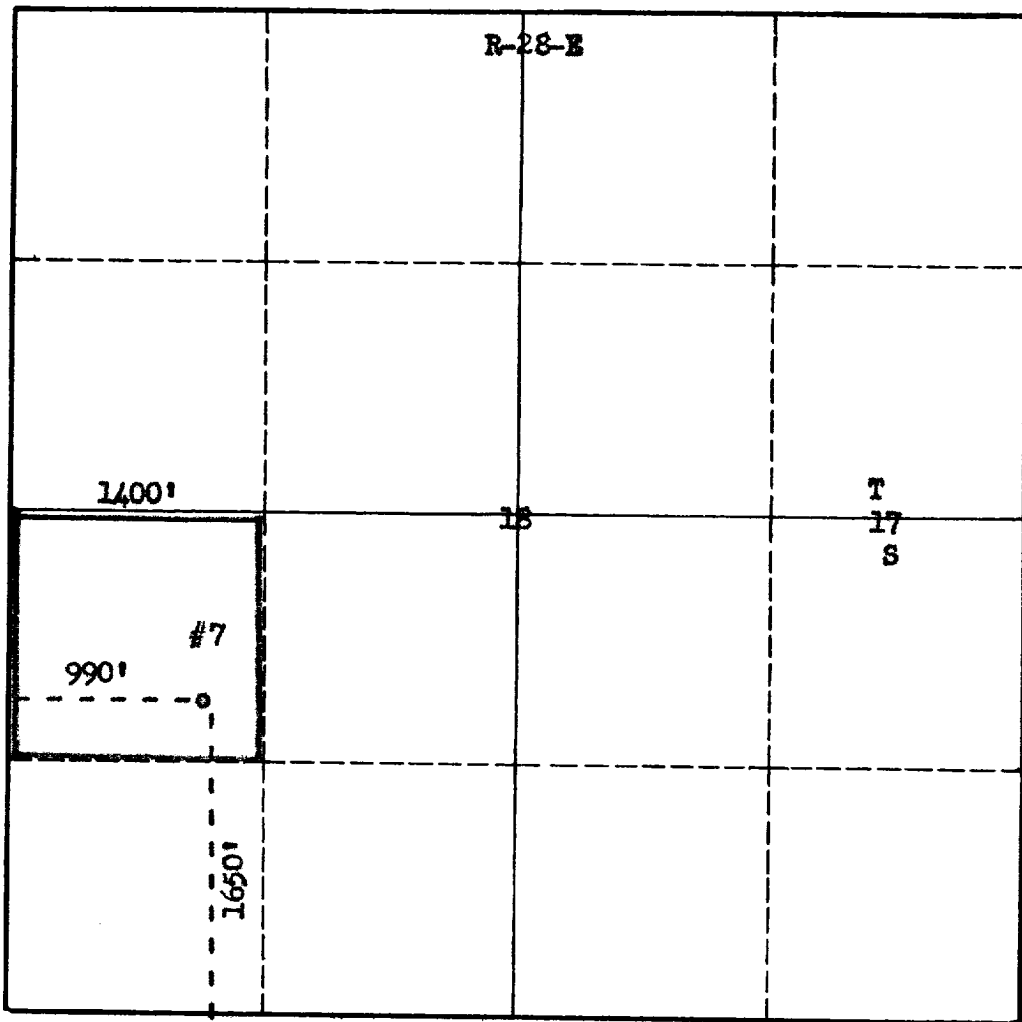

I hereby certify that the information in SECTION A above is true and complete to the best of my knowledge and belief.

Name P. A. Plunsel
Position Partner
Company Simms & Reese Co.
Date 1/5/65

I hereby certify that the well location shown on the plat in SECTION B was plotted from field notes of actual surveys made by me or under my supervision, and that the same is true and correct to the best of my knowledge and belief.

Date Surveyed July 29, 1964
Registered Professional Engineer and/or Land Surveyor James H. Suran
Certificate No. 542

0 330 660 990 1320 1650 1980 2310 2640 2000 1500 1000 500 0