

NEW MEXICO OIL CONSERVATION COMMISSION

FORM C-103
(Rev 3-55)

MISCELLANEOUS REPORTS ON WELLS

(Submit to appropriate District Office as per Commission Rule 1106)

Name of Company John B. Castle and H. Brace Wiggzell		(Castle and Wiggzell) Address P. O. Box 868, Midland, Texas				
Lease Gulf-State	Well No. 2	Unit Letter C	Section 22	Township 17-S	Range 28-E	
Date Work Performed 5-16-59	Pool Red Lake			County Eddy		

THIS IS A REPORT OF: (Check appropriate block)

- ☒ Beginning Drilling Operations ☐ Casing Test and Cement Job ☐ Other (Explain):
☐ Plugging ☐ Remedial Work

Detailed account of work done, nature and quantity of materials used, and results obtained.

5-16-59: Spudded

Witnessed by <i>H. Brace Wiggzell</i>	Position Partner	Company Castle and Wiggzell
--	----------------------------	---------------------------------------

FILL IN BELOW FOR REMEDIAL WORK REPORTS ONLY

ORIGINAL WELL DATA

D F Elev.	T D	P BTD	Producing Interval	Completion Date
Tubing Diameter	Tubing Depth	Oil String Diameter	Oil String Depth	
Perforated Interval(s)				
Open Hole Interval		Producing Formation(s)		

RESULTS OF WORKOVER

Test	Date of Test	Oil Production BPD	Gas Production MCFPD	Water Production BPD	GOR Cubic feet/Bbl	Gas Well Potential MCFPD
Before Workover						
After Workover						

OIL CONSERVATION COMMISSION

I hereby certify that the information given above is true and complete to the best of my knowledge.

Approved by <i>M. Armstrong</i>	Name <i>H. Brace Wiggzell</i>
Title	Position Partner
Date <i>May 16 1959</i>	Company Castle and Wiggzell

OIL CONSERVATION COMMISSION
ARTESIA DISTRICT OFFICE

No. Cont. No. 100		
Operator		
Survey No.		
Proportion of Int.		
State Land Office		
U. S. G. S.		
Transcript		
File		

NOTICE OF INTENTION TO DRILL

Notice must be given to the District Office of the Oil Conservation Commission and approval obtained before drilling or recompletion begins. If changes in the proposed plan are considered advisable, a copy of this notice showing such changes will be returned to the sender. Submit this notice in **QUINTUPLICATE**. One copy will be returned following approval. See additional instructions in Rules and Regulations of the Commission. If State Land submit 6 Copies Attach Form C-128 in triplicate to first 3 copies of form C-101

Midland, Texas
(Place)

April 29, 1959
(Date)

OIL CONSERVATION COMMISSION
SANTA FE, NEW MEXICO

Gentlemen:

You are hereby notified that it is our intention to commence the Drilling of a well to be known as
John B. Castle and H. Brace Wiggzell (Castle and Wiggzell)
(Company or Operator)

Gulf-State (Lease), Well No. 2, in C (Unit) The well is located 330 feet from the North line and 2310 feet from the West line of Section 22, T. 17-S, R. 28-E, NMPM.
(GIVE LOCATION FROM SECTION LINE) Red Lake Pool, Eddy County

330' NL & 2310' WL

D	C	B	A
E	F	G	H
L	K	J	I
M	N	O	P

If State Land the Oil and Gas Lease is No. B-1969
If patented land the owner is _____
Address _____

We propose to drill well with drilling equipment as follows: Cable tools

The status of plugging bond is Blanket Bond approved

Drilling Contractor Bowen Drilling Co.
Artesia, New Mexico

We intend to complete this well in the Grayburg formation at an approximate depth of 2100' feet.

CASING PROGRAM

We propose to use the following strings of Casing and to cement them as indicated:

Size of Hole	Size of Casing	Weight per Foot	New or Second Hand	Depth	Sacks Cement
<u>10"</u>	<u>8 5/8"</u>	<u>28#</u>	<u>SH</u>	<u>550'</u>	<u>50</u>
<u>8"</u>	<u>5 1/2"</u>	<u>15#</u>	<u>New</u>	<u>2100'</u>	<u>Circulate</u>

If changes in the above plans become advisable we will notify you immediately.

ADDITIONAL INFORMATION (If recompletion give full details of proposed plan of work.)

Approved _____, 19____
Except as follows:

OIL CONSERVATION COMMISSION

By M. L. Armstrong

Sincerely yours,

Castle and Wiggzell
(Company or Operator)
By H. Brace Wiggzell
Position Partner
Send Communications regarding well to
Name Castle and Wiggzell
Address P. O. Box 868, Midland, Texas

NEW MEXICO OIL CONSERVATION COMMISSION

Well Location and Acreage Dedication Plat

Section A.

Date April 29, 1959

Operator John B. Castle and H. Brace Wigzell Lease Gulf-State
Well No. 2 Unit Letter C Section 22 Township 17 S Range 28 E NMPM
Located 330 Feet From North Line, 2310 Feet From West Line
County Eddy G. L. Elevation 3550 Dedicated Acreage 40.00 Acres
Name of Producing Formation _____ Pool Red Lake

1. Is the Operator the only owner* in the dedicated acreage outlined on the plat below?
Yes X No _____.
2. If the answer to question one is "no," have the interests of all the owners been consolidated by communitization agreement or otherwise? Yes _____ No _____. If answer is "yes," Type of Consolidation _____
3. If the answer to question two is "no," list all the owners and their respective interests below:

Owner

Land Description

Section B

R28E

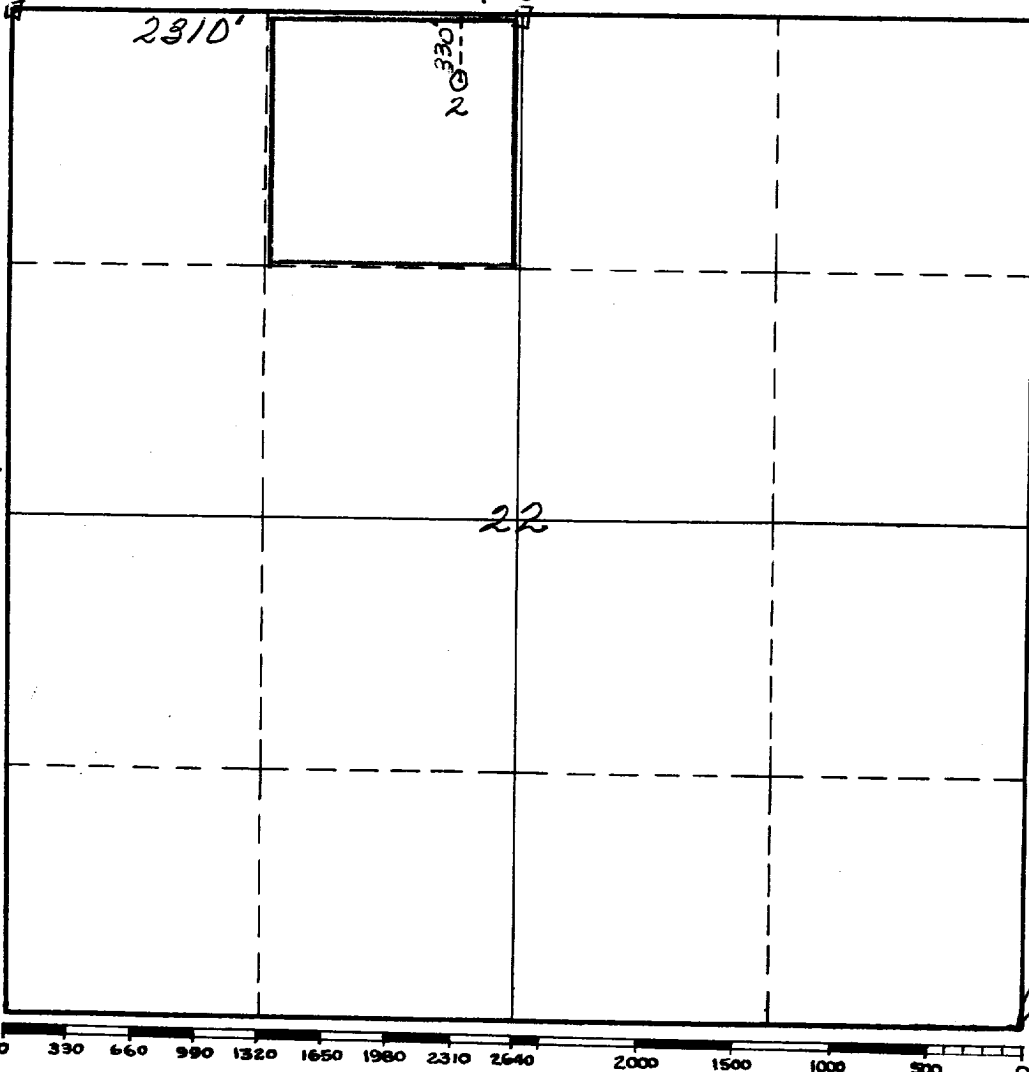

This is to certify that the information in Section A above is true and complete to the best of my knowledge and belief.

Castle and Wigzell

(Operator)

H. Brace Wigzell
(Representative)

Box 868, Midland, Texas

Address

This is to certify that the well location shown on the plat in Section B was plotted from field notes of actual surveys made by me or under my supervision and that the same is true and correct to the best of my knowledge and belief.

Date Surveyed January 5, 1959

James H. Brown
Registered Professional
Engineer and/or Land Surveyor.

Certificate No. 542

(See instructions for completing this form on the reverse side)

INSTRUCTIONS FOR COMPLETION

1. Operator shall furnish and certify to the information called for in Section A.
2. Operator shall outline the dedicated acreage for both oil and gas wells on the plat in Section B.
3. A registered professional engineer or land surveyor registered in the State of New Mexico or approved by the Commission shall show on the plat the location of the well and certify this information in the space provided.
4. All distances shown on the plat must be from the outer boundaries of Section.
5. If additional space is needed for listing owners and their respective interests as required in question 3, Section A, please use space below

* "Owner" means the person who has the right to drill into and to produce from any pool and to appropriate the production either for himself or for himself and another. (65-3-29 (e) NMSA 1953 Comp.)