

Memo

3-17-80

From

W. A. GRESSETT
Supervisor

To Santa Fe File Room

According to our records the
Red Lake Oil Co. State B-1111
2 is located 2310'N - 990'E
of section 22 - 17s - 28E,
said well was P & A in 1962.

As a result of recent development
in the area the location was
checked and found to be

2290'N + 971'E see attached plat.

Please correct your records

W. A. Gressett

NEW MEXICO OIL CONSERVATION COMMISSION
WELL LOCATION AND ACREAGE DEDICATION PLAT

Copy to 315
4563
State Land Office
File
Form C-102
Supersedes C-128
Effective 1-1-65

All distances must be from the outer boundaries of the Section.

Operator Red Lake Oil Company			Lease State B-1111			Well No. 22
Unit Letter H	Section 22	Township 17 South	Range 28 East	County Eddy		
Actual Footage Location of Well: 2290 feet from the North line and 971 feet from the East line						
Ground Level Elev.		Producing Formation Grayburg		Pool Red Lake		Dedicated Acreage: 40 Acres

1. Outline the acreage dedicated to the subject well by colored pencil or hatchure marks on the plat below.
2. If more than one lease is dedicated to the well, outline each and identify the ownership thereof (both as to working interest and royalty).
3. If more than one lease of different ownership is dedicated to the well, have the interests of all owners been consolidated by communitization, unitization, force-pooling, etc?

RECEIVED

MAR 17 1980

☐ Yes ☐ No If answer is "yes," type of consolidation O. C. D.

If answer is "no," list the owners and tract descriptions which have actually been consolidated. (Use reverse side of this form if necessary.)

No allowable will be assigned to the well until all interests have been consolidated (by communitization, unitization, forced-pooling, or otherwise) or until a non-standard unit, eliminating such interests, has been approved by the Commission.

NOTE: Plat to show location of abandoned well located near a point 2310 FNL, and 990 FEL

2290'

971'

CERTIFICATION

I hereby certify that the information contained herein is true and complete to the best of my knowledge and belief.

Name
Cheri Monk
Position
Secretary
Company
Collier & Collier
Date
March 14, 1980

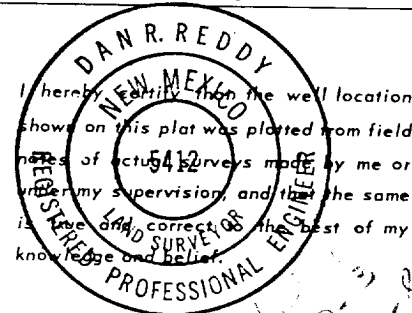

Date Surveyed
February 26, 1980
Registered Professional Engineer
and/or Land Surveyor

Dan R. Reddy
Certificate No.
NM PE&LS #5412

