

NEW MEXICO OIL CONSERVATION COMMISSION
Santa Fe, New Mexico

SEP 10 1957
Form C-101
Revised (12/1/55)

Oil Cons. Comm.

NOTICE OF INTENTION TO DRILL

Notice must be given to the District Office of the Oil Conservation Commission and approval obtained before drilling or recompletion begins. If changes in the proposed plan are considered advisable, a copy of this notice showing such changes will be returned to the sender. Submit this notice in QUINTUPPLICATE. One copy will be returned following approval. See additional instructions in Rules and Regulations of the Commission. If State Land submit 6 Copies Attach Form C- 128 in triplicate to first 3 copies of form C-101

Artesia, New Mexico
(Place)

September 10, 1957
(Date)

OIL CONSERVATION COMMISSION
SANTA FE, NEW MEXICO

Gentlemen:

You are hereby notified that it is our intention to commence the Drilling of a well to be known as
Donnelly Drilling Company, Inc.

(Company or Operator)

Wentz State
(Lease)

Well No. 3, in P (Unit) The well is

located 990 feet from the South line and 330 feet from the East line of Section 24, T. 17S, R. 28E, NMPM.

(GIVE LOCATION FROM SECTION LINE)

A1d Pool, Eddy County

If State Land the Oil and Gas Lease is No. B-6251

If patented land the owner is

Address

We propose to drill well with drilling equipment as follows: Cable Tools

The status of plugging bond is \$10,000.00 Blanket Bond

Drilling Contractor Donnelly Drilling Company, Inc.

We intend to complete this well in the Yates-Seven Rivers formation at an approximate depth of 900 feet.

CASING PROGRAM

We propose to use the following strings of Casing and to cement them as indicated:

Size of Hole	Size of Casing	Weight per Foot	New or Second Hand	Depth	Sacks Cement
10"	7	17#	S.H.	350'	Mudded
7"	4 1/2	9.50#	New	900'	25

If changes in the above plans become advisable we will notify you immediately.

ADDITIONAL INFORMATION (If recompletion give full details of proposed plan of work.)

SEP 10 1957

Approved _____, 19____
Except as follows:

OIL CONSERVATION COMMISSION

By McLamstron

Sincerely yours,

Donnelly Drilling Company, Inc.

(Company or Operator)

By J. H. Donnelly

Position President

Send Communications regarding well to

Name Donnelly Drilling Company, Inc.

Address Box 433, Artesia, New Mexico

NEW MEXICO OIL CONSERVATION COMMISSION

Well Location and Acreage Dedication Plat

Section A.

Date September 10, 1957

Operator Donnelly Drilling Co., Inc. Lease Wentz State
Well No. 3 Unit Letter P Section 24 Township 17S Range 28E NMPM
Located 990 Feet From South Line, 330 Feet From East Line
County Eddy G. L. Elevation _____ Dedicated Acreage 160 Acres
Name of Producing Formation Yates-Seven Rivers Pool Ald

1. Is the Operator the only owner* in the dedicated acreage outlined on the plat below?
Yes X No _____.
2. If the answer to question one is "no," have the interests of all the owners been consolidated by communitization agreement or otherwise? Yes _____ No _____. If answer is "yes," Type of Consolidation _____
3. If the answer to question two is "no," list all the owners and their respective interests below:

Owner

Land Description

Section B

R28E

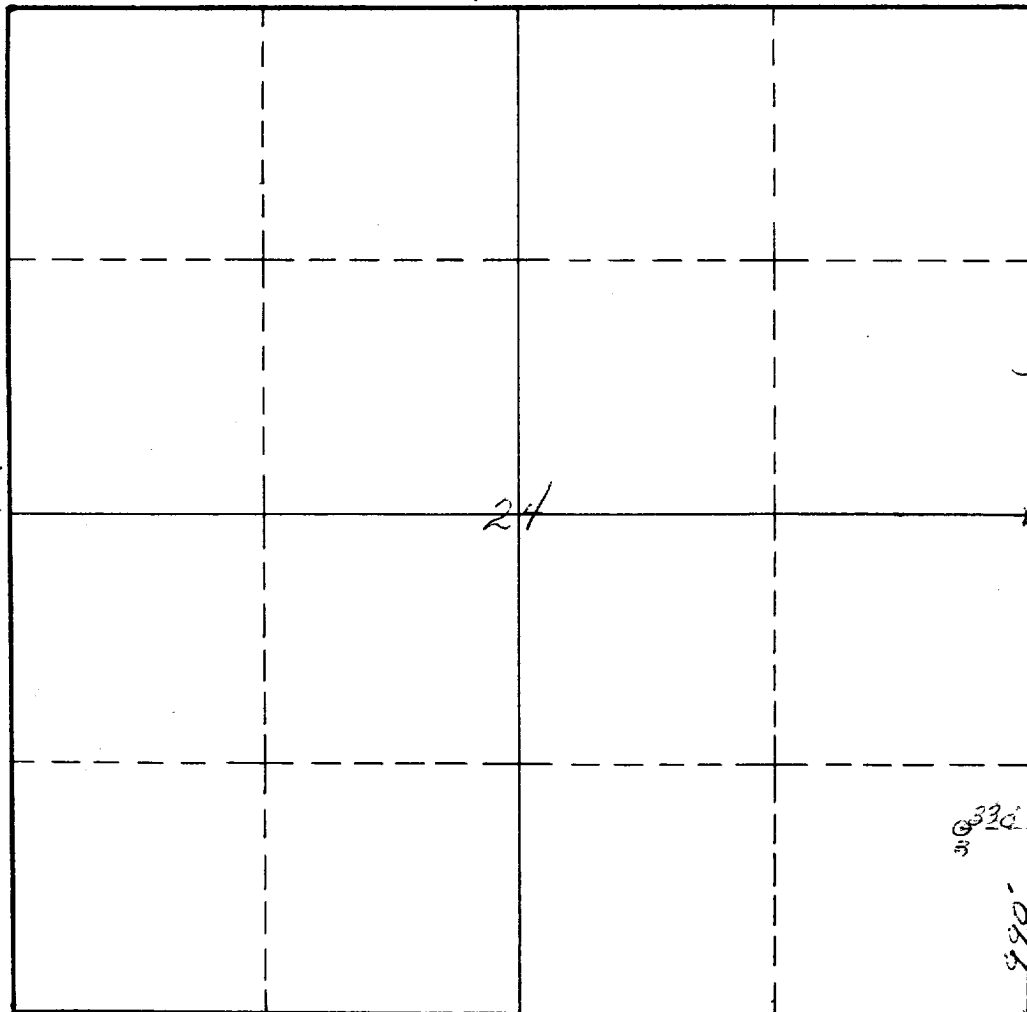

This is to certify that the information in Section A above is true and complete to the best of my knowledge and belief.

Donnelly Drilling Co., Inc.
(Operator)

(Representative)

P.O. Box 433, Artesia, NM.
Address

This is to certify that the well location shown on the plat in Section B was plotted from field notes of actual surveys made by me or under my supervision and that the same is true and correct to the best of my knowledge and belief.

Date Surveyed June 28th 1957

James H. Brown
Registered Professional
Engineer and/or Land Surveyor.

Certificate No. 542

INSTRUCTIONS FOR COMPLETION:

1. Operator shall furnish and certify to the information called for in Section A.
2. Operator shall outline the dedicated acreage for both oil and gas wells on the plat in Section B.
3. A registered professional engineer or land surveyor registered in the State of New Mexico or approved by the Commission shall show on the plat the location of the well and certify this information in the space provided.
4. All distances shown on the plat must be from the outer boundaries of Section.
5. If additional space is needed for listing owners and their respective interests as required in question 3, Section A, please use space below

OIL CONSERVATION COMMISSION		
ARTESIA DISTRICT OFFICE		
No. Copies Received <u>12</u>		
DISTRIBUTION		
	FURNISHED	
Operator		
County Engineer		
Registration Office		
State Land Office		
U.S.G.S.		
Transportation		
File		<input checked="" type="checkbox"/>

* "Owner" means the person who has the right to drill into and to produce from any pool and to appropriate the production either for himself or for himself and another. (65-3-29 (e) NMSA 1953 Comp.)