

NEW MEXICO OIL CONSERVATION COMMISSION  
Santa Fe, New Mexico

RECEIVED  
Revised (12/1/55)

DEC 28 1959

30-015-01667

NOTICE OF INTENTION TO DRILL

Notice must be given to the District Office of the Oil Conservation Commission and approval obtained before drilling or recompletion begins. If changes in the proposed plan are considered advisable, a copy of this notice showing such changes will be returned to the sender. Submit this notice in **QUINTUPPLICATE**. One copy will be returned following approval. See additional instructions in Rules and Regulations of the Commission.

If State Land submit 6 Copies Attach Form C-128 in triplicate to first 3 copies of form C-101

Hebbs, New Mexico

(Place)

December 24, 1959

(Date)

OIL CONSERVATION COMMISSION  
SANTA FE, NEW MEXICO

Gentlemen:

You are hereby notified that it is our intention to commence the Drilling of a well to be known as

**Pan American Petroleum Corporation**

(Company or Operator)

State of New Mexico "BQ"

(Lease)

Well No. **1**, in **0** (Unit) The well is

located **650.24** feet from the **South** line and **1950.8** feet from the

**East**

line of Section **12**, T. **17S**, R. **28E**, NMPM.

(GIVE LOCATION FROM SECTION LINE)

**Empire Abo** Pool, **Eddy** County

If State Land the Oil and Gas Lease is No. **B-11538-1**

If patented land the owner is

Address

We propose to drill well with drilling equipment as follows: **0'-TD with rotary tools**

The status of plugging bond is **Blanket bond on file with commission**

Drilling Contractor **Lee Drilling Company**

**1807 Philtower Building**

**Tulsa, Oklahoma**

We intend to complete this well in the **Abo** formation at an approximate depth of **6500** feet.

CASING PROGRAM

We propose to use the following strings of Casing and to cement them as indicated:

Size of Hole	Size of Casing	Weight per Foot	New or Second Hand	Depth	Sacks Cement
<b>11"</b>	<b>8-5/8"</b>	<b>22.75</b>	<b>New</b>	<b>1000'</b>	<b>Circulated</b>
<b>7-7/8"</b>	<b>4-1/2"</b>	<b>9.55</b>	<b>New</b>	<b>6500'</b>	<b>850 sk</b>

If changes in the above plans become advisable we will notify you immediately.

ADDITIONAL INFORMATION (If recompletion give full details of proposed plan of work.)

DEC 28 1959

Approved....., 19.....  
Except as follows:

OIL CONSERVATION COMMISSION

By *M. L. Armstrong*

Sincerely yours,

**Pan American Petroleum Corporation**

(Company or Operator)

By..... Original Signed by **J. W. BROWN**

Position **Area Superintendent**

Send Communications regarding well to

Name **J. W. Brown**

Address **Box 68 - Hebbs, N.M.**



**NEW MEXICO OIL CONSERVATION COMMISSION**  
**WELL LOCATION AND ACREAGE DEDICATION PLAT**

**RECEIVED**

FORM C-128  
Revised 5/1/57

**DEC 28 1959**

SEE INSTRUCTIONS FOR COMPLETING THIS FORM ON THE REVERSE SIDE

**SECTION A**

ARTESIA, OFFICE

Operator <b>Pan American Pet. Corp.</b>		Lease <b>OF N.M.</b>		State <b>N.M.</b>		Well No. <b>1</b>	
Unit Letter <b>O</b>	Section <b>32</b>	Township <b>17 S</b>	Range <b>28 E</b>	County <b>Eddy</b>			
Actual Footage Location of Well: <b>1950.8</b> feet from the <b>East</b> line and <b>650.24</b> feet from the <b>South</b> line							
Ground Level Elev. <b>Not Avail</b>	Producing Formation <b>Abo</b>		Pool <b>Empire Abo</b>		Dedicated Acreage: <b>40</b> Acres		

1. Is the Operator the only owner in the dedicated acreage outlined on the plat below? YES ☒ NO \_\_\_\_ ("Owner" means the person who has the right to drill into and to produce from any pool and to appropriate the production either for himself or for himself and another. (65-3-29 (e) NMSA 1935 Comp.)
2. If the answer to question one is "no," have the interests of all the owners been consolidated by communitization agreement or otherwise? YES \_\_\_\_ NO \_\_\_\_ . If answer is "yes," Type of Consolidation \_\_\_\_\_
3. If the answer to question two is "no," list all the owners and their respective interests below:

Owner	Land Description

**SECTION B**

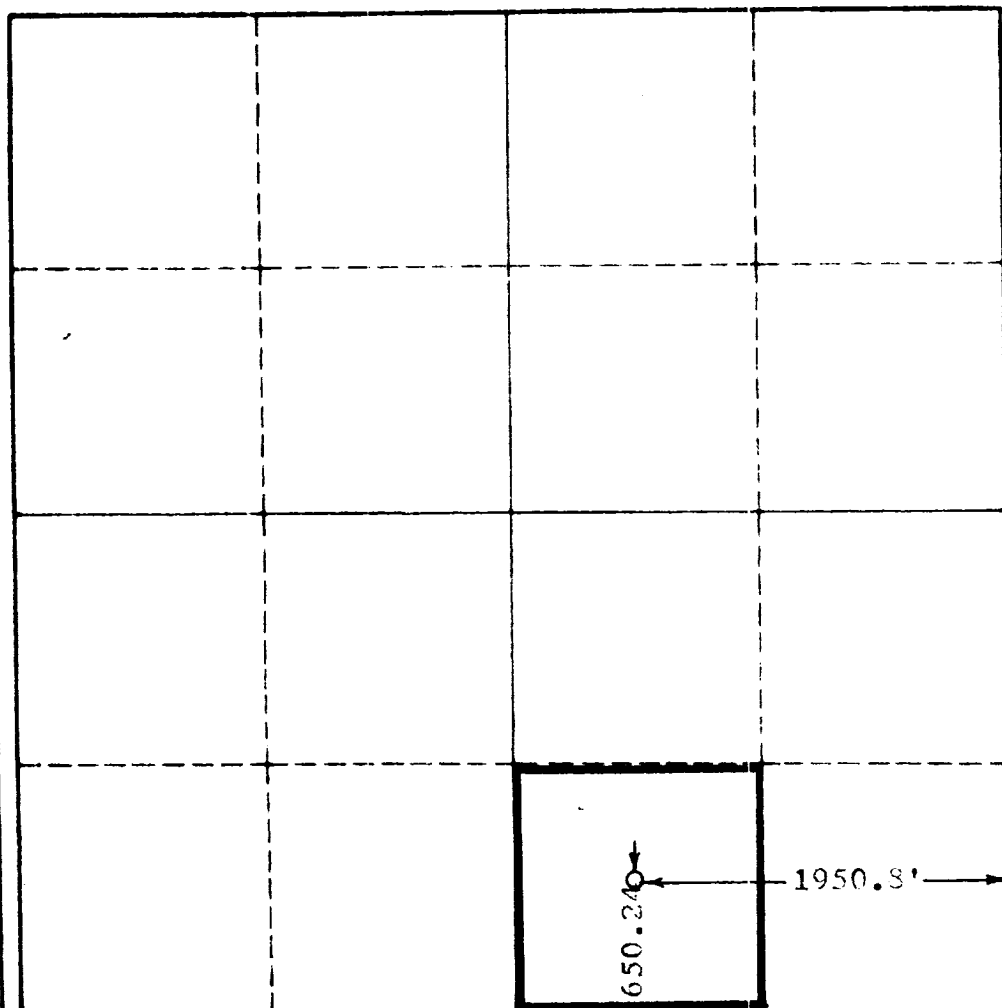

**CERTIFICATION**

I hereby certify that the information in SECTION A above is true and complete to the best of my knowledge and belief.

Name	<b>Original Signed by J. W. BROWN</b>
Position	<b>Area Superintendent</b>
Company	<b>Pan American Petroleum Corp.</b>
Date	<b>12-24-59</b>

I hereby certify that the well location shown on the plat in SECTION B was plotted from field notes of actual surveys made by me or under my supervision, and that the same is true and correct to the best of my knowledge and belief.

Date Surveyed	<b>12-23-59</b>
Registered Professional Engineer and/or Land Surveyor	<b>JOHN W. WEST</b>
Certificate No.	<b>N.M. - P.E. &amp; L.S. NO. 676</b>

JOHN W. WEST ENGINEERING COMPANY  
412 NORTH DAL PASO  
HOBBS, NEW MEXICO

December 23, 1959

Pan American Pet. Corp.  
Hobbs, New Mexico

Gentlemen:

On December 23, 1959, a survey was made to locate your No. 1 location on the State "BG" lease at a point 1950.8 feet from the East and 650.24 feet from the South line of Section 32, Township 17 South, Range 28 East, N.M.P.M., Eddy County, New Mexico.

A flag was set on the U.S.G.L.O. Quarter corner marker common to Sections 32 and 5, and the Transit was set up at the USGLO Section corner marker common to Sections 32, 33, 4 and 5. Thence chaining S88°55'W a distance of 1950.8 feet, thence N0°47'W 650.24 feet from the South boundary line of Section 32 to the location site of the State "BG" No. 1. (the center of the SW $\frac{1}{4}$  SE $\frac{1}{4}$ ) As a check we retraced our survey checking in with a minimum of error.

I hereby certify that the foregoing survey was made in the field under my supervision and that the same is true and correct to the best of my knowledge and belief.

Respectfully submitted,

  
John W. West

OIL CONSERVATION COMMISSION		
ARTESIA DISTRICT OFFICE		
<div> <div> </div> <div> </div> </div>		
DEPARTMENT OF		
	NO. FURNISHED	
MEMPHIS	1	
SANTA FE	1	
PRODUCTION OFFICE		
STATE LAND OFFICE	1	
U. S. G. O.	2	
TRANSPORTER		
FILE	1	
BUREAU OF MINES		