

NEW MEXICO OIL CONSERVATION COMMISSION
Santa Fe, New Mexico

Form C-101
Revised (12/1/55)

NOTICE OF INTENTION TO DRILL

Notice must be given to the District Office of the Oil Conservation Commission and approval obtained before drilling or recompletion begins. If changes in the proposed plan are considered advisable, a copy of this notice showing such changes will be returned to the sender. Submit this notice in QUINTUPPLICATE. One copy will be returned following approval. See additional instructions in Rules and Regulations of the Commission. If State Land submit 6 Copies Attach Form C- 128 in triplicate to first 3 copies of Form C-101

Artesia, New Mexico

(Place)

October 30, 1961

OIL CONSERVATION COMMISSION
SANTA FE, NEW MEXICO

Gentlemen:

You are hereby notified that it is our intention to commence the Drilling of a well to be known as

Western-Yates

(Company or Operator)

State 647

(Lease)

, Well No. 179, in H The well is

located 1980 feet from the North line and 330 feet from the

East line of Section 32, T. 17-S, R. 28-E, NMPM.

(GIVE LOCATION FROM SECTION LINE) Artesia Pool, Eddy County

If State Land the Oil and Gas Lease is No. 647

If patented land the owner is

Address

We propose to drill well with drilling equipment as follows: Cable Tool

The status of plugging bond is Blanket Bond

Drilling Contractor Harvey Yates Drilling Company

We intend to complete this well in the Premier

formation at an approximate depth of 2100 feet.

CASING PROGRAM

We propose to use the following strings of Casing and to cement them as indicated:

Size of Hole	Size of Casing	Weight per Foot	New or Second Hand	Depth	Sacks Cement
12"	8 5/8"	24.00 lb.	Used	500	75
8"	4 1/2"	11.60 lb.	New	2100	125

If changes in the above plans become advisable we will notify you immediately.

ADDITIONAL INFORMATION (If recompletion give full details of proposed plan of work.)

Approved NOV 1 1961, 19.....
Except as follows:

OIL CONSERVATION COMMISSION

By M. L. Armstrong

Sincerely yours,

Western-Yates
(Company or Operator)

By Prod. Supt.

Position R. J. Davenport
Send Communications regarding well to

Name Western-Yates

Address P. O. Box 427, Artesia, New Mexico

NEW MEXICO OIL CONSERVATION COMMISSION
WELL LOCATION AND ACREAGE DEDICATION PLAT

FORM C-128
Revised 5/1/57

SEE INSTRUCTIONS FOR COMPLETING THIS FORM ON THE REVERSE SIDE

SECTION A

Operator Western-Yates Western Development, Inc.			Lease 647		Well No. 179
Unit Letter H	Section 32	Township T-17-S	Range R-28-E	County Eddy	
Actual Footage Location of Well: 1980 feet from the North line and 330 feet from the East line					
Ground Level Elev. 3684	Producing Formation Premier		Pool Artesia		Dedicated Acreage: 40 Acres

1. Is the Operator the only owner in the dedicated acreage outlined on the plat below? YES ☒ NO ____ . ("Owner" means the person who has the right to drill into and to produce from any pool and to appropriate the production either for himself or for himself and another. (65-3-29 (e) NMSA 1935 Comp.)
2. If the answer to question one is "no," have the interests of all the owners been consolidated by communitization agreement or otherwise? YES ____ NO ____ . If answer is "yes," Type of Consolidation ____
3. If the answer to question two is "no," list all the owners and their respective interests below:

Owner	Land Description

SECTION B

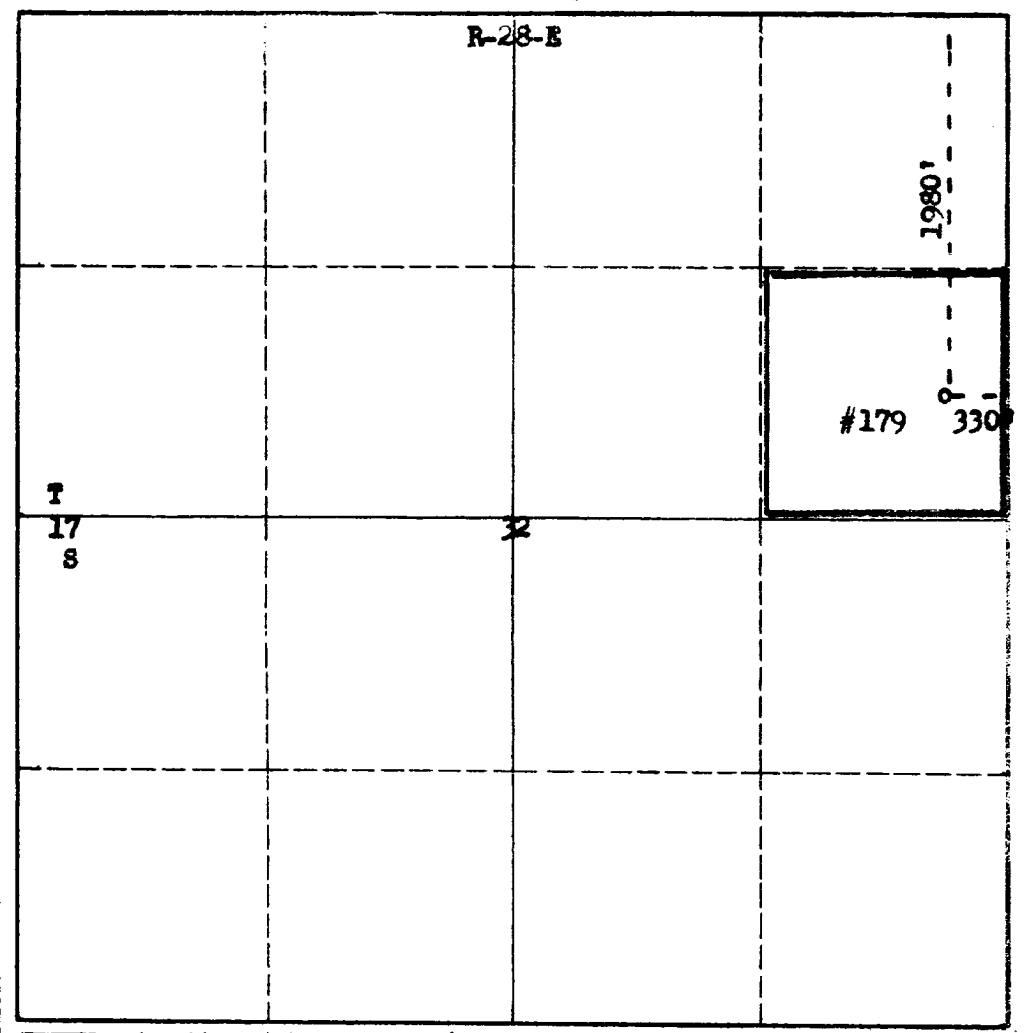

CERTIFICATION

I hereby certify that the information in SECTION A above is true and complete to the best of my knowledge and belief.

Name	Bob Darcourt
Position	Prod. Supt.
Company	Western-Yates
Date	October 30, 1961

I hereby certify that the well location shown on the plat in SECTION B was plotted from field notes of actual surveys made by me or under my supervision, and that the same is true and correct to the best of my knowledge and belief.

Date Surveyed	October 27, 1961
Registered Professional Engineer and/or Land Surveyor	
Certificate No.	3280

INSTRUCTIONS FOR COMPLETION OF FORM C-128

1. Operator shall furnish and certify to the information called for in Section A.
2. Operator shall outline the dedicated acreage for *both* oil and gas wells on the plat in Section B.
3. A registered professional engineer or land surveyor registered in the State of New Mexico or approved by the Commission shall show on the plat the location of the well and certify this information in the space provided.
4. All distances shown on the plat must be from the outer boundaries of the Section.
5. If additional space is needed for listing owners and their respective interests as required in question 3 of Section A, please use space below.

OIL CONSERVATION COMMISSION		
ARTESIA DISTRICT OFFICE		
No. Copies Received		
DISTRIBUTION		
	CO. FURNISHED	
OPERATOR	3	
SANTA FE	1	
PRORATION OFFICE	1	
STATE LAND OFFICE	1	
U. S. G. S.	1	
TRANSPORTER	1	
FILE	1	
BUREAU OF MINES		