

NEW MEXICO OIL CONSERVATION COMMISSION

FORM C-128

1/57

WELL LOCATION AND ACREAGE DEDICATION PLAT

RECEIVED

SEE INSTRUCTIONS FOR COMPLETING THIS FORM ON THE REVERSE SIDE APR 14 1960

SECTION A

Operator Pan American Pet. Corp.		Lease State "BQ"		<input type="checkbox"/> Well No. ARTESIA, OFFICE	
Unit Letter N	Section 34	Township 17 S	Range 28 E	County Eddy	
Actual Footage Location of Well: 1650 feet from the West line and 972.62 feet from the South line					
Ground Level Elev. Not Yet Available	Producing Formation Abo		Pool Undesignated (Empire Abo)		Dedicated Acreage: 40 Acres

1. Is the Operator the only owner in the dedicated acreage outlined on the plat below? YES ☒ NO ☐ ("Owner" means the person who has the right to drill into and to produce from any pool and to appropriate the production either for himself or for himself and another. (65-3-29 (e) NMSA 1935 Comp.)
2. If the answer to question one is "no," have the interests of all the owners been consolidated by communitization agreement or otherwise? YES ☐ NO ☐ . If answer is "yes," Type of Consolidation _____
3. If the answer to question two is "no," list all the owners and their respective interests below:

Owner	Land Description

SECTION B

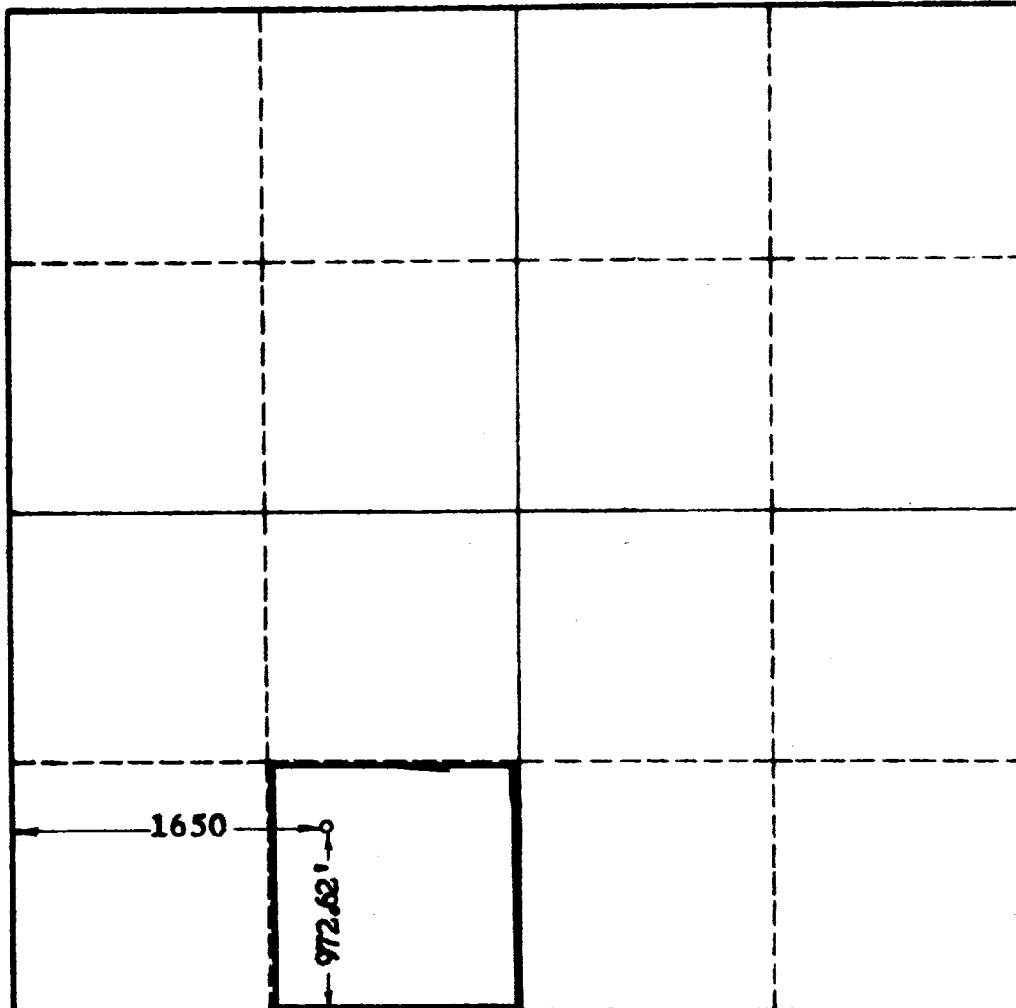

CERTIFICATION

I hereby certify that the information in SECTION A above is true and complete to the best of my knowledge and belief.

Original Signed by
Name **L. W. BROWN**
Position
Area Superintendent
Company
Pan American Petroleum Corp.
Date
April 12, 1960

I hereby certify that the well location shown on the plat in SECTION B was plotted from field notes of actual surveys made by me or under my supervision, and that the same is true and correct to the best of my knowledge and belief.

Date Surveyed
4/9/60
Registered Professional Engineer and/or Land Surveyor, **JOHN W. WEST**
John W. West
Certificate No.
N. M. P. E. S. L. S. NO. 876