

NEW MEXICO OIL CONSERVATION COMMISSION  
Santa Fe, New Mexico

RECEIVED  
Form O-101  
Revised (12/1/55)  
APR 14 1960

NOTICE OF INTENTION TO DRILL

Notice must be given to the District Office of the Oil Conservation Commission and approval obtained before drilling or recompletion begins. If changes in the proposed plan are considered advisable, a copy of this notice showing such changes will be returned to the sender. Submit this notice in QUINTUPLICATE. One copy will be returned following approval. See additional instructions in Rules and Regulations of the Commission. If State Land submit 6 Copies Attach Form O-128 in triplicate to first 3 copies of form O-101

Hobbs, New Mexico

(Place)

April 13, 1960

(Date)

OIL CONSERVATION COMMISSION  
SANTA FE, NEW MEXICO

Gentlemen:

You are hereby notified that it is our intention to commence the Drilling of a well to be known as

Pan American Petroleum Corporation

(Company or Operator)

State of New Mexico "BT"

(Lease)

Well No. 1, in 0 (Unit) The well is

located 1938.54 feet from the North line and 1965.60 feet from the East

Line of Section 34, T. 17-S, R. 28-E, NMPM.

(GIVE LOCATION FROM SECTION LINE) Undesignated Pool, May County

D	C	B	A
E	F	G	H
L	K	J	I
M	N	O	P

If State Land the Oil and Gas Lease is No. E-7116

If patented land the owner is

Address

We propose to drill well with drilling equipment as follows: Q-72 with rotary tools.

The status of plugging bond is Blanket bond on file with commission.

Drilling Contractor Lee Drilling Company  
Philhower Building  
Tulsa, Oklahoma

We intend to complete this well in the Abu formation at an approximate depth of 6500 feet.

CASING PROGRAM

We propose to use the following strings of Casing and to cement them as indicated:

Size of Hole	Size of Casing	Weight per Foot	New or Second Hand	Depth	Sacks Cement
11"	8 5/8"	22.74	New	1500	Circulated
7 7/8"	4 1/2"	9.54	New	6500	Sufficient to tie into surface pipe.

If changes in the above plans become advisable we will notify you immediately.

ADDITIONAL INFORMATION (If recompletion give full details of proposed plan of work.)

APR 14 1960

Approved Except as follows: , 19.

OIL CONSERVATION COMMISSION

By M. L. Armstrong

Sincerely yours,

Pan American Petroleum Corporation

(Company or Operator)

Original Signed by L. W. BROWN

Position Area Superintendent

Send Communications regarding well to

Name J. W. Brown

Address Box 68, Hobbs, New Mexico

# NEW MEXICO OIL CONSERVATION COMMISSION RECEIVED

## WELL LOCATION AND ACREAGE DEDICATION PLAT

Revised 5/1/57

APR 14 1960

SEE INSTRUCTIONS FOR COMPLETING THIS FORM ON THE REVERSE SIDE

### SECTION A

Operator <b>Pan American Pet. Corp.</b>		Lease <b>State "BT"</b>		ARTESIAN SPRING <b>1</b>	
Unit Letter <b>G</b>	Section <b>34</b>	Township <b>17 S</b>	Range <b>28 E</b>	County <b>Eddy</b>	

Actual Footage Location of Well:  
**1965.68** feet from the **East** line and **1938.54** feet from the **North** line

Ground Level Elev. <b>Not Yet Available</b>	Producing Formation <b>Abo</b>	Pool <b>Undesignated (Empire Abo)</b>	Dedicated Acreage: <b>40</b> Acres
--	-----------------------------------	--	---------------------------------------

1. Is the Operator the only owner in the dedicated acreage outlined on the plat below? YES ☒ NO ☐ ("Owner" means the person who has the right to drill into and to produce from any pool and to appropriate the production either for himself or for himself and another. (65-3-29 (c) NMSA 1935 Comp.)
2. If the answer to question one is "no," have the interests of all the owners been consolidated by communitization agreement or otherwise? YES ☐ NO ☐ . If answer is "yes," Type of Consolidation \_\_\_\_\_
3. If the answer to question two is "no," list all the owners and their respective interests below:

Owner	Land Description

### SECTION B

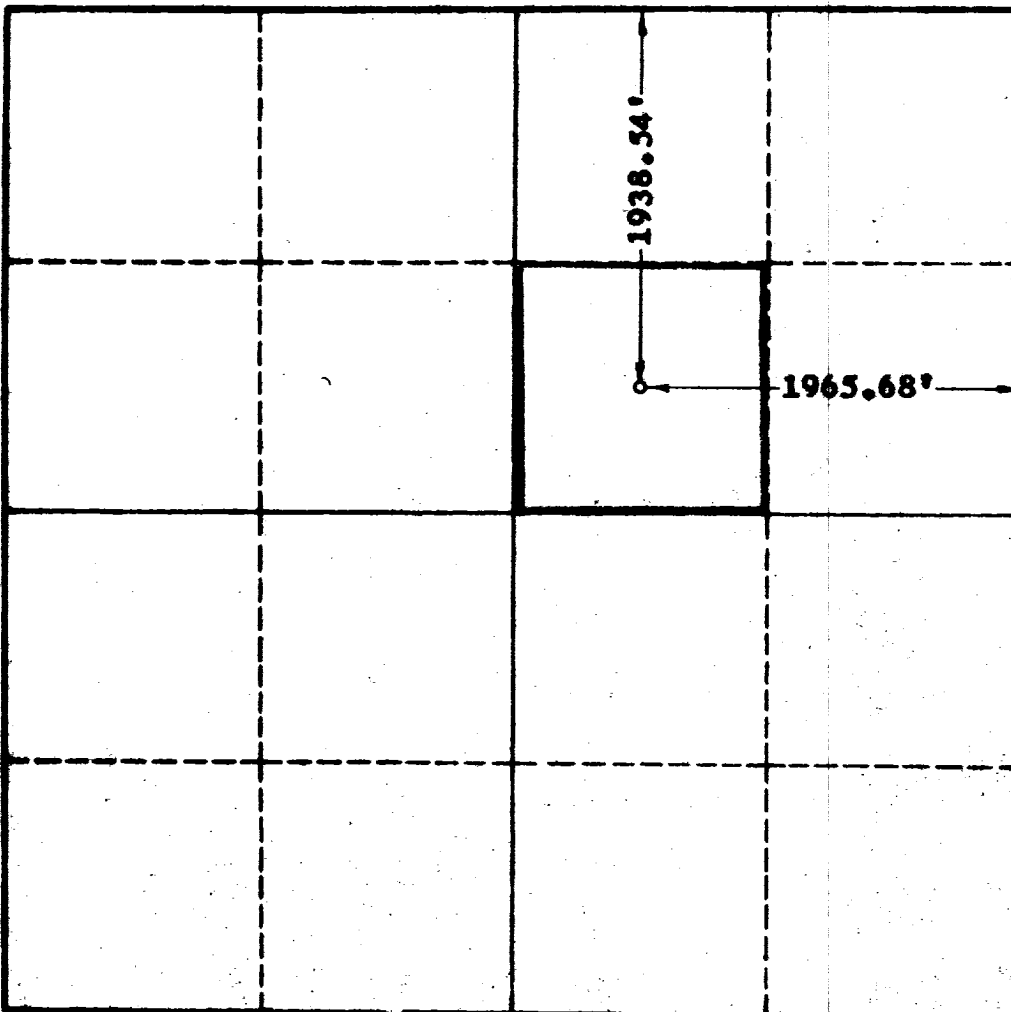

### CERTIFICATION

I hereby certify that the information in SECTION A above is true and complete to the best of my knowledge and belief.

Name  
Original Signed by  
**J. W. BROWN**  
Position  
**Area Superintendent**  
Company  
**Pan American Petroleum Corp.**  
Date  
**April 13, 1960**

I hereby certify that the well location shown on the plat in SECTION B was plotted from field notes of actual surveys made by me or under my supervision, and that the same is true and correct to the best of my knowledge and belief.

Date Surveyed  
**4/9/60**  
Registered Professional Engineer  
and/or Land Surveyor, **JOHN W. WEST**  
*[Signature]*  
Certificate No.  
**N.M. P.E. - 915 - 678**

0 330 660 990 1320 1650 1980 2310 2640 2970 3300 3630 3960 4290 4620 4950 5280 5610 5940 6270

RECEIVED

## JOHN W. WEST ENGINEERING COMPANY

412 NORTH BAL PASO  
HOBBS, NEW MEXICO

April 11, 1960

APR 14 1960

O. C. C.  
ARTESIA, OFFICE

Pan American Petroleum Corp.  
P.O. Box 68  
Hobbs, New Mexico.

Gentlemen:

On April 9, 1960, a survey was made to stake the location of your State "BT" No. 1 well at a point 1938.54 feet from the North line and 1965.68 feet from the East line of Section 34, Twp. 17 South, Rng. 28 East, N.M.P.M., Eddy County, New Mexico.

The transit was placed over the USGLO marker set for the Northeast corner of said Section 34 and a foresight was taken on a flag set at the USGLO marker set for the North Quarter Section corner of said Section 34. Thence chaining along the North boundary line  $289^{\circ} 23' W$  from the Northeast corner of said Section 34 a distance of 1965.68 feet and setting a hub with tack at this point. Thence chaining  $80^{\circ} 02' E$  from said hub a distance of 1938.54 feet to the location. As a check on our survey we chained  $N89^{\circ} 23' E$  from the location a distance of 1965.68 feet and  $80^{\circ} 02' E$  a distance of 651.76 feet to the USGLO marker set for the East Quarter Section corner of said Section 34, closing within 0.26 feet of the distance shown on the USGLO Township Plats.

I hereby certify that the foregoing survey was made in the field by me and that the same is true and correct to the best of my knowledge and belief.

Respectfully submitted,

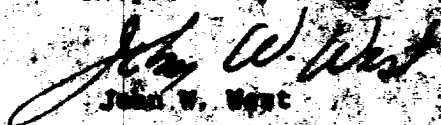
  
John W. West

OIL CONSERVATION COMMISSION		
ARTESIA DISTRICT OFFICE		
No. Copies Received	6	
DISTRIBUTION		
	NO. FURNISHED	
OPERATOR	1	
SANTA FE	1	
PRORATION OFFICE		
STATE LAND OFFICE	1	
U. S. G. S.	2	
TRANSPORTER		
FILE	1	
BUREAU OF MINES		