

NEW MEXICO OIL CONSERVATION COMMISSION
Santa Fe, New Mexico

REC'D JUN 20 1960
Form O-101
Revised (5/2/55)

NOTICE OF INTENTION TO DRILL

Notice must be given to the District Office of the Oil Conservation Commission and approval obtained before drilling or recompletion begins. If changes in the proposed plan are considered advisable, a copy of this notice showing such changes will be returned to the sender. Submit this notice in QUINTUPLICATE. One copy will be returned following approval. See additional instructions in Rules and Regulations of the Commission. If State Land submit 6 Copies Attach Form G-128 in triplicate to first 3 copies of form O-101

Hobbs, New Mexico

(Place)

June 20, 1960

(Date)

OIL CONSERVATION COMMISSION
SANTA FE, NEW MEXICO

Gentlemen:

You are hereby notified that it is our intention to commence the Drilling of a well to be known as

Pan American Petroleum Corporation

(Company or Operator)

State of New Mexico "BT"

(Lease)

Well No. 3, in 6 The well is

(Unit)

located 1954.48 feet from the West line and 971.95 feet from the

North line of Section 34, T. 17-S, R. 28-E, NMPM.

(GIVE LOCATION FROM SECTION LINE)

Pool, Hobbs County

If State Land the Oil and Gas Lease is No. E-7116

If patented land the owner is

Address

We propose to drill well with drilling equipment as follows: 8-70 with rotary tools.

The status of plugging bond is: Blanket bond on file with commission.

Drilling Contractor Parker Drilling Company

418 National Bank of Tulsa Building

Tulsa, Oklahoma

We intend to complete this well in the 6500

formation at an approximate depth of 6500 feet.

CASING PROGRAM

We propose to use the following strings of Casing and to cement them as indicated:

| Size of Hole | Size of Casing | Weight per Foot | New or Second Hand | Depth | Sacks Cement |
|--------------|----------------|-----------------|--------------------|-------|--------------|
| 11" | 8 5/8" | 22.7# | New | 800' | 550 * |
| 7 7/8" | 4 1/2" | 9.5# | New | 6500' | 850 ** |
| | | | | | |
| | | | | | |

If changes in the above plans become advisable we will notify you immediately.

ADDITIONAL INFORMATION (If recompletion give full details of proposed plan of work.)

* Sufficient cement to circulate

** Sufficient cement to tie into surface casing.

JUN 21 1960

Approved: _____, 19____
Except as follows:

OIL CONSERVATION COMMISSION

By: M. L. Armstrong

Sincerely yours,

Pan American Petroleum Corporation

Original Signed By (Company or Operator)

By: L. W. BROWN

Position: Area Superintendent

Send Communications regarding well to

Name: J. W. Brown

Address: Box 60, Hobbs, New Mexico

NEW MEXICO OIL CONSERVATION COMMISSION
WELL LOCATION AND ACREAGE DEDICATION PLAT

RECEIVED
JUN 20 1960
C-128
REV. 1/57

SEE INSTRUCTIONS FOR COMPLETING THIS FORM ON THE REVERSE SIDE

SECTION A

| | | | | |
|---|-----------------------------------|-------------------------------|---------------------------------------|-----------------------|
| Operator Pan American Pet. Corp | | Lease State of N.M. | | |
| Well Letter C | Section 34 | Township 17 south | Range 28 east | County Hddy |
| Actual Footage Location of Well: 1954.48 feet from the west line and 971.95 feet from the north line | | | | |
| Ground Level Elev. Not Yet Available | Producing Formation Abo | Pool Undesignated | Dedicated Acreage: 40 Acres | |

1. Is the Operator the only owner in the dedicated acreage outlined on the plat below? YES ☒ NO ☐ ("Owner" means the person who has the right to drill into and to produce from any pool and to appropriate the production either for himself or for himself and another. (65-3-29 (e) NMSA 1955 Comp.)
2. If the answer to question one is "no," have the interests of all the owners been consolidated by communitization agreement or otherwise? YES ☐ NO ☐ If answer is "yes," Type of Consolidation _____
3. If the answer to question two is "no," list all the owners and their respective interests below:

| Owner | Land Description |
|-------|------------------|
| | |
| | |

SECTION B

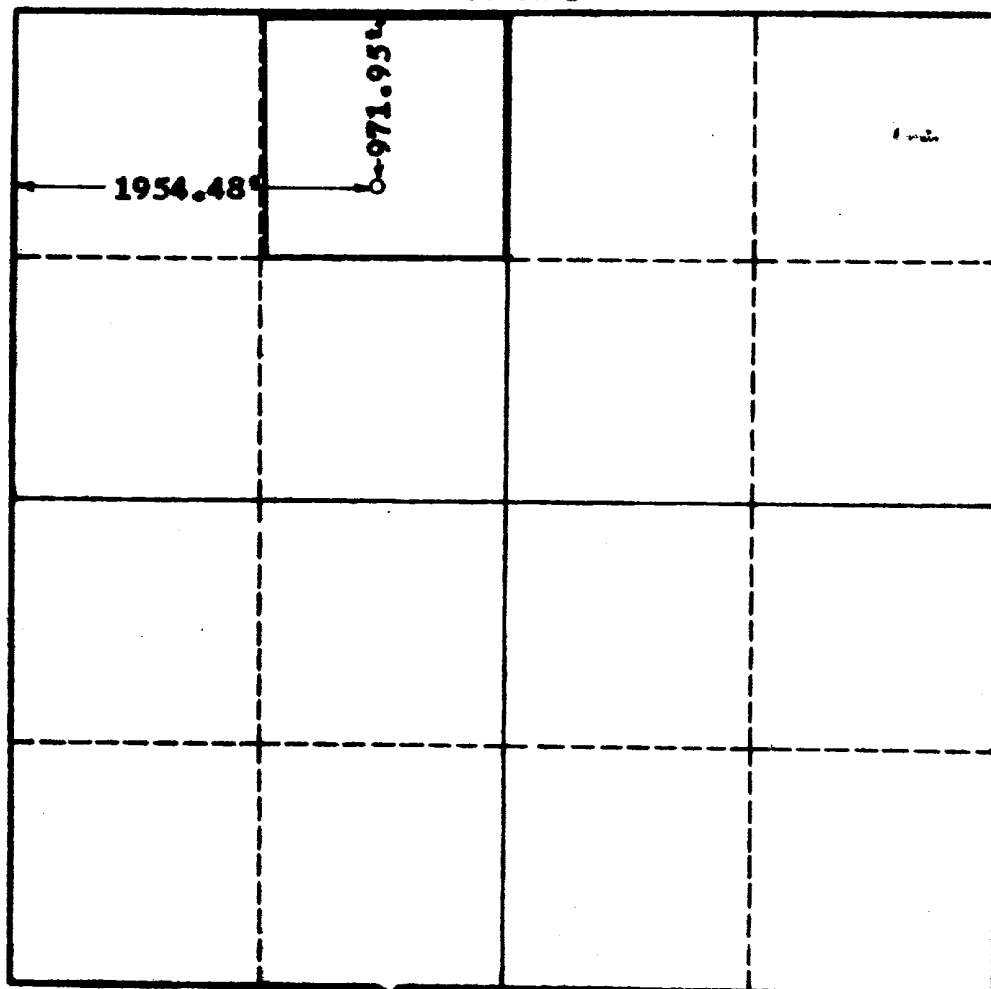

CERTIFICATION

I hereby certify that the information in SECTION A above is true and complete to the best of my knowledge and belief.

Name Original Signed by
L. W. BROWN

Position
Area Superintendent

Company
Pan American Petroleum Corp.

Date
June 20, 1960

I hereby certify that the well location shown on the plat in SECTION B was plotted from field notes of actual surveys made by me or under my supervision and the same is true and correct to the best of my knowledge and belief.

STATE OF NEW MEXICO
LAND SURVEYOR
No. 676
June 15, 1960
Registered Professional Engineer and/or Land Surveyor
L. W. WEST
Certificate No.
R.M. - P.E. & L.S. NO. 676

JOHN W. WEST ENGINEERING COMPANY

412 NORTH DAL PASS
HOBBS, NEW MEXICO

June 17, 1960

Pan American Pet. Corp.
Hobbs, New Mexico

Gentlemen:

On June 15, 1960, a survey was made to locate your No. 3 location on the State "BT" lease at a point 971.95 feet from the North line and 1954.48 feet from the West line of Section 34, Township 17 South, Range 28 East, N.M.P.M., Eddy county, New Mexico. Said well location is also described as being 330 feet from the South and 660 feet from the East lines of the NE $\frac{1}{4}$ NW $\frac{1}{4}$ of Section 34.

A flag was set up at the USGLO Section corner marker common to Sections 27, 28, 33 and 34, and the Transit was set up at the USGLO Quarter corner marker common to Sections 27 and 34. Thence chaining S89°23'W from the Transit a distance of 660 feet to a point, thence S0°42'E a distance of 971.95 feet to the location site of the State "BT" No. 3. As a check on our survey we chained from the location site S89°23'W a distance of 1954.48 feet to the West boundary line of Section 34, thence N0°42'W a distance of 975.95 feet to the Section corner common to Sections 27, 28, 33 and 34, checking in within the allowable error for this survey.

I hereby certify that the foregoing survey was made in the field under my supervision and that the same is true and correct to the best of my knowledge and belief.

Respectfully submitted,

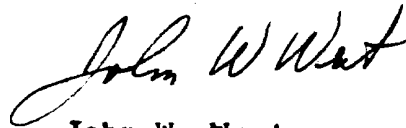

John W. West

| OIL CONSERVATION COMMISSION | | |
|-----------------------------|------------------|---|
| ARTESIA DISTRICT OFFICE | | |
| Date Received | | 6 |
| DISTRIBUTION | | |
| | NO. FURNISHED | |
| OPERATOR | 1 | |
| SANTA FE | 1 | |
| PRODUCTION OFFICE | | |
| STATE LAND OFFICE | 1 | |
| U. S. G. S. | 2 | |
| TRANSPORTER | | |
| FILE | 1 | ✓ |
| BUREAU OF MINES | | |
| | | |