

RECEIVED

NEW MEXICO OIL CONSERVATION COMMISSION
WELL LOCATION AND ACREAGE DEDICATION PLAT

MAY 2 1960
FORM C-128
Revised 5/1/57

SEE INSTRUCTIONS FOR COMPLETING THIS FORM ON THE REVERSE SIDE
SILVERTIA, OFFICE

Operator Hondo-Western-Yates				Lease		State A		Well No. 12	
Unit Letter F	Section 35	Township 17 South	Range 28 East	County Eddy					
Actual Footage Location of Well: 1650 feet from the North line and 1650 feet from the West line									
Ground Level Elev. 3681		Producing Formation aho		Pool Empire-Abo Undesig		Dedicated Acreage: 40 Acres			

1. Is the Operator the only owner in the dedicated acreage outlined on the plat below? YES ☒ NO ☐ . ("Owner" means the person who has the right to drill into and to produce from any pool and to appropriate the production either for himself or for himself and another. (65-3-29 (e) NMSA 1935 Comp.)
2. If the answer to question one is "no," have the interests of all the owners been consolidated by communitization agreement or otherwise? YES ☐ NO ☐ . If answer is "yes," Type of Consolidation _____
3. If the answer to question two is "no," list all the owners and their respective interests below:

Owner	Land Description

SECTION B

R 28 E

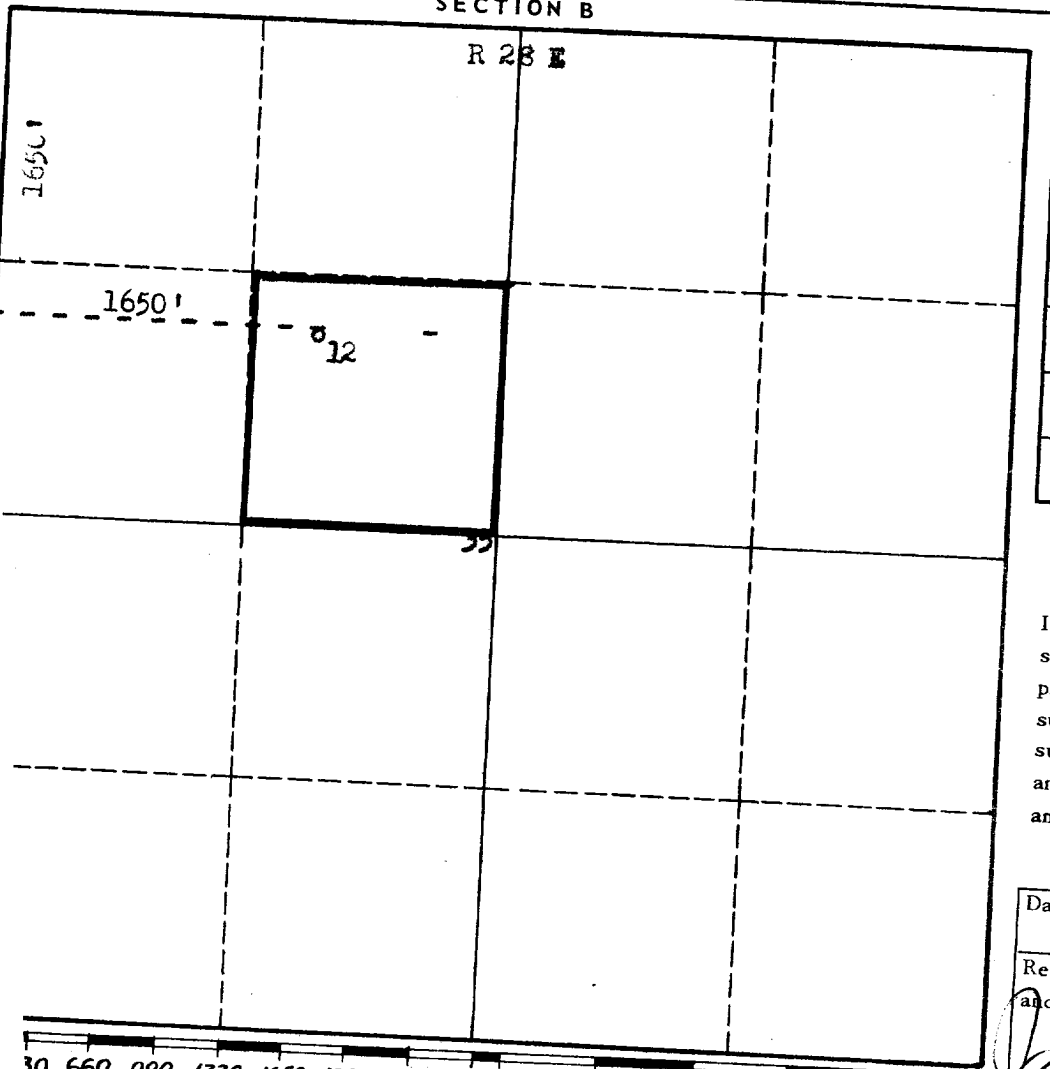

CERTIFICATION

I hereby certify that the information in SECTION A above is true and complete to the best of my knowledge and belief.

Name **A. J. Deane**
Position **Dist. Prod. Supt.**
Company **Hondo Oil & Gas Co.**
Date **4-29-60**

I hereby certify that the well location shown on the plat in SECTION B was plotted from field notes of actual surveys made by me or under my supervision, and that the same is true and correct to the best of my knowledge and belief.

Date Surveyed **April, 29th, 1960**
Registered Professional Engineer
and/or Land Surveyor

James H. Brown
Certificate No. **N.M.L.S. No. 542**

30 660 990 1320 1650 1980 2310 2640 2000 1500 1000 500 0

INSTRUCTIONS FOR COMPLETION OF FORM C-128

1. Operator shall furnish and certify to the information called for in Section A.
2. Operator shall outline the dedicated acreage for *both* oil and gas wells on the plat in Section B.
3. A registered professional engineer or land surveyor registered in the State of New Mexico or approved by the Commission shall show on the plat the location of the well and certify this information in the space provided.
4. All distances shown on the plat must be from the outer boundaries of the Section.
5. If additional space is needed for listing owners and their respective interests as required in question 3 of Section A, please use space below.

OIL CONSERVATION COMMISSION		
ALBUQUERQUE DISTRICT OFFICE		
No. Copies Received	10	
DISTRIBUTION		
	NO. COPIES	FILED
OPERATOR	5	
SANTA FE		
PROBATION OFFICE		
STATE LAND OFFICE	2	
U. S. G. S.		
TRANSPORTER		
FILE	1	1
BUREAU OF MINES		