

NEW MEXICO  
OIL CONSERVATION COMMISSION

Form C-128

Well Location and/or Gas Proration Plat

Date February 4, 1957

Operator Western-Yates Lease State 647

Well No. 138 Section 35 Township 17S Range 28E NMPM

Located 2310 Feet From south Line, 330 Feet From east Line,

Eddy County, New Mexico. G. L. Elevation 3661'

Name of Producing Formation \_\_\_\_\_ Pool Artesia Dedicated Acreage \_\_\_\_\_

(Note: All distances must be from outer boundaries of Section)

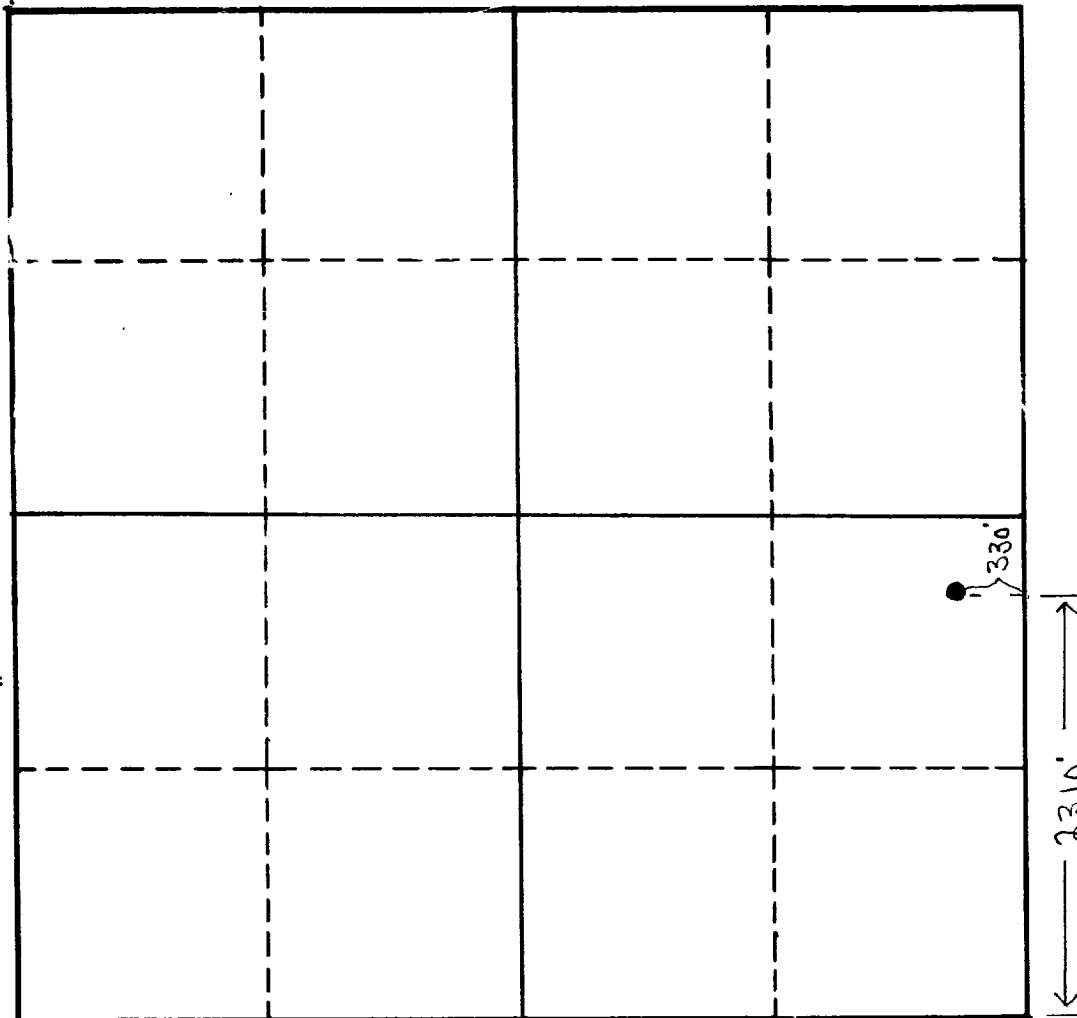

NOTE

This section of  
form is to be  
used for gas  
wells only.



SCALE: 1"=1000'

1. Is this Well a Dual Comp. ? Yes \_\_\_ No \_\_\_.
2. If the answer to Question 1 is yes, are there any other dually completed wells within the dedicated acreage ? Yes \_\_\_ No \_\_\_.

Name \_\_\_\_\_  
Position \_\_\_\_\_  
Representing \_\_\_\_\_  
Address \_\_\_\_\_

This is to certify that the above plat was prepared from field notes of actual surveys made by me or under my supervision and that the same are true and correct to the best of my knowledge and belief.

Date Surveyed Feb. 2, 1957  
W. B. Macey  
Registered Professional Engineer and/or  
Land Surveyor

Seal # 926

## 8 NOTICE OF INTENTION TO DRILL

Notice must be given to the District Office of the Oil Conservation Commission and approval obtained before drilling or recompletion begins. If changes in the proposed plan are considered advisable, a copy of this notice showing such changes will be returned to the sender. Submit this notice in **QUINTUPLICATE**. One copy will be returned following approval. See additional instructions in Rules and Regulations of the Commission. If State Land submit 6 Copies Attach Form G-128 in triplicate to first 3 copies of form G-101

Artesia, New Mexico  
(Place)

February 4, 1957  
(Date)

OIL CONSERVATION COMMISSION  
SANTA FE, NEW MEXICO

Gentlemen:

You are hereby notified that it is our intention to commence the **Drilling** of a well to be known as

Western-Yates

(Company or Operator)

State 647  
(Lease)

, Well No. 136, in I (Unit) The well is

located 2310 feet from the south line and 330 feet from the east line of Section 35, T. 17S, R. 28E, NMPM.

(GIVE LOCATION FROM SECTION LINE) Artesia Pool, Eddy County

If State Land the Oil and Gas Lease is No. 647

If patented land the owner is

Address

We propose to drill well with drilling equipment as follows: Air Rotary

The status of plugging bond is Blanket Bond

Drilling Contractor S. P. Yates Drlg. Co.  
Artesia, New Mexico

We intend to complete this well in the San Andres formation at an approximate depth of 2500 feet.

### CASING PROGRAM

We propose to use the following strings of Casing and to cement them as indicated:

Size of Hole	Size of Casing	Weight per Foot	New or Second Hand	Depth	Sacks Cement
<u>9 3/4"</u>	<u>7"</u>	<u>17#</u>	<u>new</u>	<u>600</u>	<u>75</u>
<u>6 1/4"</u>	<u>4 1/2"</u>	<u>9.50#</u>	<u>new</u>	<u>2500</u>	<u>150</u>

If changes in the above plans become advisable we will notify you immediately.

ADDITIONAL INFORMATION (If recompletion give full details of proposed plan of work.)

Approved Feb 6 1957, 19.....  
Except as follows:

Sincerely yours,

Western-Yates  
(Company or Operator)  
By P. A. Lanson

Position Dist. Supt.  
Send Communications regarding well to

Name Western-Yates

Address P.O. Box 445  
Artesia, New Mexico

OIL CONSERVATION COMMISSION

By M. L. Armstrong