

NEW MEXICO OIL CONSERVATION COMMISSION
Santa Fe, New Mexico

RECEIVED
Form C-101
Revised (12/1/55)

NOTICE OF INTENTION TO DRILL

MAR 23 1962

Notice must be given to the District Office of the Oil Conservation Commission and approval obtained before drilling or recompletion begins. If changes in the proposed plan are considered advisable, a copy of this notice showing such changes must be returned to the sender. Submit this notice in QUINTUPPLICATE. One copy will be returned following approval. See additional instructions in Rules and Regulations of the Commission. If State Land submit 6 Copies Attach Form C-128 in triplicate to first 3 copies of form C-101

Artesia, New Mexico
(Place)

March 20, 1962
(Date)

OIL CONSERVATION COMMISSION
SANTA FE, NEW MEXICO

Gentlemen:

You are hereby notified that it is our intention to commence the Drilling of a well to be known as

Western-Yates

(Company or Operator)

State 647

(Lease)

Well No. 186

in G

(Unit)

The well is

located 1980 feet from the

North

line and

1650

feet from the

East

line of Section 32

T. 17-S

R. 28-E

NMPM.

(GIVE LOCATION FROM SECTION LINE)

Artesia

Pool,

Eddy

County

If State Land the Oil and Gas Lease is No. 647

If patented land the owner is

Address

We propose to drill well with drilling equipment as follows: Cable tools

The status of plugging bond is Blanket bond

Drilling Contractor Unknown

We intend to complete this well in the Premier

formation at an approximate depth of 2,000 feet.

CASING PROGRAM

We propose to use the following strings of Casing and to cement them as indicated:

| Size of Hole | Size of Casing | Weight per Foot | New or Second Hand | Depth | Sacks Cement |
|--------------|----------------|-----------------|--------------------|-------|--------------|
| 10" | 8 5/8" | 24.00 | Used | 500 | 100 |
| 5" | 4 1/2" | 11.60 | New | 2,000 | 100 |
| | | | | | |
| | | | | | |

If changes in the above plans become advisable we will notify you immediately.

ADDITIONAL INFORMATION (If recompletion give full details of proposed plan of work.)

Approved _____, 19____
Except as follows:

Sincerely yours,

Western-Yates

(Company or Operator)

By

Position: Production Superintendent

Send Communications regarding well to

Name: Western-Yates

Address: P.O. Box 427, Artesia, New Mexico

OIL CONSERVATION COMMISSION

By

SANTA FE

FILE

U.S.G.S.

LAND OFFICE

TRANSPORTER

OIL

GAS

PRORATION OFFICE

OPERATOR

NEW MEXICO OIL CONSERVATION COMMISSION

FORM C-128
Revised 5/1/57

WELL LOCATION AND ACREAGE DEDICATION PLAT

SEE INSTRUCTIONS FOR COMPLETING THIS FORM ON THE REVERSE SIDE

RECEIVED
MAR 23 1962

SECTION A

Operator

WESTERN-YATES

Lease

State 647

ARTESIA, OFFENSE
186

Unit Letter

Section

Township

Range

County

G

32

T-17-S

R-28-E

Eddy

Actual Footage Location of Well:

1980

feet from the

North

line and

1650

feet from the

East

line

Ground Level Elev.

3691

Producing Formation

Premier

Pool

Artesia

Dedicated Acreage:

40

Acres

1. Is the Operator the only owner in the dedicated acreage outlined on the plat below? YES X NO ____ . ("Owner" means the person who has the right to drill into and to produce from any pool and to appropriate the production either for himself or for himself and another. (65-3-29 (e) NMSA 1935 Comp.)
2. If the answer to question one is "no," have the interests of all the owners been consolidated by communitization agreement or otherwise? YES ____ NO ____ . If answer is "yes," Type of Consolidation ____
3. If the answer to question two is "no," list all the owners and their respective interests below: RECEIVED

Owner

Land Description

MAR 23 1962

SECTION B

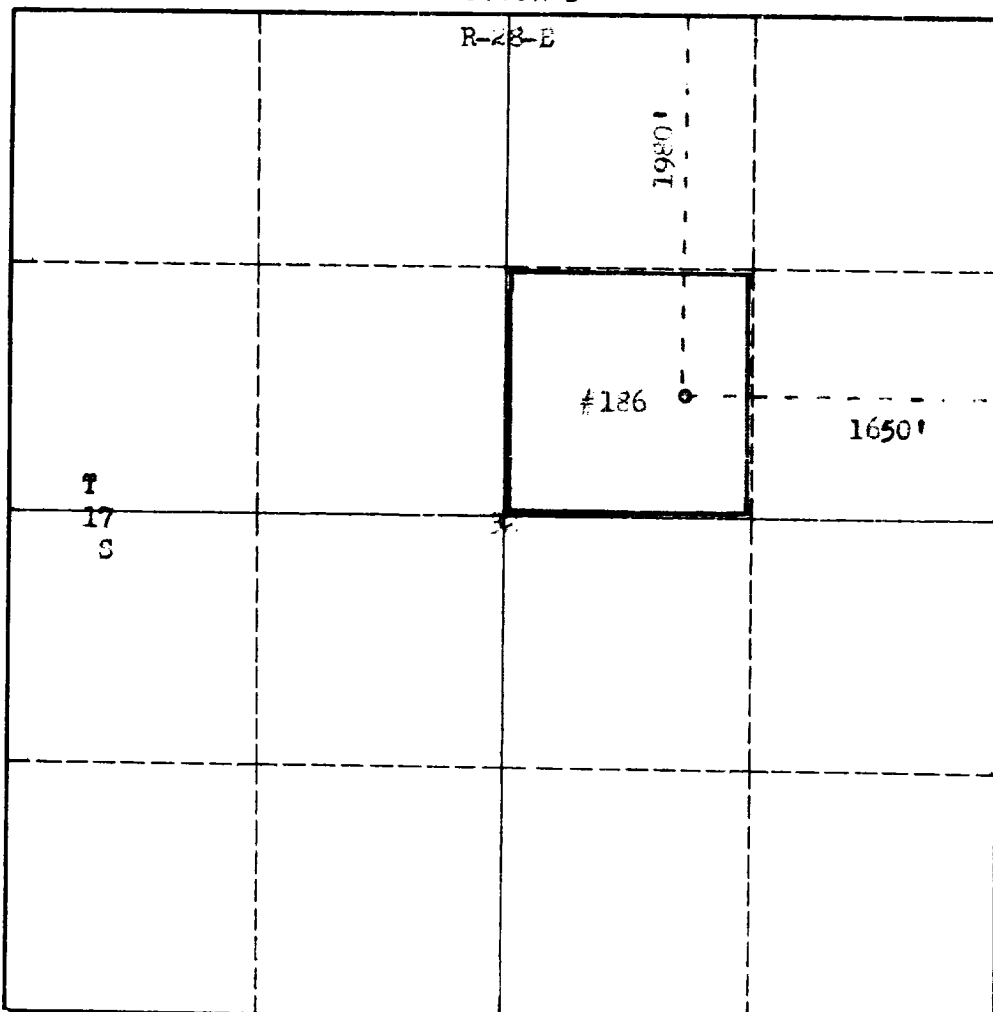

CERTIFICATION

I hereby certify that the information in SECTION A above is true and complete to the best of my knowledge and belief.

Name

Position

Production Superintendent

Company

Western-Yates

Date

March 22, 1962

I hereby certify that the well location shown on the plat in SECTION B was plotted from field notes of actual surveys made by me or under my supervision, and that the same is true and correct to the best of my knowledge and belief.

Date Surveyed

March 21, 1962

Registered Professional Engineer
and/or Land Surveyor

Certificate No.

3280

INSTRUCTIONS FOR COMPLETION OF FORM C-128

1. Operator shall furnish and certify to the information called for in Section A.
2. Operator shall outline the dedicated acreage for *both* oil and gas wells on the plat in Section B.
3. A registered professional engineer or land surveyor registered in the State of New Mexico or approved by the Commission shall show on the plat the location of the well and certify this information in the space provided.
4. All distances shown on the plat must be from the outer boundaries of the Section.
5. If additional space is needed for listing owners and their respective interests as required in question 3 of Section A, please use space below.

[illegible]