

N. M. O. C. C. PY

(SUBMIT IN TRIPLICATE)

UNITED STATES
DEPARTMENT OF THE INTERIOR
GEOLOGICAL SURVEY

Land Office Las Cruces
Lease No. 061632
Unit Farmer

30-015-07687
RECEIVED

SUNDRY NOTICES AND REPORTS ON WELLS

NOTICE OF INTENTION TO DRILL.....	<input checked="" type="checkbox"/> SUBSEQUENT REPORT OF WATER SHUT-OFF.....
NOTICE OF INTENTION TO CHANGE PLANS.....	SUBSEQUENT REPORT OF SHOOTING OR ACIDIZING.....
NOTICE OF INTENTION TO TEST WATER SHUT-OFF.....	SUBSEQUENT REPORT OF ALTERING CASING.....
NOTICE OF INTENTION TO RE-DRILL OR REPAIR WELL.....	SUBSEQUENT REPORT OF RE-DRILLING OR REPAIR.....
NOTICE OF INTENTION TO SHOOT OR ACIDIZE.....	SUBSEQUENT REPORT OF ABANDONMENT.....
NOTICE OF INTENTION TO PULL OR ALTER CASING.....	SUPPLEMENTARY WELL HISTORY.....
NOTICE OF INTENTION TO ABANDON WELL.....	

(INDICATE ABOVE BY CHECK MARK NATURE OF REPORT, NOTICE, OR OTHER DATA)

Loce Hills, New Mexico December 21, 1959

Well No. 2 is located 1690 ft. from N line and 990 ft. from E line of sec. 12

3-N-E-SE Sec. 12 1690 22-E N.M.P.M.
(1/4 Sec. and Sec. No.) (Twp.) (Range) (Meridian)
Undesignated Eddy New Mexico
(Field) (County or Subdivision) (State or Territory)

The elevation of the derrick floor above sea level is 3745 ft.

DETAILS OF WORK

(State names of and expected depths to objective sands; show sizes, weights, and lengths of proposed casings; indicate mudding jobs, cementing points, and all other important proposed work)

WE PROPOSE TO DRILL THE ABOVE WELL AS FOLLOWS:

OBJECTIVE: Penrose Sand (Queen)

TOTAL DEPTH: Approximately 2130'.

METHOD OF DRILLING: Cable tools to total depth.

CASING PROGRAM: Will run approximately 425' of 10 3/4" OD casing and obtain formation shut-off. Will run approximately 1950' of 8 5/8" OD casing and mud with Aquagel. If commercial production is indicated a production string of 7" OD casing will be run and cemented with 150 sacks. After fracturing well the 10 3/4" OD casing will be pulled and 50 sacks cement spotted above the top of the salt section.

DRILLING CONTRACTOR: Needham Drilling Company

DRILLING OPERATIONS TO COMMENCE: On or about December 24, 1959

I understand that this plan of work must receive approval in writing by the Geological Survey before operations may be commenced.

Company General American Oil Company of Texas

Address P. O. Box 416

Loce Hills, New Mexico

By

R. J. Heard

R. J. Heard

Title

District Superintendent

NEW MEXICO OIL CONSERVATION COMMISSION
WELL LOCATION AND ACREAGE DEDICATION PLAT

FORM C-128
 Revised 5/1/57

SEE INSTRUCTIONS FOR COMPLETING THIS FORM ON THE REVERSE SIDE

SECTION A

Operator General American Oil Co. Of Texas			Lease Farmer		Well No. 2
Unit Letter I	Section 12	Township 16 South	Range 29 East	County Eddy County	
Actual Footage Location of Well: 1650 feet from the South line and 990 feet from the East line					
Ground Level Elev. 3743.55	Producing Formation Panrose Sand (Quana)		Pool Undesignated		Dedicated Acreage: 40 Acres

1. Is the Operator the only owner in the dedicated acreage outlined on the plat below? YES ☒ NO ____ . ("Owner" means the person who has the right to drill into and to produce from any pool and to appropriate the production either for himself or for himself and another. (65-3-29 (e) NMSA 1935 Comp.)
2. If the answer to question one is "no," have the interests of all the owners been consolidated by communitization agreement or otherwise? YES ____ NO ____ . If answer is "yes," Type of Consolidation ____
3. If the answer to question two is "no," list all the owners and their respective interests below:

Owner	Land Description

RECEIVED
DEC 22 1959
 STATE SURVEY
 ALBUQUERQUE, NEW MEXICO

SECTION B

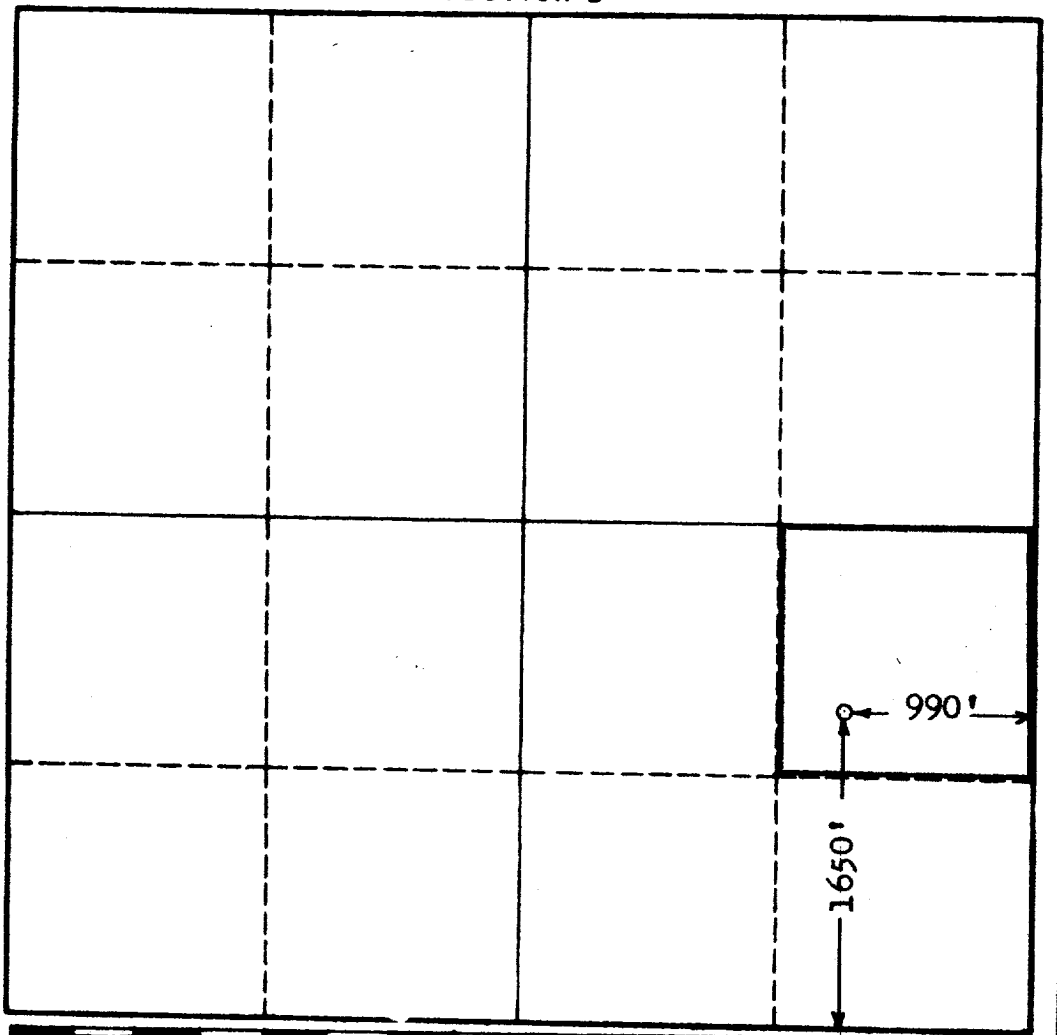

CERTIFICATION

I hereby certify that the information in SECTION A above is true and complete to the best of my knowledge and belief.

Name R. J. Heard
Position District Superintendent
Company Gen. Amer. Oil Co of Texas
Date 12-21-59

I hereby certify that the well location shown on the plat in SECTION B was plotted from field notes of actual surveys made by me or under my supervision, and that the same is true and correct to the best of my knowledge and belief.

Date Surveyed 12-18-59
Registered Professional Engineer and/or Land Surveyor, JOHN W. WEST
Certificate No. John W. West
N. M. - P. E. & L. S. NO. 676

0 330 660 990 1320 1650 1980 2310 2640 2000 1500 1000 500 0