

Copy 65 F

NEW MEXICO OIL CONSERVATION COMMISSION
WELL LOCATION AND ACREAGE DEDICATION PLAT

FORM C-120
Revised 5/1/57

SEE INSTRUCTIONS FOR COMPLETING THIS FORM ON THE REVERSE SIDE

SECTION A

Operator General American Oil Co. Of Texas			Lease Farmer		Well No. 2
Unit Letter I	Section 12	Township 16 South	Range 29 East	County Eddy County	
Actual Footage Location of Well: 1650 feet from the South line and 990 feet from the East line					
Ground Level Elev. 3743.55	Producing Formation Panhandle <i>Premier</i>		Pool <i>Undesignated</i>	Dedicated Acreage: <i>40</i> Acres	

1. Is the Operator the only owner in the dedicated acreage outlined on the plat below? YES ☒ NO ☐ ("Owner" means the person who has the right to drill into and to produce from any pool and to appropriate the production either for himself or for himself and another. (65-3-29 (e) NMSA 1935 Comp.)
2. If the answer to question one is "no," have the interests of all the owners been consolidated by communitization agreement or otherwise? YES ☐ NO ☐ If answer is "yes," Type of Consolidation _____
3. If the answer to question two is "no," list all the owners and their respective interests below:

Owner	Land Description
	DEC 2 2 1959

SECTION B

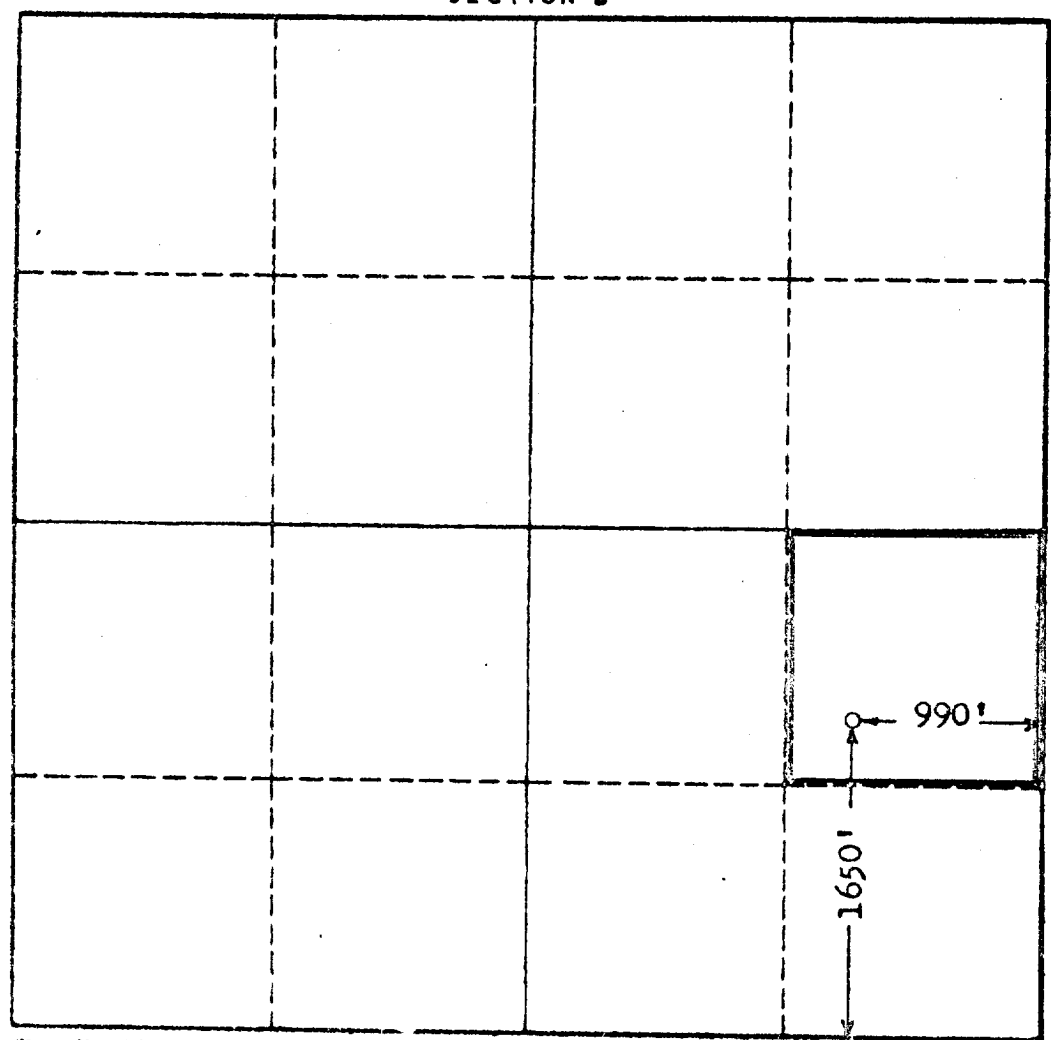

CERTIFICATION

I hereby certify that the information in SECTION A above is true and complete to the best of my knowledge and belief.

R. J. Heard
Name
R. J. Heard
Position
District Superintendent
Company
Gen. Amer. Oil Co. of Texas
Date
12-21-59

I hereby certify that the well location shown on the plat in SECTION B was plotted from field notes of actual surveys made by me or under my supervision, and that the same is true and correct to the best of my knowledge and belief.

Date Surveyed
12-18-59

Registered Professional Engineer and/or Land Surveyor, JOHN W. WEST

John W. West
Certificate No.
N.M. - P.E. & L.S. NO. 676

