

COPY TO O. C. C.  
(SUBMIT IN TRIPLICATE)Land Office Las Cruces  
Lease No. 067610-A  
Unit BasinUNITED STATES  
DEPARTMENT OF THE INTERIOR  
GEOLOGICAL SURVEY

30-015-02702

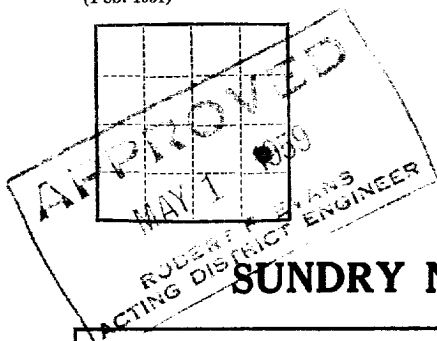

## SUNDRY NOTICES AND REPORTS ON WELLS

NOTICE OF INTENTION TO DRILL.....	<input checked="" type="checkbox"/>	SUBSEQUENT REPORT OF WATER SHUT-OFF.....	
NOTICE OF INTENTION TO CHANGE PLANS.....		SUBSEQUENT REPORT OF SHOOTING OR ACIDIZING.....	
NOTICE OF INTENTION TO TEST WATER SHUT-OFF.....		SUBSEQUENT REPORT OF ALTERING CASING.....	
NOTICE OF INTENTION TO RE-DRILL OR REPAIR WELL.....		SUBSEQUENT REPORT OF RE-DRILLING OR REPAIR.....	
NOTICE OF INTENTION TO SHOOT OR ACIDIZE.....		SUBSEQUENT REPORT OF ABANDONMENT.....	
NOTICE OF INTENTION TO PULL OR ALTER CASING.....		SUPPLEMENTARY WELL HISTORY.....	
NOTICE OF INTENTION TO ABANDON WELL.....			

(INDICATE ABOVE BY CHECK MARK NATURE OF REPORT, NOTICE, OR OTHER DATA)

Leco Hills, New Mexico April 27, 1959

Well No. 1 is located 1980 ft. from S line and 660 ft. from E line of sec. 14

NE 36 SEC 14 (1/4 Sec. and Sec. No.) 16-S (Twp.) 29-S (Range) R.M.P.M. (Meridian)  
UNDESIGNATED (Field) KODY (County or Subdivision) NEW MEXICO (State or Territory)

The elevation of the derrick floor above sea level is 7 ft.

## DETAILS OF WORK

(State names of and expected depths to objective sands; show sizes, weights, and lengths of proposed casings; indicate mudding jobs, cementing points, and all other important proposed work)

WE PROPOSE TO DRILL THIS WELL AS FOLLOWS:

OBJECTIVE: Panrose Sand (Queen)TOTAL DEPTH: Approximately 2120'.METHOD OF DRILLING: Cable tools to total depth.CASING PROGRAM: Will run approximately 425' of 10 3/4" OD casing and obtain formation shut-off. If surface water is encountered in sufficient quantities, will cement 10 3/4" with 50 sacks. If water is encountered in the Red Sand section of the Queen formation will run approximately 1950' of 8 5/8" OD casing and mud with Aquagel and crude oil. If commercial production is indicated a production string of 7" OD casing will be run and cemented immediately above the pay horizon.DRILLING CONTRACTOR: Needham Drilling CompanyDRILLING OPERATIONS TO COMMENCE: On or about May 2, 1959.

I understand that this plan of work must receive approval in writing by the Geological Survey before operations may be commenced.

Company GENERAL AMERICAN OIL COMPANY OF TEXASAddress P. O. Box 416Leco Hills, N. M.By R. J. Heard  
R. J. HeardTitle District Superintendent

NEW MEXICO OIL CONSERVATION COMMISSION  
Well Location and Acreage Dedication Plat

Section A.

Date March 18, 1960

Operator General American Oil Co. Lease Hosworth  
Well No. 1 Unit Letter I Section 14 Township 16 N Range 29 E NMPM  
Located 1920 Feet From 3 Line, 660 Feet From 2 Line  
County Eddy G. L. Elevation \_\_\_\_\_ Dedicated Acreage 40 Acres  
Name of Producing Formation Perrose Pool \_\_\_\_\_

1. Is the Operator the only owner\* in the dedicated acreage outlined on the plat below?  
Yes X No \_\_\_\_\_.
2. If the answer to question one is "no," have the interests of all the owners been consolidated by communitization agreement or otherwise? Yes \_\_\_\_\_ No \_\_\_\_\_. If answer is "yes," Type of Consolidation \_\_\_\_\_
3. If the answer to question two is "no," list all the owners and their respective interests below:

Owner

Land Description

<u>Owner</u>	<u>Land Description</u>

Section B

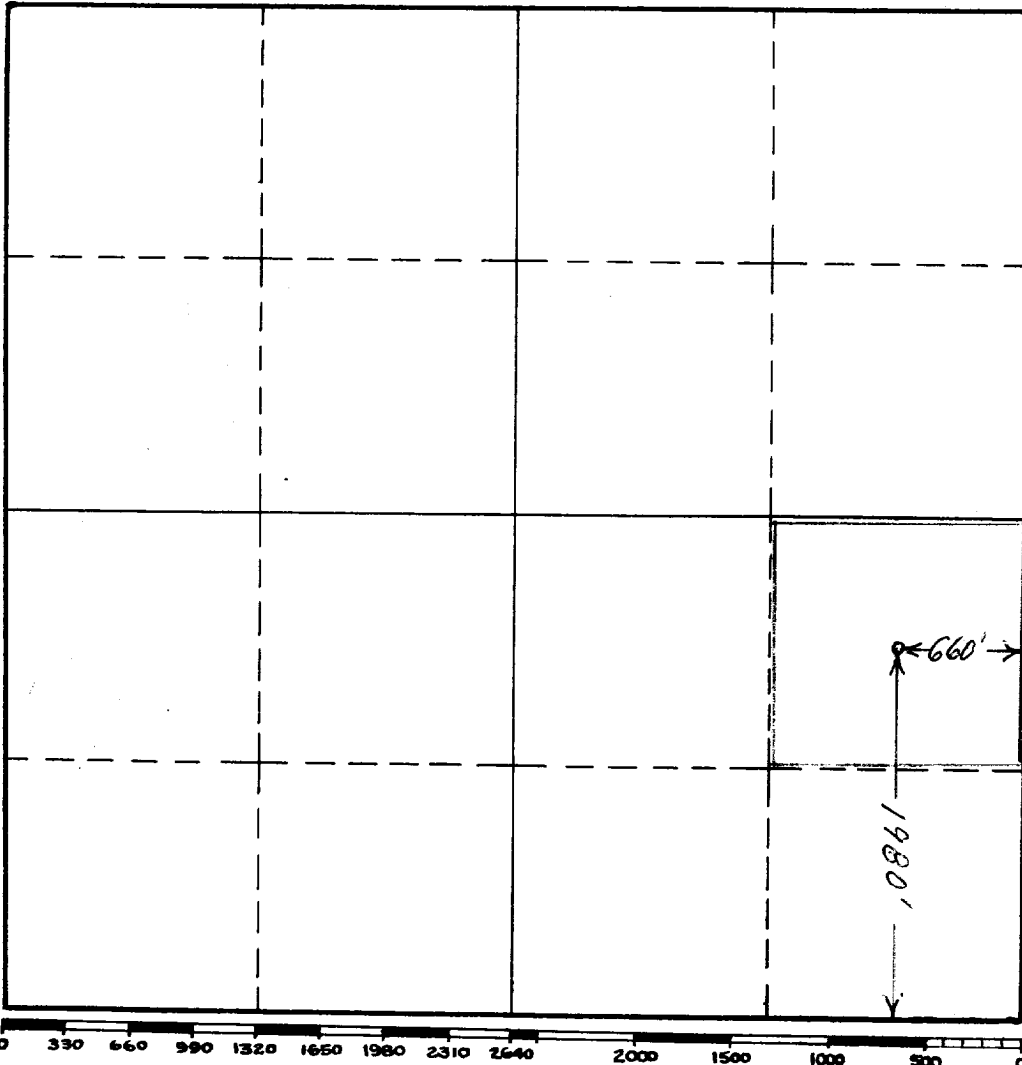

This is to certify that the information in Section A above is true and complete to the best of my knowledge and belief.

General American Oil Co.  
(Operator)

\_\_\_\_\_  
(Representative)

Loco Billa, E. M.  
Address

This is to certify that the well location shown on the plat in Section B was plotted from field notes of actual surveys made by me or under my supervision and that the same is true and correct to the best of my knowledge and belief.

Date Surveyed 3/17/60

W. P. Sheldon  
Registered Professional  
Engineer and/or Land Surveyor.

Certificate No. 963

(See instructions for completing this form on the reverse side)