

NEW MEXICO OIL CONSERVATION COMMISSION  
WELL LOCATION AND ACREAGE DEDICATION PLAT

FORM C-128  
Revised 5/1/57  
1959

SEE INSTRUCTIONS FOR COMPLETING THIS FORM ON THE REVERSE SIDE

SECTION A

Operator <b>General American Oil Co. of Texas</b>		Lease <b>Bosworth</b>		Well No. <b>3</b>	
Unit Letter <b>O</b>	Section <b>14</b>	Township <b>16 south</b>	Range <b>29 east</b>	County <b>Eddy</b>	
Actual Footage Location of Well: <b>990</b> feet from the <b>south</b> line and <b>2310</b> feet from the <b>east</b> line					
Ground Level Elev. <b>3702.7</b>	Producing Formation <b>Penrose (Queen)</b>		Pool <b>High Lonesome</b>	Dedicated Acreage: <b>40</b> Acres	

1. Is the Operator the only owner in the dedicated acreage outlined on the plat below? YES ☒ NO \_\_\_\_ ("Owner" means the person who has the right to drill into and to produce from any pool and to appropriate the production either for himself or for himself and another. (65-3-29 (e) NMSA 1935 Comp.)
2. If the answer to question one is "no," have the interests of all the owners been consolidated by communitization agreement or otherwise? YES \_\_\_\_ NO \_\_\_\_ . If answer is "yes," Type of Consolidation \_\_\_\_
3. If the answer to question two is "no," list all the owners and their respective interests below:

Owner	Land Description

SECTION B

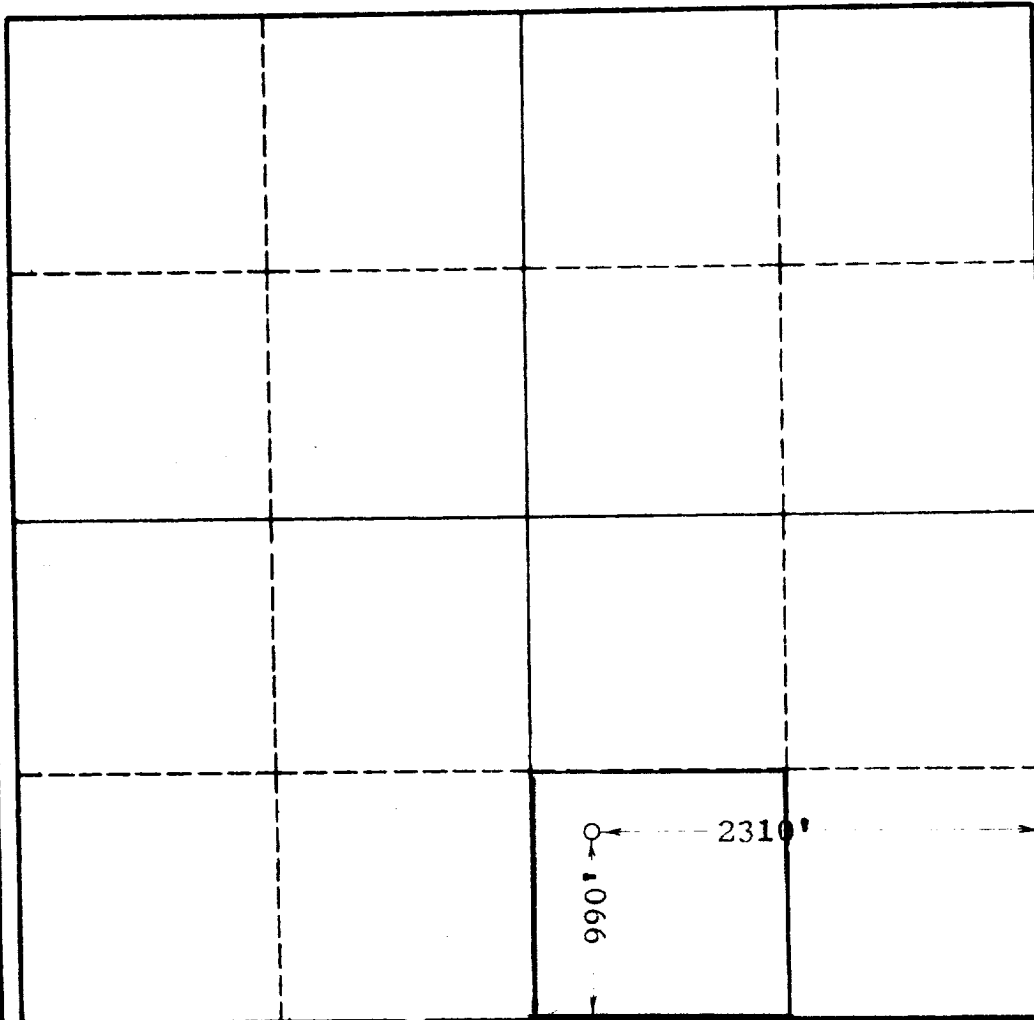

CERTIFICATION

I hereby certify that the information in SECTION A above is true and complete to the best of my knowledge and belief.

Name **R. J. Heard**  
Position **District Supt.**  
Company **Gen. Amer. Oil Co of Tex.**  
Date **11-23-59**

I hereby certify that the well location shown on the plat in SECTION B was plotted from field notes of actual surveys made by me or under my supervision, and that the same is true and correct to the best of my knowledge and belief.

Date Surveyed **11-20-59**  
Registered Professional Engineer and/or Land Surveyor **JOHN W. WEST**  
Certificate No. **Colm West**  
(N. M. - P. E. & L. S. NO. 676)

Copy 20 10/1/59

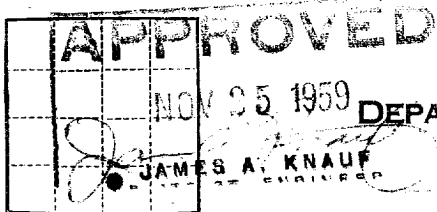

(SUBMIT IN TRIPLICATE)

UNITED STATES  
DEPARTMENT OF THE INTERIOR  
GEOLOGICAL SURVEY

Land Office Las Cruces  
Lease No. 067610-A  
Unit Socorro

30-015-02704

SUNDRY NOTICES AND REPORTS ON WELLS

NOTICE OF INTENTION TO DRILL	<input checked="" type="checkbox"/>	SUBSEQUENT REPORT OF WATER SHUT-OFF	
NOTICE OF INTENTION TO CHANGE PLANS		SUBSEQUENT REPORT OF SHOOTING OR ACIDIZING	
NOTICE OF INTENTION TO TEST WATER SHUT-OFF		SUBSEQUENT REPORT OF ALTERING CASING	
NOTICE OF INTENTION TO RE-DRILL OR REPAIR WELL		SUBSEQUENT REPORT OF RE-DRILLING OR REPAIR	
NOTICE OF INTENTION TO SHOOT OR ACIDIZE		SUBSEQUENT REPORT OF ABANDONMENT	
NOTICE OF INTENTION TO PULL OR ALTER CASING		SUPPLEMENTARY WELL HISTORY	
NOTICE OF INTENTION TO ABANDON WELL			

(INDICATE ABOVE BY CHECK MARK NATURE OF REPORT, NOTICE, OR OTHER DATA)

Loco Mills, New Mexico November 23, 1959

Well No. 3 is located 990 ft. from N line and 2310 ft. from E line of sec. 14  
16-S 29-E N.M.P.M.  
 (1/4 Sec. and Sec. No.) (Twp.) (Range) (Meridian)  
High Lonesome Eddy New Mexico  
 (Field) (County or Subdivision) (State or Territory)

The elevation of the derrick floor above sea level is 3704 ft.

DETAILS OF WORK

(State names of and expected depths to objective sands; show sizes, weights, and lengths of proposed casings; indicate mudding jobs, cementing points, and all other important proposed work)

WE PROPOSE TO DRILL THE ABOVE WELL AS FOLLOWS:

OBJECTIVE: Penrose Sand (Queen)

TOTAL DEPTH: Approximately 2065'.

METHOD OF DRILLING: Cable Tools to total depth.

CASING PROGRAM: Will run approximately 400' of 10 3/4" OD casing and obtain formation shut-off. Will run approximately 1840' of 8 5/8" OD casing and mud with Aquagel. If commercial production is indicated a production string of 7" OD casing will be run and cemented with 150 sacks. After fracturing well the 10 3/4" OD casing will be pulled and 50 sacks cement spotted above the top of salt section.

DRILLING CONTRACTOR: Needham Drilling Company

DRILLING OPERATIONS TO COMMENCE: On or about November 26, 1959.

I understand that this plan of work must receive approval in writing by the Geological Survey before operations may be commenced.

Company General American Oil Company of Texas

Address P. O. Box 416  
Loco Mills, New Mexico

By R. J. Heard  
R. J. Heard  
 Title District Superintendent