

APPROVED
OCT 15 1958
JOHN A. FROST DISTRICT ENGINEER

UNITED STATES  
DEPARTMENT OF THE INTERIOR  
GEOLOGICAL SURVEY

Land Office Las Cruces  
Lease No. 061638  
Unit Brewer

30-015-02707

## SUNDRY NOTICES AND REPORTS ON WELLS

NOTICE OF INTENTION TO DRILL	<input checked="" type="checkbox"/>	SUBSEQUENT REPORT OF WATER SHUT-OFF	
NOTICE OF INTENTION TO CHANGE PLANS		SUBSEQUENT REPORT OF SHOOTING OR ACIDIZING	
NOTICE OF INTENTION TO TEST WATER SHUT-OFF		SUBSEQUENT REPORT OF ALTERING CASING	
NOTICE OF INTENTION TO RE-DRILL OR REPAIR WELL		SUBSEQUENT REPORT OF RE-DRILLING OR REPAIR	
NOTICE OF INTENTION TO SHOOT OR ACIDIZE		SUBSEQUENT REPORT OF ABANDONMENT	
NOTICE OF INTENTION TO PULL OR ALTER CASING		SUPPLEMENTARY WELL HISTORY	
NOTICE OF INTENTION TO ABANDON WELL			

(INDICATE ABOVE BY CHECK MARK NATURE OF REPORT, NOTICE, OR OTHER DATA)

Loco Hills, New Mexico October, 19 58

Well No. 3 is located 660 ft. from N line and 1980 ft. from E line of sec. 14

NE 1/4 NE 1/4 Sec. 14 16-S 29-E N.M.P.M.  
(1/4 Sec. and Sec. No.) (Twp.) (Range) (Meridian)

Undesignated Eddy New Mexico  
(Field) (County or Subdivision) (State or Territory)

The elevation of the derrick floor above sea level is 3733 ft.

### DETAILS OF WORK

(State names of and expected depths to objective sands; show sizes, weights, and lengths of proposed casings; indicate mudding jobs, cementing points, and all other important proposed work)

**WE PROPOSE TO DRILL THIS WELL AS FOLLOWS:**

**OBJECTIVE:** Penrose Sand (Queen).

**TOTAL DEPTH:** Approximately 2065'.

**METHOD OF DRILLING:** Cable tools to total depth.

**CASING PROGRAM:** Will run approximately 400' of 10 3/4" OD casing and obtain formation shut-off. If surface water is encountered in sufficient quantities, will cement 10 3/4" with 50 sacks. If water is encountered in the Red Sand Section of Queen formation will run approximately 1850' of 8 5/8" OD casing and mud with Avangel and crude oil. If commercial production is indicated a production string of 7" OD casing will be run and cemented immediately above the indicated pay horizon.

**DRILLING CONTRACTOR:** Needham Drilling Company

**DRILLING OPERATIONS TO COMMENCE:** On or about October 18, 1958

I understand that this plan of work must receive approval in writing by the Geological Survey before operations may be commenced.

Company General American Oil Company of Texas

Address P. O. Box 416

Loco Hills, N. M.

By R. J. Heard  
R. J. Heard  
Title District Superintendent

NEW MEXICO OIL CONSERVATION COMMISSION

Well Location and Acreage Dedication Plat

Section A.

Date October 7, 1958

Operator General American Oil Co. of Texas Lease Brewer  
Well No. 3 Unit Letter B Section 14 Township 100 Range 29E NMPM  
Located 800 Feet From N Line, 1980 Feet From E Line  
County Sady G. L. Elevation 3231 Dedicated Acreage 40 Acres  
Name of Producing Formation Penrose Pool Undesignated

1. Is the Operator the only owner\* in the dedicated acreage outlined on the plat below?  
Yes  No .
2. If the answer to question one is "no," have the interests of all the owners been consolidated by communitization agreement or otherwise? Yes  No . If answer is "yes," Type of Consolidation \_\_\_\_\_
3. If the answer to question two is "no," list all the owners and their respective interests below:

Owner

Land Description

<u>Owner</u>	<u>Land Description</u>

Section B

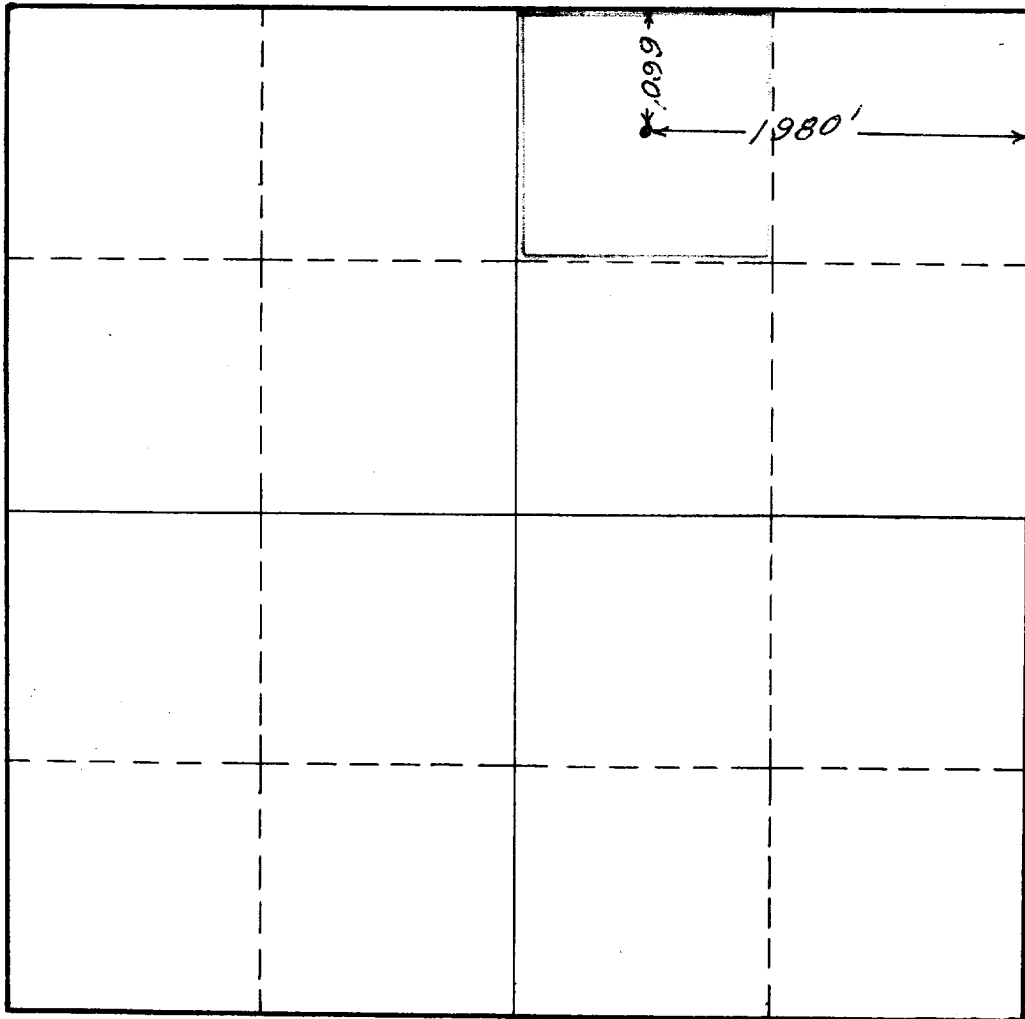

This is to certify that the information in Section A above is true and complete to the best of my knowledge and belief.

General American Oil Co  
of Texas  
(Operator)

(Representative)

Loco Hills, New Mexico  
Address

This is to certify that the well location shown on the plat in Section B was plotted from field notes of actual surveys made by me or under my supervision and that the same is true and correct to the best of my knowledge and belief.

Date Surveyed Oct. 4, 1958

V. P. Sheldon  
Registered Professional  
Engineer and/or Land Surveyor.



Certificate No. 963

(See instructions for completing this form on the reverse side)