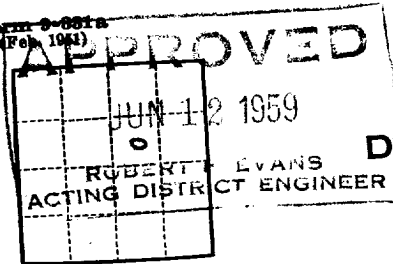

Land Office **New Mexico**Lease No. **05523**

Unit

Form 9-681a
(Feb. 1941)

(SUBMIT IN TRIPLICATE)

**UNITED STATES
DEPARTMENT OF THE INTERIOR
GEOLOGICAL SURVEY**

JUN 18 1959

30-015-02728

SUNDRY NOTICES AND REPORTS ON WELLS

NOTICE OF INTENTION TO DRILL	XX	SUBSEQUENT REPORT OF WATER SHUT-OFF	
NOTICE OF INTENTION TO CHANGE PLANS		SUBSEQUENT REPORT OF SHOOTING OR ACIDIZING	
NOTICE OF INTENTION TO TEST WATER SHUT-OFF		SUBSEQUENT REPORT OF ALTERING CASING	
NOTICE OF INTENTION TO RE-DRILL OR REPAIR WELL		SUBSEQUENT REPORT OF RE-DRILLING OR REPAIR	
NOTICE OF INTENTION TO SHOOT OR ACIDIZE		SUBSEQUENT REPORT OF ABANDONMENT	
NOTICE OF INTENTION TO PULL OR ALTER CASING		SUPPLEMENTARY WELL HISTORY	
NOTICE OF INTENTION TO ABANDON WELL			

(INDICATE ABOVE BY CHECK MARK NATURE OF REPORT, NOTICE, OR OTHER DATA)

June 12, 1959

Mc Callister Fed.Well No. **2** is located **1980** ft. from **(N)** line and **1980** ft. from **(E)** line of sec. **15****SW 1/4 NE 1/4 Sec. 15**
(1/4 Sec. and Sec. No.)**16 S**
(Twp.)**29 E**
(Range)**NM PM**
(Meridian)**High Lonesome**
(Field)**Eddy**

(County or Subdivision)

New Mexico
(State or Territory)The elevation of the derrick floor above sea level is _____ ft. **Will report later.**

DETAILS OF WORK

(State names of and expected depths to objective sands; show sizes, weights, and lengths of proposed casings; indicate casing joints, cementing points, and all other important proposed work)

We propose to drill on the above captioned location to approximately 2000 feet and complete this well in the Penrose sand. If production is not obtained in the Penrose sand we will drill to the San Andres lime. We will run 8 5/8" surface casing to approximately 425' and cement with 50 sacks neat cement; run 1800' of 7" casing to shut off red sand water; run 5 1/2" 14 lbs. per ft. new seamless casing to approximately 1950' for production string and cement with 100 sacks cement. We will pull 7" before cementing 5 1/2" casing.

I understand that this plan of work must receive approval in writing by the Geological Survey before operations may be commenced.

Company **Western Development Company of Delaware**Address **P. O. Box 427****Artesia, New Mexico**

By

Title

Vice President

NEW MEXICO OIL CONSERVATION COMMISSION
Well Location and Acreage Dedication Plat

Section A.

Date June 12, 1959

Operator Western Development Co. of Del. Lease Mc Callister Federal
Well No. 2 Unit Letter G Section 15 Township 16 S Range 29 E NMPM
Located 1980 Feet From North Line, 1980 Feet From East Line
County Eddy G. L. Elevation _____ Dedicated Acreage 40 Acres
Name of Producing Formation Pearose Sand Pool High Lonesome

1. Is the Operator the only owner* in the dedicated acreage outlined on the plat below?
Yes XXX No _____.
2. If the answer to question one is "no," have the interests of all the owners been consolidated by communitization agreement or otherwise? Yes _____ No _____. If answer is "yes," Type of Consolidation _____
3. If the answer to question two is "no," list all the owners and their respective interests below:

Owner

Land Description

RECEIVED
JUN 12 1959
U. S. DEPT. OF THE INTERIOR
ARTESIA, NEW MEXICO

Section B

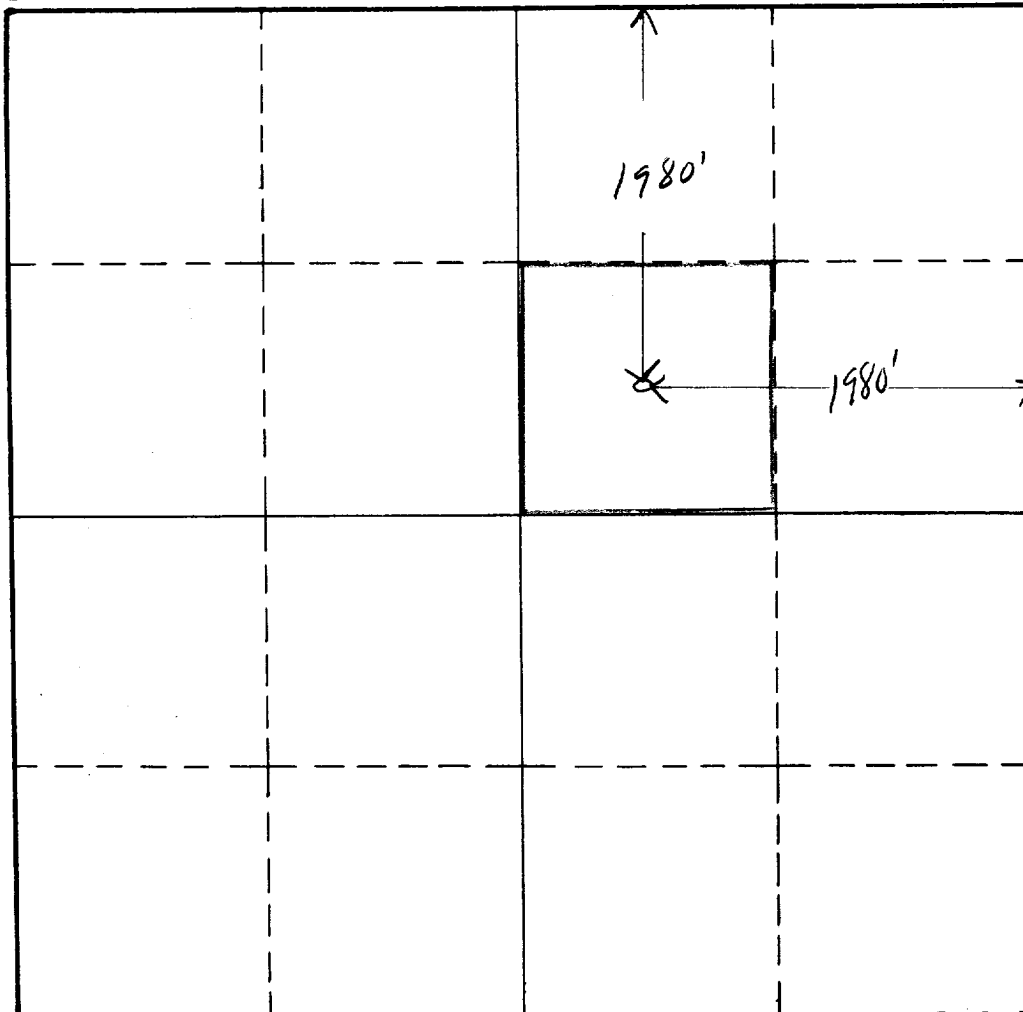

This is to certify that the information in Section A above is true and complete to the best of my knowledge and belief.

Western Development Co. of Del.
(Operator)
W. B. Macey
(Representative) Vice Pres.
P.O. Box 427, Artesia, N.M.
Address

This is to certify that the well location shown on the plat in Section B was plotted from field notes of actual surveys made by me or under my supervision and that the same is true and correct to the best of my knowledge and belief.

Date Surveyed 5-3-59

W. B. Macey
Registered Professional
Engineer and/or Land Surveyor.

Certificate No. 926

(See instructions for completing this form on the reverse side)