

Section 26

(SUBMIT IN TRIPLICATE)

Land Office Santa Fe
Lease No. NH-0916
Unit Simmons FederalUNITED STATES
DEPARTMENT OF THE INTERIOR
GEOLOGICAL SURVEY

30-015-02773

SUNDRY NOTICES AND REPORTS ON WELLS

NOTICE OF INTENTION TO DRILL.....	<input checked="" type="checkbox"/>	SUBSEQUENT REPORT OF WATER SHUT-OFF.....	
NOTICE OF INTENTION TO CHANGE PLANS.....		SUBSEQUENT REPORT OF SHOOTING OR ACIDIZING.....	
NOTICE OF INTENTION TO TEST WATER SHUT-OFF.....		SUBSEQUENT REPORT OF ALTERING CASING.....	
NOTICE OF INTENTION TO RE-DRILL OR REPAIR WELL.....		SUBSEQUENT REPORT OF RE-DRILLING OR REPAIR.....	
NOTICE OF INTENTION TO SHOOT OR ACIDIZE.....		SUBSEQUENT REPORT OF ABANDONMENT.....	
NOTICE OF INTENTION TO PULL OR ALTER CASING.....		SUPPLEMENTARY WELL HISTORY.....	
NOTICE OF INTENTION TO ABANDON WELL.....			

(INDICATE ABOVE BY CHECK MARK NATURE OF REPORT, NOTICE, OR OTHER DATA)

July 22, 1958

Well No. 2 is located 330 ft. from [S] line and 330 ft. from [E] line of sec. 26SE 1/4 Sec. 26 (1/4 Sec. and Sec. No.) 16-S (Twp.) 29-E (Range) N.M.P.M. (Meridian)Forest (Field) Eddy (County or Subdivision) New Mexico (State or Territory)The elevation of the derrick floor above sea level is 3704.6 ft. EST

DETAILS OF WORK

(State names of and expected depths to objective sands; show sizes, weights, and lengths of proposed casings; indicate mudding jobs, cementing points, and all other important proposed work)

We propose to drill the above well to a total depth of 2700' with cable tools.
We propose to test the following zone at the following approximate depth.SandExpected TopPremier2530U. S. GEOLOGICAL SURVEY
ARTESIA, NEW MEXICOWe expect to test any other zone that appear productive of oil and gas.
CASING PROGRAM Propose to set approx. 425' of 10 3/4" Surface csg. with approx. 300 sks. cement. To set approx. 2000' of 7 5/8" Intermediate csg. with approx. 100 sks. cement. To set approx. 800' of 5 1/2" liner with approx. 100 sks. cement.
We propose to perforate and sand oil frac the Premier Sand Zone for completion.

I understand that this plan of work must receive approval in writing by the Geological Survey before operations may be commenced.

Company Magnolia Petroleum CompanyAddress P. O. Box 2406Hobbs, New MexicoBy [Signature]Title District Superintendent

NEW MEXICO OIL CONSERVATION COMMISSION

Well Location and Acreage Dedication Plat

Section A.

Date July 14, 1958

Operator MAGNOLIA PETROLEUM COMPANY Lease SIMMONS-FEDERAL
Well No. 2 Unit Letter _____ Section 26 Township 16S Range 29E NMPH
Located 330 Feet From East Line, 330 Feet From South Line
County Eddy G. L. Elevation 3634.6 Dedicated Acreage 40 Acres
Name of Producing Formation Premier Pool Forest

1. Is the Operator the only owner* in the dedicated acreage outlined on the plat below?
Yes x No _____.
2. If the answer to question one is "no," have the interests of all the owners been consolidated by communitization agreement or otherwise? Yes _____ No _____. If answer is "yes," Type of Consolidation _____
3. If the answer to question two is "no," list all the owners and their respective interests below:

Owner

Land Description

Section B.

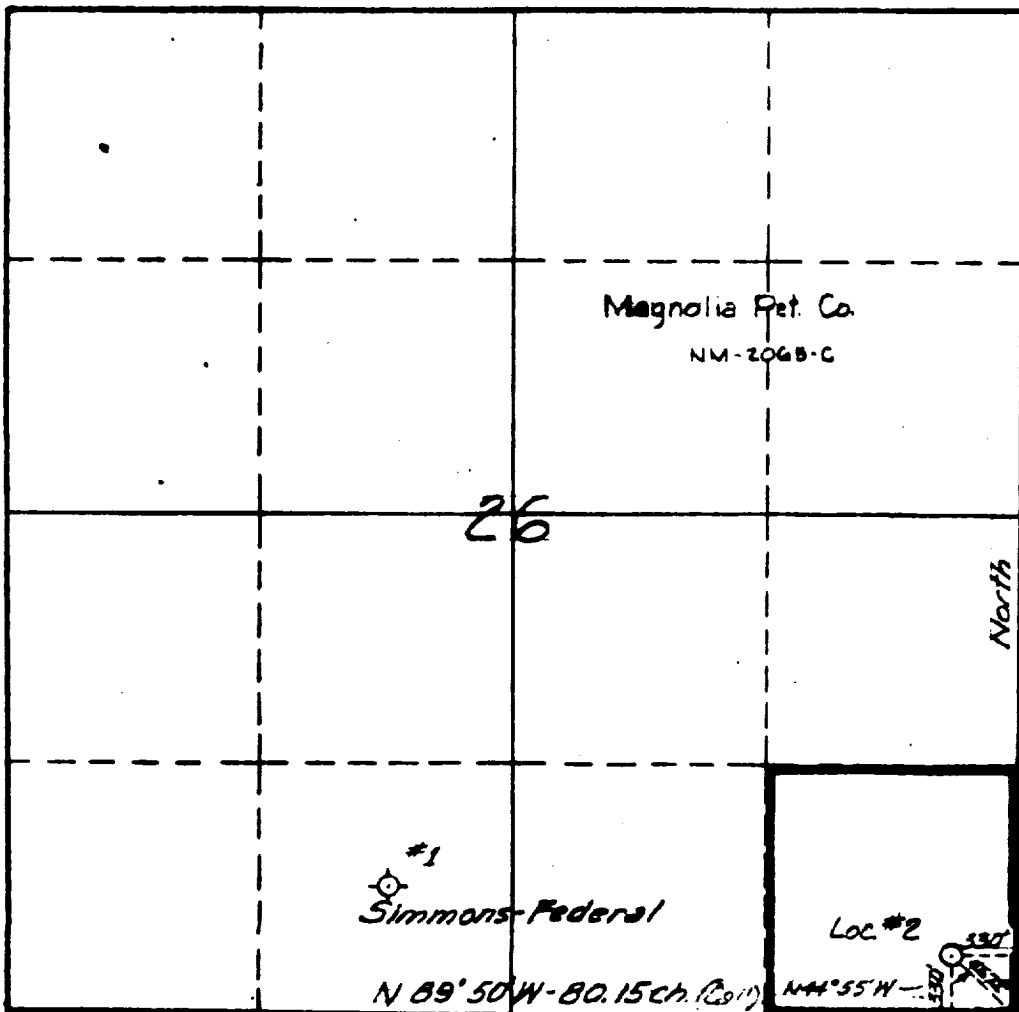

RECEIVED
JUL 23 1958

U. ARLESIA, NEW MEXICO

This is to certify that the information in Section A above is true and complete to the best of my knowledge and belief.

MAGNOLIA PETROLEUM COMPANY
(Operator)

W. Young, Jr.
(Representative)

Box 2406, Hobbs, New Mexico
Address

This is to certify that the well location shown on the plat in Section B was plotted from field notes of actual surveys made by me or under my supervision and that the same is true and correct to the best of my knowledge and belief.

Date Surveyed July 13, 1958

Carl E. Turner
Registered Professional
Engineer and/or Land Surveyor.

Certificate No. 2490

