

(SUBMIT IN TRIPLICATE)

UNITED STATES
DEPARTMENT OF THE INTERIOR
GEOLOGICAL SURVEY

Land Office **Las Cruces**
Lease No. **L.C. 058996 (a)**
Unit _____

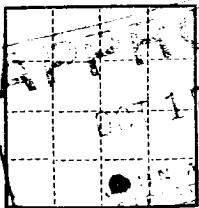

30-015 - 02784

SUNDRY NOTICES AND REPORTS ON WELLS

NOTICE OF INTENTION TO DRILL	<input checked="" type="checkbox"/>	SUBSEQUENT REPORT OF WATER SHUT-OFF
NOTICE OF INTENTION TO CHANGE PLANS		SUBSEQUENT REPORT OF SHOOTING OR ACIDIZING
NOTICE OF INTENTION TO TEST WATER SHUT-OFF		SUBSEQUENT REPORT OF ALTERING CASING
NOTICE OF INTENTION TO RE-DRILL OR REPAIR WELL		SUBSEQUENT REPORT OF RE-DRILLING OR REPAIR
NOTICE OF INTENTION TO SHOOT OR ACIDIZE		SUBSEQUENT REPORT OF ABANDONMENT
NOTICE OF INTENTION TO PULL OR ALTER CASING		SUPPLEMENTARY WELL HISTORY
NOTICE OF INTENTION TO ABANDON WELL		

(INDICATE ABOVE BY CHECK MARK NATURE OF REPORT, NOTICE, OR OTHER DATA)

October 17, 1957

Dale Federal
Well No. 1 is located 660 ft. from MY line and 1780 ft. from E line of sec. 33
SW/4 SE/4 Sec. 33 16 S 29 E NMPM
(1/4 Sec. and Sec. No.) (Twp.) (Range) (Meridian)
Undesignated (Cave) Eddy New Mexico
(Field) (County or Subdivision) (State or Territory)

The elevation of the derrick floor above sea level is 3597 ft.

DETAILS OF WORK

(State names of and expected depths to objective sands; show sizes, weights, and lengths of proposed casings; indicate mudding jobs, cementing points, and all other important proposed work)

Propose to drill to approximately 2550' to test the Grayburg and Lovington sand. Will set approximately 500' of new 8 5/8" 24 # seamless casing, with 75 sacks cement. Will run and set 7" casing for water shut off if water is encountered in the Red Sand. Will run new 5 1/2" 14# casing to total depth for production string and cement with 150 sacks cement. We would also like permission to pull the 7" water string at time of cementing the oil string.

I understand that this plan of work must receive approval in writing by the Geological Survey before operations may be commenced.

Company Western Development Company of Delaware

Address P. O. Box 445

Artesia, New Mexico

By L. E. Johnson

Title Dist. Supt.

NEW MEXICO OIL CONSERVATION COMMISSION
Well Location and Acreage Dedication Plat

Section A.

Date October 17, 1957

Delaware

Operator Western Development Company of Dale - Federal
Well No. 1 Unit Letter 0 Section 33 Township 16 S Range 29 E NMPM
Located 600 Feet From South Line, 1780 Feet From East Line
County Eddy G. L. Elevation 3595 Dedicated Acreage 40 Acres
Name of Producing Formation Grayburg San Andres Pool Undesignated (Cave)

1. Is the Operator the only owner* in the dedicated acreage outlined on the plat below?
Yes XX No _____.
2. If the answer to question one is "no," have the interests of all the owners been consolidated by communitization agreement or otherwise? Yes _____ No _____. If answer is "yes," Type of Consolidation _____
3. If the answer to question two is "no," list all the owners and their respective interests below:

Owner

Land Description

Section B

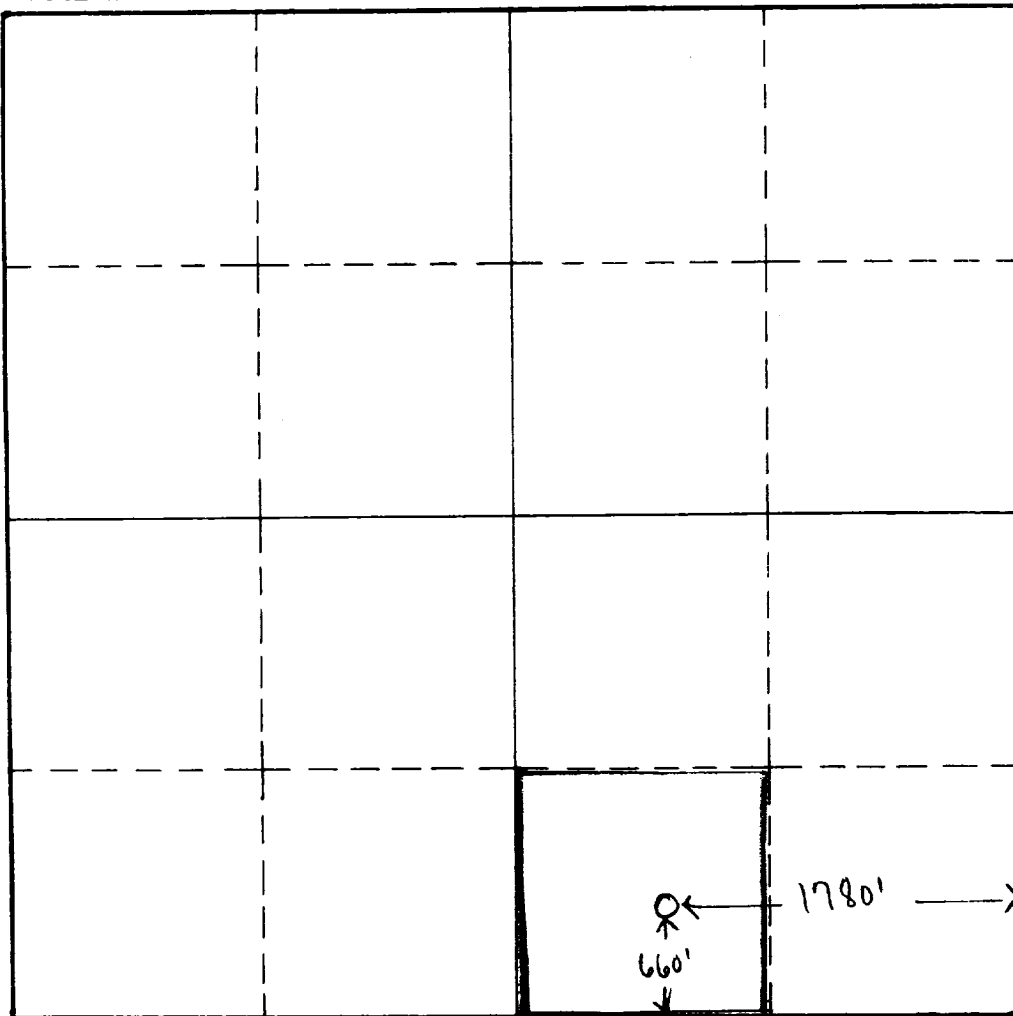

This is to certify that the information in Section A above is true and complete to the best of my knowledge and belief.

Western Development Co.
(Operator) of Delaware
P. G. Hanson
(Representative)

P. O. Box 445
Artesia, New Mexico

This is to certify that the well location shown on the plat in Section B was plotted from field notes of actual surveys made by me or under my supervision and that the same is true and correct to the best of my knowledge and belief.

Date Surveyed 10-12-57

W B Macey
Registered Professional
Engineer and/or Land Surveyor

Certificate No. 926

INSTRUCTIONS FOR COMPLETION:

1. Operator shall furnish and certify to the information called for in Section A.
2. Operator shall outline the dedicated acreage for both oil and gas wells on the plat in Section B.
3. A registered professional engineer or land surveyor registered in the State of New Mexico or approved by the Commission shall show on the plat the location of the well and certify this information in the space provided.
4. All distances shown on the plat must be from the outer boundaries of Section.
5. If additional space is needed for listing owners and their respective interests as required in question 3, Section A, please use space below

* "Owner" means the person who has the right to drill into and to produce from any pool and to appropriate the production either for himself or for himself and another. (65-3-29 (e) NMSA 1953 Comp.)