

(SUBMIT IN TRIPLICATE)

UNITED STATES  
DEPARTMENT OF THE INTERIOR  
GEOLOGICAL SURVEY

Land Office Las Cruces  
Lease No. 16 00195  
Unit Dunes

30-015-02812

SUNDRY NOTICES AND REPORTS ON WELLS

NOTICE OF INTENTION TO DRILL	<input checked="" type="checkbox"/>	SUBSEQUENT REPORT OF WATER SHUT-OFF	
NOTICE OF INTENTION TO CHANGE PLANS		SUBSEQUENT REPORT OF SHOOTING OR ACIDIZING	
NOTICE OF INTENTION TO TEST WATER SHUT-OFF		SUBSEQUENT REPORT OF ALTERING CASING	
NOTICE OF INTENTION TO RE-DRILL OR REPAIR WELL		SUBSEQUENT REPORT OF RE-DRILLING OR REPAIR	
NOTICE OF INTENTION TO SHOOT OR ACIDIZE		SUBSEQUENT REPORT OF ABANDONMENT	
NOTICE OF INTENTION TO PULL OR ALTER CASING		SUPPLEMENTARY WELL HISTORY	
NOTICE OF INTENTION TO ABANDON WELL			

(INDICATE ABOVE BY CHECK MARK NATURE OF REPORT, NOTICE, OR OTHER DATA)

North Leas Hills, New Mexico May 23, 19 57  
Well No. 3 is located 1450 ft. from S line and 2310 ft. from E line of sec. 35  
35 (Sec. and Sec. No.) 14-1 (Twp.) 23-1 (Range) 14-1 (Meridian)  
Leas Hills (Field) Leas Hills (County or Subdivision) New Mexico (State or Territory)

The elevation of the derrick floor above sea level is 3660 ft.

DETAILS OF WORK

(State names of and expected depths to objective sands; show sizes, weights, and lengths of proposed casings; indicate mudding jobs, cementing points, and all other important proposed work)

WE PROPOSE TO DRILL THIS WELL AS FOLLOWS:  
OBJECTIVE: Livingston Sand (San Andres).  
TOTAL DEPTH: Approximately 2700'.  
METHOD OF DRILLING: Cable tools to total depth.  
CASING PROGRAM: Will set approximately 450' of 10 3/4" OD casing in top of salt section and cement with 50 sacks. If sufficient water is encountered in the Gypsum formation, will set approximately 1675' of 8 5/8" casing and chipping formation shut-off. In the event commercial production is indicated a production string of 7" OD casing will be run and cemented at approximately 2650'.  
DRILLING CONTRACTOR: Needham Drilling Company.  
DRILLING OPERATIONS TO COMMENCE: On or about May 25, 1957

I understand that this plan of work must receive approval in writing by the Geological Survey before operations may be commenced.

Company GENERAL AMERICAN OIL COMPANY OF TEXAS

Address P. O. BOX 416

LEAS HILLS, NEW MEXICO

By R. J. Board  
Title Field Superintendent.

NEW MEXICO  
OIL CONSERVATION COMMISSION

Form C-128

Well Location and/or Gas Proration Plat

Date 5-21-57

Operator General American Oil Co of Texas Lease Nunlee

Well No. 3 Section 35 Township 16 S Range 29 E NMPM

Located 1650 Feet From South Line, 2310 Feet From East Line,

Eddy County, New Mexico. G. L. Elevation 3657.6

Name of Producing Formation \_\_\_\_\_ Pool \_\_\_\_\_ Dedicated Acreage \_\_\_\_\_

(Note: All distances must be from outer boundaries of Section)

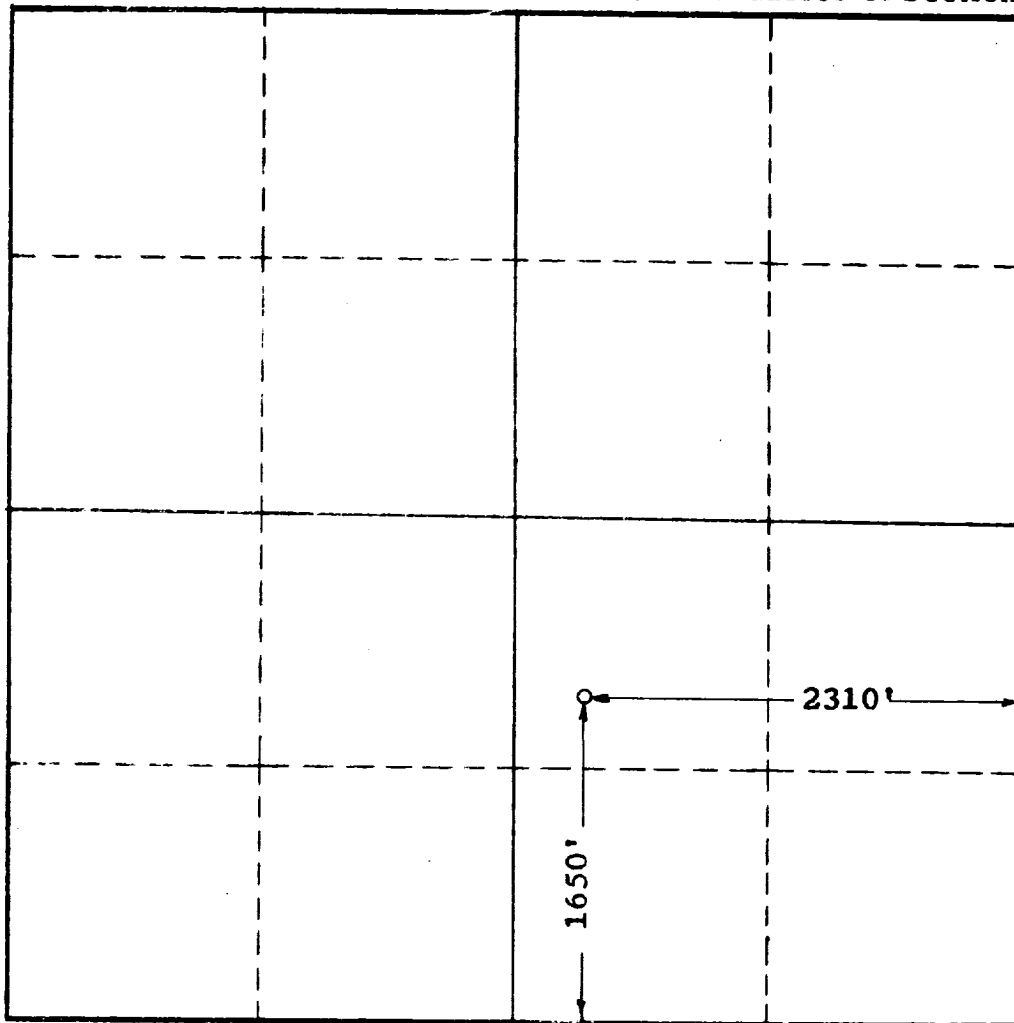

SCALE: 1" = 1000'

1. Is this Well a Dual Comp. ? Yes \_\_\_ No \_\_\_.
2. If the answer to Question 1 is yes, are there any other dually completed wells within the dedicated acreage? Yes \_\_\_ No \_\_\_.

This is to certify that the above plat was prepared from field notes of actual surveys made by me or under my supervision and that the same are true and correct to the best of my knowledge and belief.

Name \_\_\_\_\_  
Position \_\_\_\_\_  
Representing \_\_\_\_\_  
Address \_\_\_\_\_

Date Surveyed 5-21-57  
John W. West  
Registered Professional Engineer and/or  
Land Surveyor