

NEW MEXICO OIL CONSERVATION COMMISSION
Santa Fe, New Mexico

Form C-101
Revised (12/1/55)

OCT 11 1957

30-015-02818

NOTICE OF INTENTION TO DRILL

Notice must be given to the District Office of the Oil Conservation Commission and approval obtained before drilling or recompletion begins. If changes in the proposed plan are considered advisable, a copy of this notice showing such changes will be returned to the sender. Submit this notice in QUINTUPLICATE. One copy will be returned following approval. See additional instructions in Rules and Regulations of the Commission. If State Land submit 6 Copies Attach Form C- 128 in triplicate to first 3 copies of form C-101

Midland, Texas
(Place)

October 9, 1957
(Date)

OIL CONSERVATION COMMISSION
SANTA FE, NEW MEXICO

Gentlemen:

You are hereby notified that it is our intention to commence the Drilling of a well to be known as

Neil E. Salsich

(Company or Operator)

Leonard-Staté
(Lease)

Well No. 1, in F. The well is
(Unit)

located 1980 feet from the North line and 1980 feet from the

West

line of Section 36, T. 16S, R. 29E, NMPM.

(GIVE LOCATION FROM SECTION LINE)

Undesignated Pool, Eddy County

If State Land the Oil and Gas Lease is No.

If patented land the owner is.

Address.

We propose to drill well with drilling equipment as follows: Rotary

The status of plugging bond is \$10,000.00 Blanket Bond. Maryland Casualty Co.

Drilling Contractor Loco Drilling Company, Midland, Texas

We intend to complete this well in the Graybury formation at an approximate depth of 2700 feet.

CASING PROGRAM

We propose to use the following strings of Casing and to cement them as indicated:

Size of Hole	Size of Casing	Weight per Foot	New or Second Hand	Depth	Sacks Cement
11-7/8	8-5/8	28#	Used	370	Circulate
7-7/8	5-1/2	14	New	2700	100

If changes in the above plans become advisable we will notify you immediately.

ADDITIONAL INFORMATION (If recompletion give full details of proposed plan of work.)

OCT 11 1957

Approved....., 19.....
Except as follows:

OIL CONSERVATION COMMISSION

By M. L. Armstrong

Sincerely yours,

Neil E. Salsich

(Company or Operator)

By

Position Geologist

Send Communications regarding well to

Name Neil E. Salsich

Address 301 Central Bldg, Midland, Texas

OCT 11 1957

NEW MEXICO OIL CONSERVATION COMMISSION

Well Location and Acreage Dedication Plat

Section A.

Date 8-30-57 Oil Spns. Comm.
ARTESIA OFFICE

Operator Neil E. Salsich Lease Leonard State
Well No. 1 Unit Letter F Section 36 Township 16 S Range 29 N NMPM
Located 1980 Feet From North Line, 1980 Feet From West Line
County Eddy G. L. Elevation 3685.1 Dedicated Acreage 40 Acres
Name of Producing Formation GRAYBURG Pool UNDESIGNATED

1. Is the Operator the only owner* in the dedicated acreage outlined on the plat below?
Yes No ✓
2. If the answer to question one is "no," have the interests of all the owners been consolidated by communitization agreement or otherwise? Yes ✓ No _____. If answer is "yes," Type of Consolidation OPERATING AGREEMENT
3. If the answer to question two is "no," list all the owners and their respective interests below:

<u>Owner</u>	<u>Land Description</u>
<u>NEIL E. SALSICH</u>	<u>SE/4 NW/4</u>
<u>T. J. HOLLIS</u>	<u>SE/4 NW/4</u>

Section B

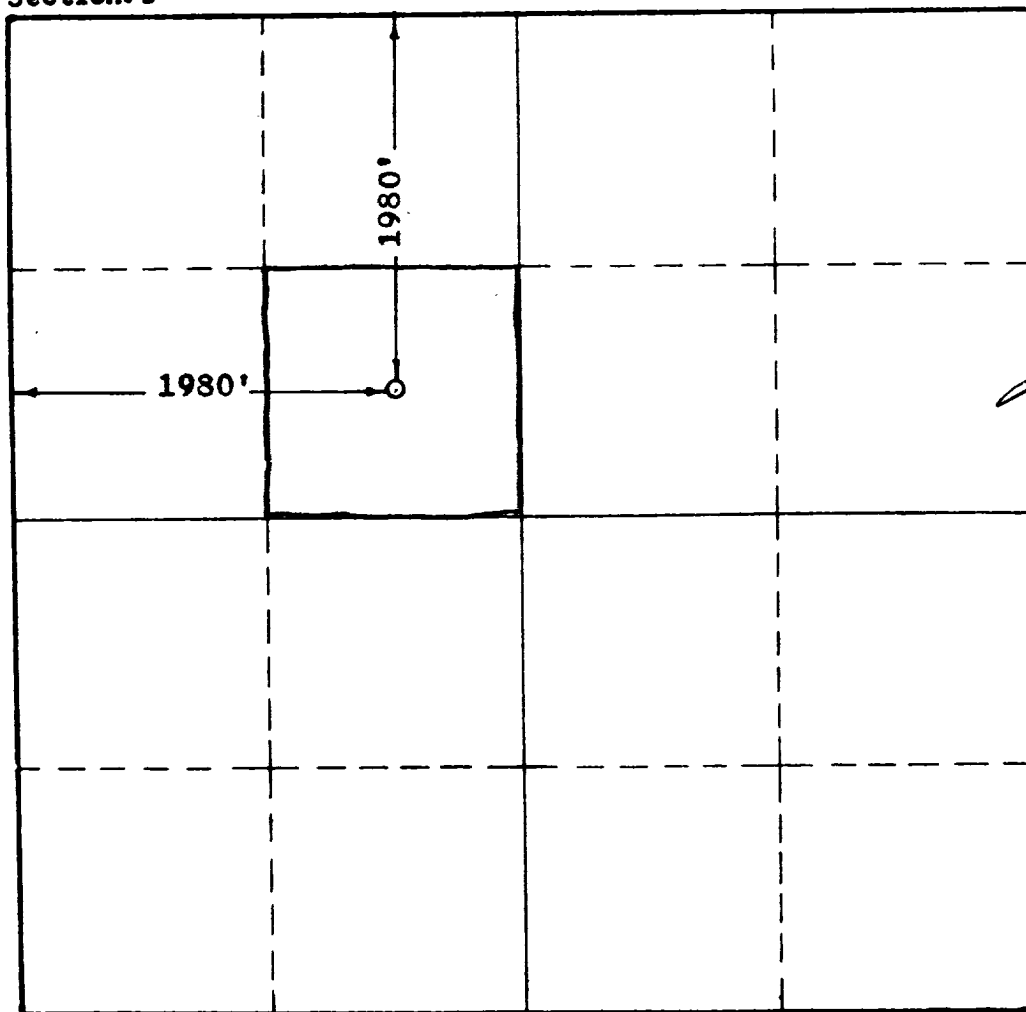

This is to certify that the information in Section A above is true and complete to the best of my knowledge and belief.

NEIL E. SALSICH
(Operator)

John Scott Allen
(Representative)

MIDLAND, TEXAS
Address

This is to certify that the well location shown on the plat in Section B was plotted from field notes of actual surveys made by me or under my supervision and that the same is true and correct to the best of my knowledge and belief.

Date Surveyed 8-30-57

John W. West
Registered Professional
Engineer and/or Land Surveyor.

Certificate No. 676

**OIL CONSERVATION COMMISSION
ARTESIA DISTRICT OFFICE**

No. Copies Received

DISTRIBUTION

	NO. FURNISHED	
Secretary	1	
Santa Fe		
Protection Office		
State Land Office		
U. S. G. S.		
Transporter		
File		