

Well Location and Acreage Dedication Plat

Section A.

Date December 1, 1961

Operator Tidewater Oil Company Lease State "A0"
 Well No. 1 Unit Letter R Section 2 Township 16-S Range 30-E NMPM
 located 2310 Feet From South Line, 1650' Feet From East Line
 County Eddy G. L. Elevation _____ Dedicated Acreage 40 Acres
 Name of Producing Formation Premier Pool West Henshaw

1. Is the Operator the only owner* in the dedicated acreage outlined on the plat below?
 Yes X No _____.
2. If the answer to question one is "no," have the interests of all the owners been consolidated by communitization agreement or otherwise? Yes _____ No _____. If answer is "yes," Type of Consolidation _____
3. If the answer to question two is "no," list all the owners and their respective interests below:

OwnerLand Description

Section B

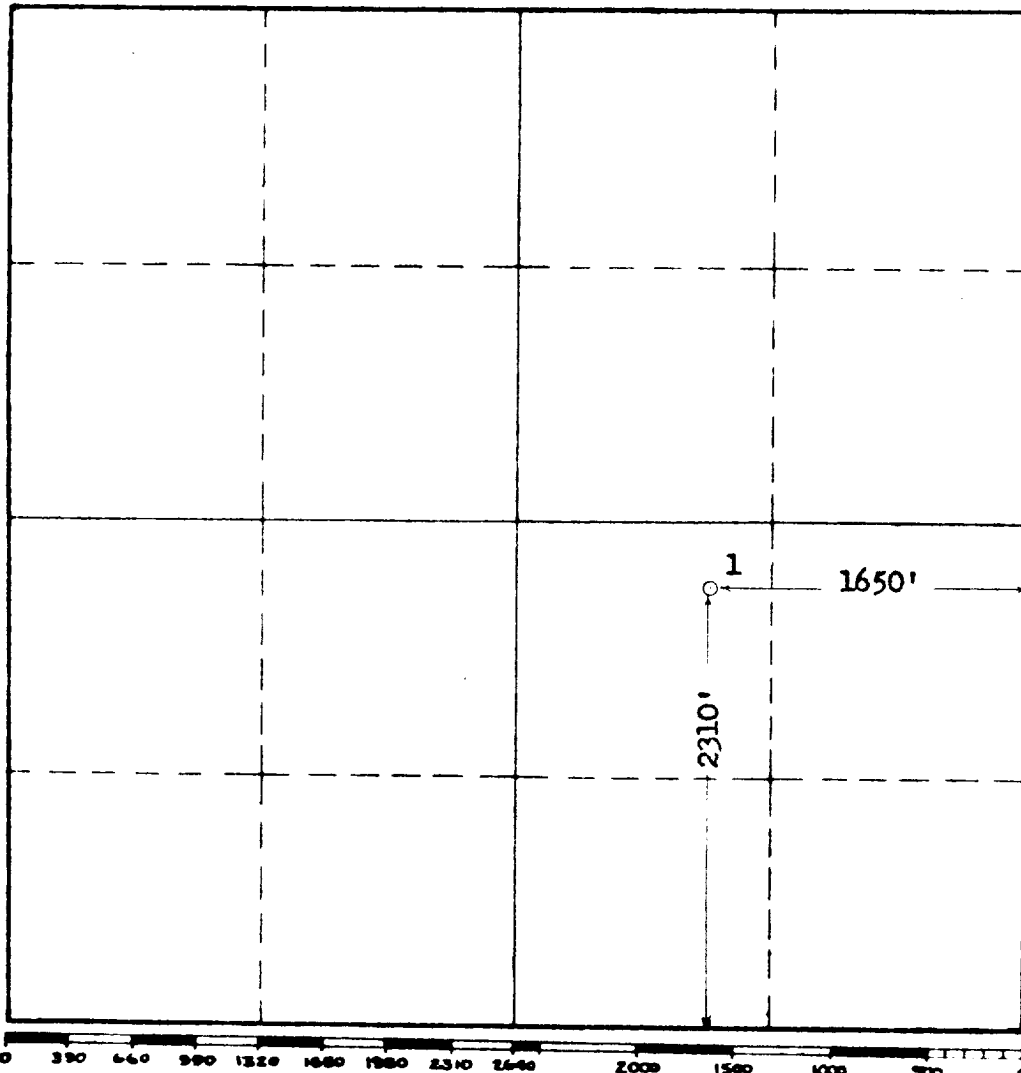

This is to certify that the information in Section A above is true and complete to the best of my knowledge and belief.

Tidewater Oil Company

(Operator)

J. M. Amis
 (Representative)

Box 1231, Midland, Texas

Address

Cor.

This is to certify that the well location shown on the plat in Section B was plotted from field notes of actual surveys made by me or under my supervision and that the same is true and correct to the best of my knowledge and belief.

Date Surveyed November 30, 1961

J. M. Amis (Company Employee)
 Registered Professional Engineer and/or Land Surveyor.

Certificate No. 5129 and 465
 Texas

(See instructions for completing this form on the reverse side)