

Form 9-331a
(Feb. 1951)

(SUBMIT IN TRIPLICATE)

UNITED STATES
DEPARTMENT OF THE INTERIOR
GEOLOGICAL SURVEY

Land Office Las Cruces

Lease No. 067610

Unit _____

30-015-03850

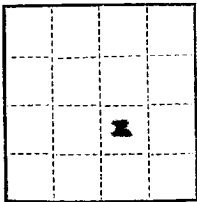

SUNDRY NOTICES AND REPORTS ON WELLS

NOTICE OF INTENTION TO DRILL.....	<input checked="" type="checkbox"/>	SUBSEQUENT REPORT OF WATER SHUT-OFF.....	
NOTICE OF INTENTION TO CHANGE PLANS.....		SUBSEQUENT REPORT OF SHOOTING OR ACIDIZING.....	
NOTICE OF INTENTION TO TEST WATER SHUT-OFF.....		SUBSEQUENT REPORT OF ALTERING CASING.....	
NOTICE OF INTENTION TO RE-DRILL OR REPAIR WELL.....		SUBSEQUENT REPORT OF RE-DRILLING OR REPAIR.....	
NOTICE OF INTENTION TO SHOOT OR ACIDIZE.....		SUBSEQUENT REPORT OF ABANDONMENT.....	
NOTICE OF INTENTION TO PULL OR ALTER CASING.....		SUPPLEMENTARY WELL HISTORY.....	
NOTICE OF INTENTION TO ABANDON WELL.....			

(INDICATE ABOVE BY CHECK MARK NATURE OF REPORT, NOTICE, OR OTHER DATA)

L. E. WORTH

May 14, 1957

Well No. 2 is located 1980 ft. from S line and 1980 ft. from E line of sec. 4

SE/4 Sec. 4

T-16-S

R-30-S

NMPM

(1/4 Sec. and Sec. No.)

(Twp.)

(Range)

(Meridian)

Undesignated

Eddy

New Mexico

(Field)

(County or Subdivision)

(State or Territory)

The elevation of the derrick floor above sea level is _____ ft. To be furnished later

DETAILS OF WORK

(State names of and expected depths to objective sands; show sizes, weights, and lengths of proposed casings; indicate mudding jobs, cementing points, and all other important proposed work)

We propose to drill the above well with rotary tools to an approximate depth of 2860' and set casing as follows:

<u>Size of Hole</u>	<u>Size of Casing</u>	<u>Depth</u>	<u>Cement</u>
<u>11"</u>	<u>8-5/8"</u>	<u>550'</u>	<u>150 sacks of 25 gal and 100 sacks neat circulated to surface.</u>
<u>7-5/8"</u>	<u>5-1/2"</u>	<u>2860'</u>	<u>125 sacks neat</u>

I understand that this plan of work must receive approval in writing by the Geological Survey before operations may be commenced.

Company Pan American Petroleum Corporation

Address Box 68

Hotels,

New Mexico

By [Signature]

Title Field Superintendent

NEW MEXICO
OIL CONSERVATION COMMISSION

Form C-128

Well Location and/or Gas Proration Plat

Date 4-16-57

Operator Pan American Pet. Corp. Lease I. W. Bosworth

Well No. 2 Section 4 Township 16 S Range 30 E NMPM

Located 1980 Feet From South Line, 1980 Feet From East Line,

Eddy County, New Mexico. G. L. Elevation _____

Name of Producing Formation _____ Pool _____ Dedicated Acreage _____

(Note: All distances must be from outer boundaries of Section)

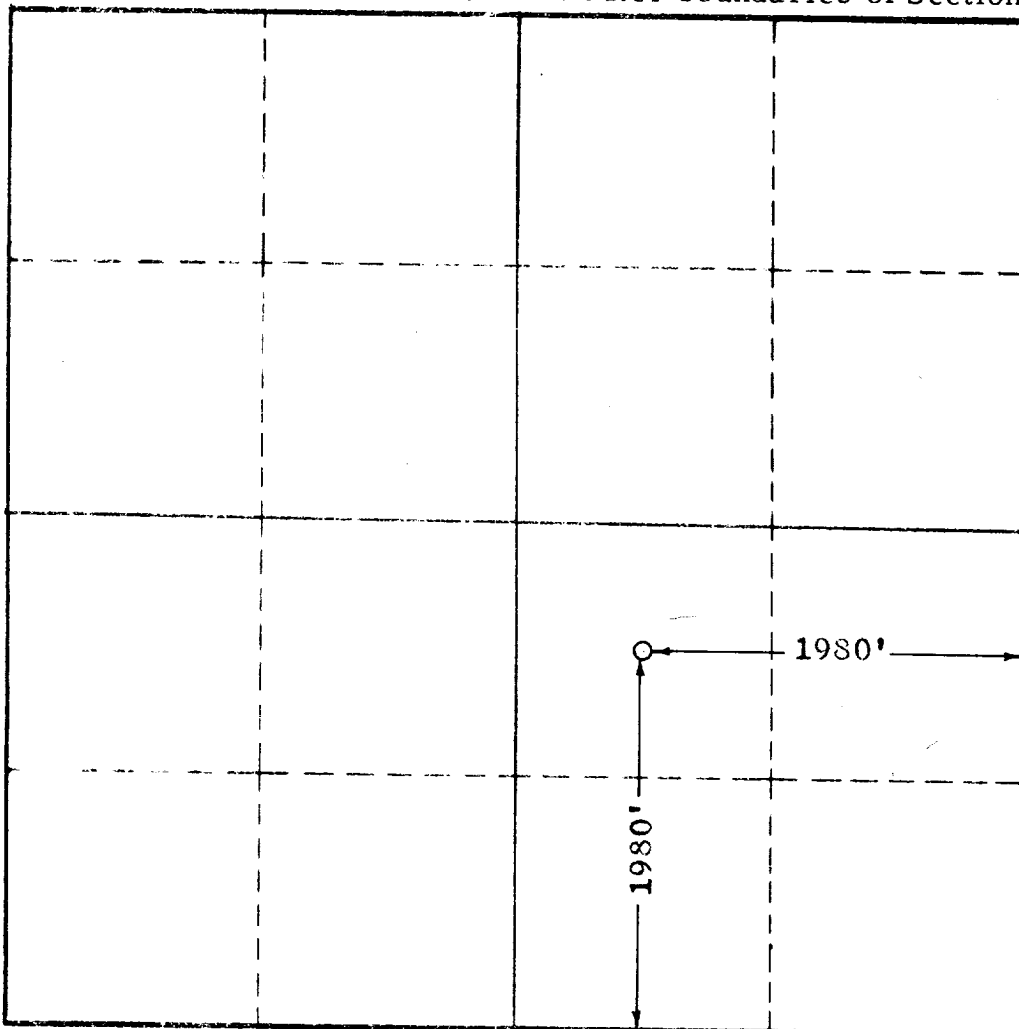

1. Is this Well a Dual Comp.? Yes ___ No ___

2. If the answer to Question 1 is yes, are there any other dually completed wells within the dedicated acreage? Yes ___ No ___

This is to certify that the above plat was prepared from field notes of actual surveys made by me or under my supervision and that the same are true and correct to the best of my knowledge and belief.

Name _____
Position _____
Representing _____
Address _____

Date Surveyed 4-6-57
Registered Professional Engineer and/or Land Surveyor J. W. West

JOHN W. WEST ENGINEERING COMPANY
412 NORTH DAL PASO
HOBBS, NEW MEXICO

April 8, 1957

Pan American Pet. Corp.
Hobbs, New Mexico

Gentlemen:

April 6, 1957 a survey was made to locate your Wells numbered 1, 2, 3 and 4 on the I. W. Bosworth Lease in the SE $\frac{1}{4}$ of Sec. 4, T16S, R30E, N.M.P.M., Eddy county, New Mexico. Listed below are the locations:

Well No. 1 1980' from East & 660' from South lines.
Well No. 2 1980' from East & 1980' from South lines.
Well No. 3 660' from East & 660' from South lines.
Well No. 4 660' from East & 1980' from South lines.

A flag was set at the U.S.G.L.O. $\frac{1}{4}$ corner marker, common to Sections 4 and 9, then the Transit was set at the U.S.G.L.O. Section corner marker common to Sections 3, 4, 9 and 10, thence sighting at the Flag we chained S89°59'W 660 feet and set a wooden stake. Thence setting up the Transit at this point and turning an angle of 89°59' in the Northwest Quadrant we chained N0°02'W a distance of 660 feet to the location of Well No. 3, thence continueing on the same bearing of N0°02'W and chaining a distance of 1320 feet from well No. 3 to the proposed location of well No. 4, thence setting up Transit at well No. 4 and turning an angle of 90°01' in the Southwest Quadrant we chained S39°59'W a distance of 1320 feet to the proposed location of well No. 2, thence setting up Transit at the site of well No. 2 and turning an Angle of 89°59' in the Southeast Quadrant we chained S0°02'E a distance of 1320 feet to the proposed well site of No. 1, thence continueing on the same bearing of S0°02'E we chained a distance of 660 feet to the South section line of Sec. 4 and set a wooden Stake, thence setting up Transit at this point and turning to the U.S.G.L.O. section corner marker common to Sec. 3, 4, 9 and 10 we found the angle to be 90°01'30" for an error of 0°00'30", thence chaining to this point we found the distance to be 1980.40 well within the allowable limits of this survey.

I hereby certify that the foregoing survey was made in the field under my supervision and that the same is true and correct to the best of knowledge and belief.

Respectfully submitted,

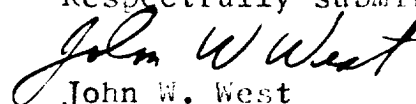
John W. West