

(SUBMIT IN TRIPLICATE)

UNITED STATES
DEPARTMENT OF THE INTERIOR
GEOLOGICAL SURVEY

Land Office Las Cruces
Lease No. 067610
Unit JUN 25 1957

30-015-03852
Oil Comm. Comm.
ARTESIA OFFICE

SUNDRY NOTICES AND REPORTS ON WELLS

NOTICE OF INTENTION TO DRILL	<input checked="" type="checkbox"/>	SUBSEQUENT REPORT OF WATER SHUT-OFF	
NOTICE OF INTENTION TO CHANGE PLANS		SUBSEQUENT REPORT OF SHOOTING OR ACIDIZING	
NOTICE OF INTENTION TO TEST WATER SHUT-OFF		SUBSEQUENT REPORT OF ALTERING CASING	
NOTICE OF INTENTION TO RE-DRILL OR REPAIR WELL		SUBSEQUENT REPORT OF RE-DRILLING OR REPAIR	
NOTICE OF INTENTION TO SHOOT OR ACIDIZE		SUBSEQUENT REPORT OF ABANDONMENT	
NOTICE OF INTENTION TO PULL OR ALTER CASING		SUPPLEMENTARY WELL HISTORY	
NOTICE OF INTENTION TO ABANDON WELL			

(INDICATE ABOVE BY CHECK MARK NATURE OF REPORT, NOTICE, OR OTHER DATA)

Beneath

June 17, 1957

Well No. 4 is located 1980 ft. from S line and 660 ft. from E line of sec. 4

SE/4 Sec. 4
(1/4 Sec. and Sec. No.)

T-16-S R-30-E
(Twp.) (Range)

N M P M
(Meridian)

W. Henshaw Grayburg
(Field)

Eddy
(County or Subdivision)

New Mexico
(State or Territory)

The elevation of the derrick floor above sea level is _____ ft. To be furnished later.

DETAILS OF WORK

(State names of and expected depths to objective sands; show sizes, weights, and lengths of proposed casings; indicate mudding jobs, cementing points, and all other important proposed work)

We propose to drill the above well with rotary tools to an approximate depth of 2860 and set casing as follows:

Size of Hole	Size of Casing	Depth	Cement
11"	8-5/8"	550'	150 sacks of 2% gel and 100 sacks neat circulated to surface.
7-7/8"	5-1/2"	2860'	125 sacks neat.

I understand that this plan of work must receive approval in writing by the Geological Survey before operations may be commenced.

Company Pan American Petroleum Corporation

Address Box 68

Hobbs

New Mexico

By [Signature]

Title Field Superintendent

NEW MEXICO OIL CONSERVATION COMMISSION
Well Location and Acreage Dedication Plat

Section A.

Date 6-10-57

Operator Pan American Pet. Corp. Lease I. W. Bosworth
Well No. 4 Unit Letter 18 Section 4 Township 16 S Range 30 E NMPM
Located 1980 Feet From South Line, 660 Feet From East Line
County Eddy G. L. Elevation FURNISH LATER Dedicated Acreage 40 Acres
Name of Producing Formation GRAYBURG Pool W. HENSHAW GRAYBURG

1. Is the Operator the only owner* in the dedicated acreage outlined on the plat below?
Yes X No .
2. If the answer to question one is "no," have the interests of all the owners been consolidated by communitization agreement or otherwise? Yes No . If answer is "yes," Type of Consolidation
3. If the answer to question two is "no," list all the owners and their respective interests below:

Owner

Land Description

Section B

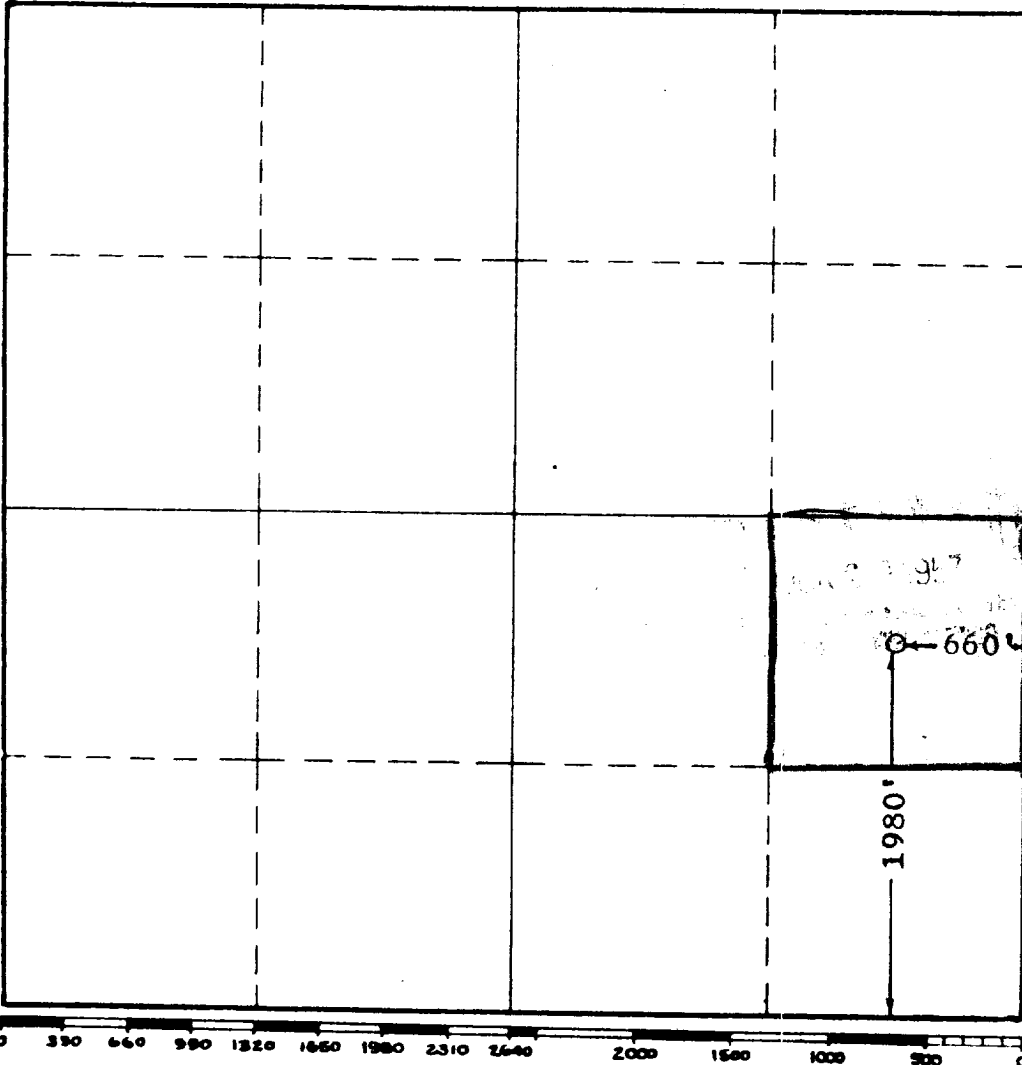

This is to certify that the information in Section A above is true and complete to the best of my knowledge and belief.

PAN AMERICAN PET. CORP.
(Operator)

(Representative)

Box 68, Hobbs N. M.
Address

This is to certify that the well location shown on the plat in Section B was plotted from field notes of actual surveys made by me or under my supervision and that the same is true and correct to the best of my knowledge and belief.

Date Surveyed 4-6-57

Colm W. West
Registered Professional
Engineer and/or Land Surveyor.

Certificate No. 676

(See instructions for completing this form on the reverse side)