

NUMBER OF COPIES RECEIVED 6	
DISTRIBUTION	
SANTA FE	
FILE	
U.S.G.S.	
LAND OFFICE	
TRANSPORTER	OIL
	GAS
PRORATION OFFICE	
OPERATOR	

NEW MEXICO OIL CONSERVATION COMMISSION
Santa Fe, New Mexico

Form C-101
Revised (12/1/55)

RECEIVED

NOTICE OF INTENTION TO DRILL

FEB 16 1962

Notice must be given to the District Office of the Oil Conservation Commission and approval obtained before drilling or recompletion begins. If changes in the proposed plan are considered advisable, a copy of this notice showing such changes will be returned to the sender. Submit this notice in QUINTUPLICATE. One copy will be returned following approval. See additional instructions in Rules and Regulations of the Commission. If State Land submit 6 Copies Attach Form C-128 in triplicate ~~attach 3 copies of form C-101~~

Hobbs, New Mexico

February 15, 1962

(Place)

(Date)

OIL CONSERVATION COMMISSION
SANTA FE, NEW MEXICO

30-015-03894

Gentlemen:

You are hereby notified that it is our intention to commence the Drilling of a well to be known as

N. M. State "A"

(Company or Operator)

Well No. **1**, in **8** (Unit). The well is located **1980** feet from the **east** line of Section **16**, T. **16S**, R. **30E**, NMPM. (GIVE LOCATION FROM SECTION LINE) **Wildcat** Pool **Eddy** County

D	C	B	A
E	F	IG	H
L	K	J	I
M	N	O	P

If State Land the Oil and Gas Lease is No. **E-933**

If patented land the owner is

Address

We propose to drill well with drilling equipment as follows: **Cable tools 9-3100' TD**

The status of plugging bond is **Approved**

Drilling Contractor **Not Selected**

We intend to complete this well in the **Levington or pays higher** formation at an approximate depth of **3000'** feet.

CASING PROGRAM

We propose to use the following strings of Casing and to cement them as indicated:

Size of Hole	Size of Casing	Weight per Foot	New or Second Hand	Depth	Sacks Cement
10"	8 5/8"	24#	New	550	150
8"	7"	20#	Used	2300	None (gel & oil)
8"	4 1/2"	9.5#	New	3100	250

If changes in the above plans become advisable we will notify you immediately.

ADDITIONAL INFORMATION (If recompletion give full details of proposed plan of work.)

* Will run only if necessary for drilling or samples recovery. If do run, will attempt to pull before cementing & 1/2" casing.

Approved **FEB 16 1962**, 19
Except as follows:

Sincerely yours,

Sunray Mid-Continent Oil Company

(Company or Operator)

By **E. L. Statton**

Position **District Engineer**

Send Communications regarding well to

Name **C. T. McClanahan**

Address **Box 128 Hobbs, New Mexico**

OIL CONSERVATION COMMISSION

By **M. L. Armstrong**
OIL AND GAS INSPECTOR

NEW MEXICO OIL CONSERVATION COMMISSION

WELL LOCATION AND ACREAGE DEDICATION PLAT

FORM C-128
Revised 5/1/57

SEE INSTRUCTIONS FOR COMPLETING THIS FORM ON THE REVERSE SIDE

SECTION A

Operator SUNRAY MID-CONTINENT OIL COMPANY			Lease NEW MEXICO STATE "AF" ARTESIA, OFFICE 1		Well No. D. C. C. 1
Unit Letter G	Section 16	Township 16 SOUTH	Range 30 EAST	County EDDY	
Actual Footage Location of Well: <div style="display: flex; justify-content: space-between;"> 1980 feet from the NORTH line and 1980 feet from the EAST line </div>					
Ground Level Elevation 7000 ft	Producing Formation Devil's Den or above			Pool Wildcat	Dedicated Acreage: 40 Acres

1. Is the Operator the only owner in the dedicated acreage outlined on the plat below? YES ☒ NO ☐ ("Owner" means the person who has the right to drill into and to produce from any pool and to appropriate the production either for himself or for himself and another. (65-3-29 (e) NMSA 1955 Comp.)
2. If the answer to question one is "no," have the interests of all the owners been consolidated by communitization agreement or otherwise? YES ☐ NO ☐ If answer is "yes," Type of Consolidation _____
3. If the answer to question two is "no," list all the owners and their respective interests below:

Owner	Land Description

SECTION B

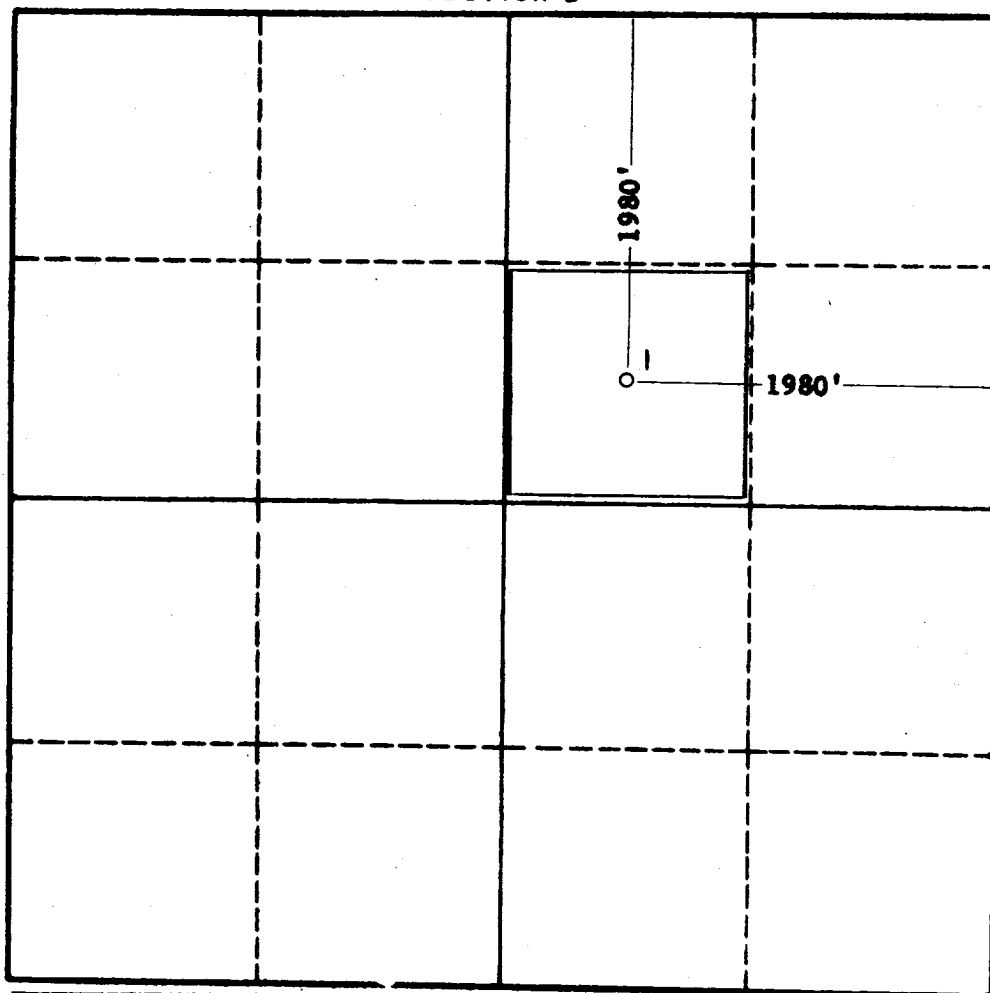

CERTIFICATION

I hereby certify that the information in SECTION A above is true and complete to the best of my knowledge and belief.

Name
Position R. E. Statton District Engineer
Company Sunray Mid-Continent Oil Co.
Date February 15, 1962

I hereby certify that the well location shown on the plat in SECTION B was plotted from field notes of a survey made by me or under my supervision, and that the same is true and correct to the best of my knowledge and belief.

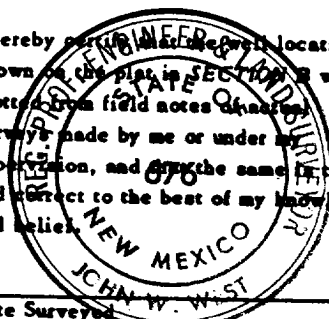

Date Surveyed 2/14/62
Registered Professional Engineer and/or Land Surveyor, JOHN W. WEST
Certificate No. N.M. - P.E. & L.S. NO. 676

0 330 660 990 1320 1650 1980 2310 2640 2000 1500 1000 500