

APPROVED

NEW MEXICO OIL CONSERVATION COMMISSION

MAY 23 1958

Well Location and Acreage Dedication Plat

Section A. JOHN A. FROST
DISTRICT ENGINEER

Date May 24, 58

Operator John H. Trigg Lease Federal "D"
Well No. 10-17 Unit Letter K Section 17 Township 16 S Range 30 E NMFM
Located 2310 Feet From South Line, 1980 Feet From West Line
County Eddy G. L. Elevation 3780.4 Dedicated Acreage 40 Acres
Name of Producing Formation Grayburg Sand Pool West Henshaw Grayburg Ext.

1. Is the Operator the only owner* in the dedicated acreage outlined on the plat below?
Yes ☒ No ☐.
2. If the answer to question one is "no," have the interests of all the owners been consolidated by communitization agreement or otherwise? Yes ☐ No ☐. If answer is "yes," Type of Consolidation _____
3. If the answer to question two is "no," list all the owners and their respective interests below:

Owner

Land Description

RECEIVED
MAY 23 1958

U. S. GEOLOGICAL SURVEY
ARTESIA, NEW MEXICO

Section B

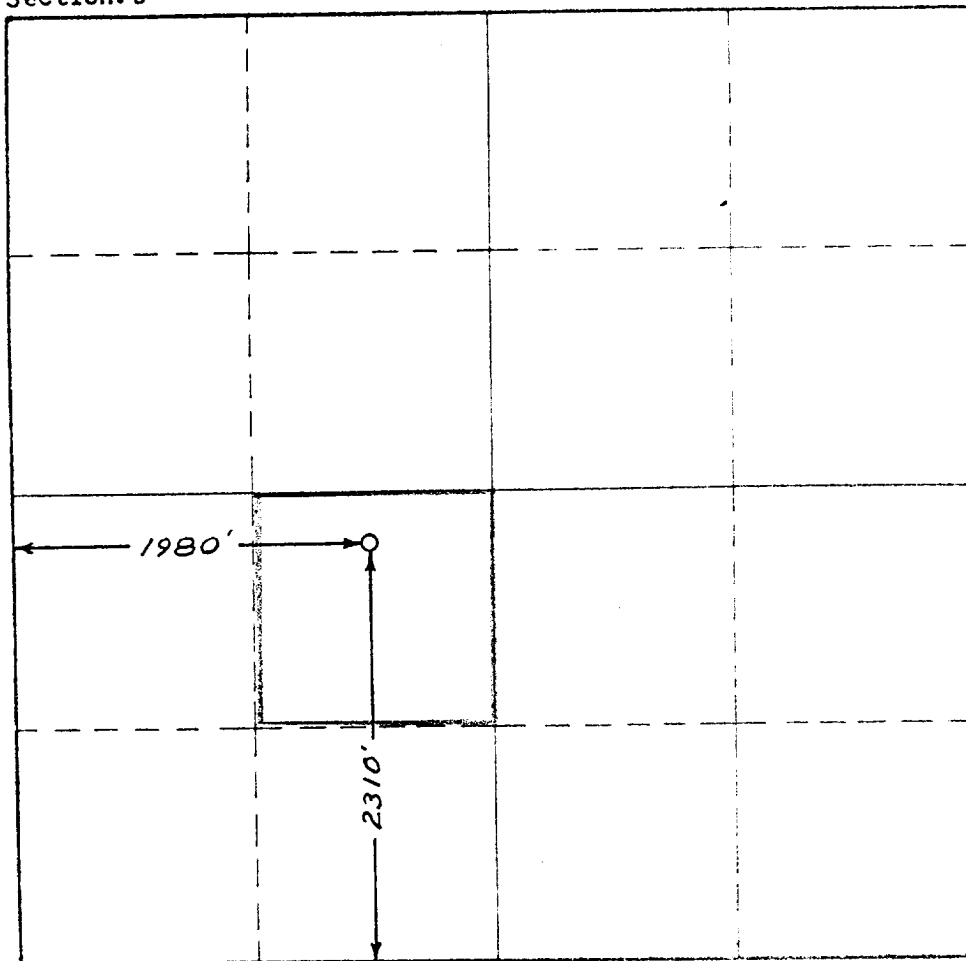

This is to certify that the information in Section A above is true and complete, to the best of my knowledge and belief.

John H. Trigg

(Operator)

John H. Trigg
(Representative)

P. O. Box 5629

Address

Roswell, New Mexico

This is to certify that the well location shown on the plat in Section B was plotted from field notes of actual surveys made by me or under my supervision and that the same is true and correct to the best of my knowledge and belief.

Date Surveyed May 20, 58

John W. West
Registered Professional
Engineer and/or Land Surveyor.