

Operator C.E. LaRue B.N. Muncy
 Well ETZ Fed #2
 Unit M Section 31 Township 16 Range 30
 API # 30-015-03956

TOPS

T. Salt 520
 B. Salt 980
 Yates 1140
 Glorieta _____
 Delaware _____
 Bone Sp. _____
 Abo _____
 Wolfcamp _____
 Morrow _____
 Devonian _____
 Fusselman _____
 Other _____

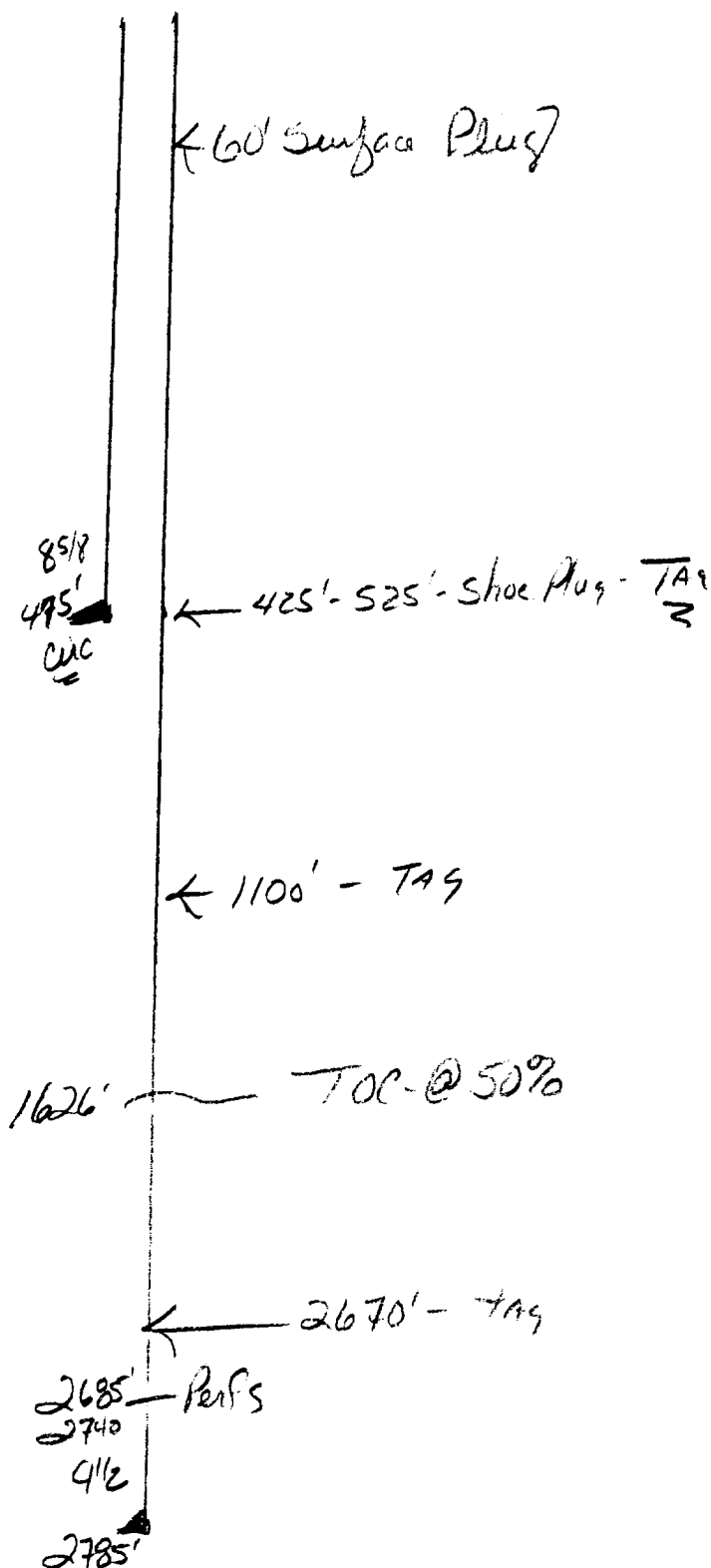

- Contact OCD 24 hrs. prior to any work done.
- Salt gel mud consisting of 10# brine with 25# of gel per barrel must be placed between each plug
- Install dry hole marker as per rule 202.B.2
- Plugs are to be set from point indicated up. Plugs must not be less than 100' or 25 Sacks of cement, whichever is greater, unless specifically indicated.
- Shoe and stub plugs will be 50' above and below shoe or stub and tagged.
- Surface plug will be from 0' - 60'
- Where plugs are required cement must be placed inside and outside of all casing string(s), in the correct footage or sacks required, if no cement exists.
- Plugs to be tagged will be indicated.