

Form 9-331a
(Feb. 1961)

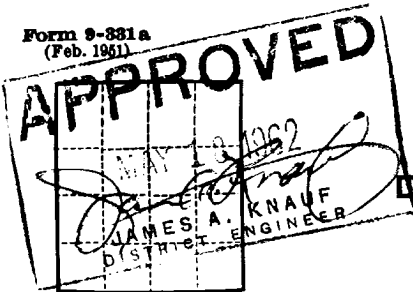

(SUBMIT IN TRIPLICATE)

UNITED STATES
DEPARTMENT OF THE INTERIOR
GEOLOGICAL SURVEY

Land Office _____

Lease No. 063926

Unit 3

RECEIVED

SUNDRY NOTICES AND REPORTS ON WELLS MAY 21 1962

NOTICE OF INTENTION TO DRILL	<input checked="" type="checkbox"/>	SUBSEQUENT REPORT OF WATER SHUT-OFF	<input type="checkbox"/>
NOTICE OF INTENTION TO CHANGE PLANS	<input type="checkbox"/>	SUBSEQUENT REPORT OF SHOOTING OR ACIDIZING	<input type="checkbox"/>
NOTICE OF INTENTION TO TEST WATER SHUT-OFF	<input type="checkbox"/>	SUBSEQUENT REPORT OF ALTERING CASING	<input type="checkbox"/>
NOTICE OF INTENTION TO RE-DRILL OR REPAIR WELL	<input type="checkbox"/>	SUBSEQUENT REPORT OF RE-DRILLING OR REPAIR	<input type="checkbox"/>
NOTICE OF INTENTION TO SHOOT OR ACIDIZE	<input type="checkbox"/>	SUBSEQUENT REPORT OF ABANDONMENT	<input type="checkbox"/>
NOTICE OF INTENTION TO PULL OR ALTER CASING	<input type="checkbox"/>	SUPPLEMENTARY WELL HISTORY	<input type="checkbox"/>
NOTICE OF INTENTION TO ABANDON WELL	<input type="checkbox"/>		

(INDICATE ABOVE BY CHECK MARK NATURE OF REPORT, NOTICE, OR OTHER DATA)

_____ MAY 18 _____, 1962

Well No. George Sts. 17 is located 2000 ft. from (N) line and 550 ft. from (E) line of sec. 35

5/4 16S 30E 107W
(1/4 Sec. and Sec. No.) (Twp.) (Range) (Meridian)
George Lake Eddy New Mexico
(Field) (County or Subdivision) (State or Territory)

The elevation of the derrick floor above sea level is _____ ft.

DETAILS OF WORK

(State names of and expected depths to objective sands; show sizes, weights, and lengths of proposed casings; indicate mudding jobs, cementing points, and all other important proposed work)

We propose to drill a producing well. The surface casing program is to be 8 5/8" 2 1/2' casing set at approximately 550' and cemented with 50 sacks. The oil string is to be 4 1/2" 7.5#, J-55 casing set at approximately 3175' and is to be cemented with 100 sacks.

MAY 18 1962
U. S. GEOLOGICAL SURVEY
ARTESIA, NEW MEXICO

I understand that this plan of work must receive approval in writing by the Geological Survey before operations may be commenced.

Company HEMLOCK OIL COMPANY

Address 300 Becker Building

Artesia, New Mexico

By H. J. LEDBETTER

Title Superintendent

NUMBER OF COPIES RECEIVED	
DISTRIBUTION	
SANTA FE	
FILE	
U.S.G.S.	
LAND OFFICE	
TRANSPORTER	OIL
	GAS
PRODUCTION OFFICE	
OPERATOR	

NEW MEXICO OIL CONSERVATION COMMISSION
WELL LOCATION AND ACREAGE DEDICATION PLAT
 SEE INSTRUCTIONS FOR COMPLETING THIS FORM ON THE REVERSE SIDE

FORM C-128
 Revised 5/1/57

SECTION A

Operator Newmont Oil Company		Lease George Etz Federal		Well No. 17
Unit Letter E	Section x 35	Township 16 South	Range 30 East	County Eddy
Actual Footage Location of Well: 550 feet from the West line and 2080 feet from the North line				
Ground Level Elev. 3777	Producing Formation Grayburg-San Andres		Pool Square Lake	Dedicated Acreage: 40 Acres

1. Is the Operator the only owner in the dedicated acreage outlined on the plat below? YES NO ____ . ("Owner" means the person who has the right to drill into and to produce from any pool and to appropriate the production either for himself or for himself and another. (65-3-29 (e) NMSA 1935 Comp.)
2. If the answer to question one is "no," have the interests of all the owners been consolidated by communitization agreement or otherwise? YES ____ NO ____ . If answer is "yes," Type of Consolidation _____
3. If the answer to question two is "no," list all the owners and their respective interests below:

Owner	Land Description

SECTION B

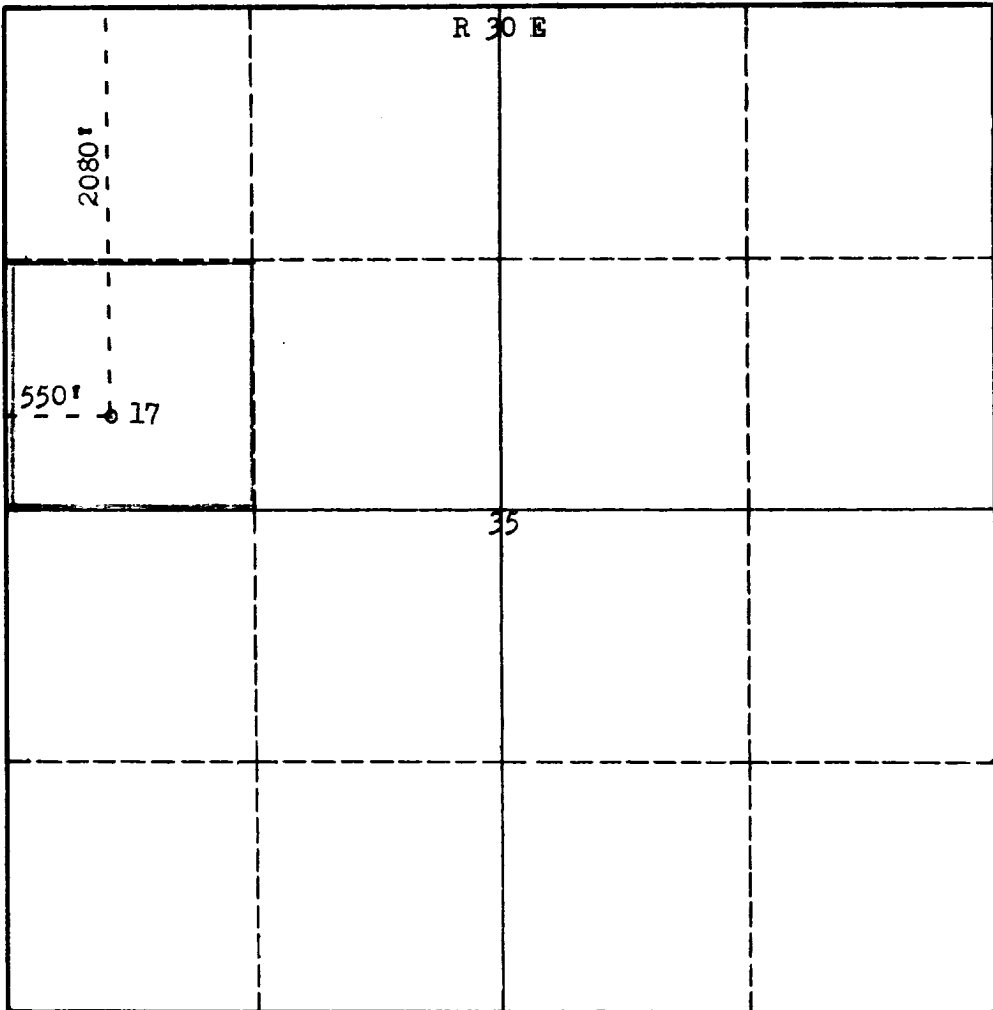

CERTIFICATION

I hereby certify that the information in SECTION A above is true and complete to the best of my knowledge and belief.

ORIGINAL SIGNED BY	
Name	H. J. LEDBETTER Herman J. Ledbetter
Position	Superintendent
Company	Newmont Oil Company
Date	May 17, 1962

I hereby certify that the well location shown on the plat in SECTION B was plotted from field notes of actual surveys made by me or under my supervision, and that the same is true and correct to the best of my knowledge and belief.

Date Surveyed	May, 17, 1962
Registered Professional Engineer and/or Land Surveyor	

James H. Brown
 Certificate No. _____
 N.M.L.S. No. **542**

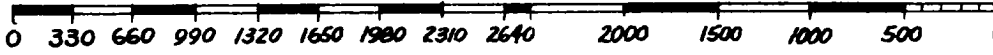

T
16
S

INSTRUCTIONS FOR COMPLETION OF FORM C-128

1. Operator shall furnish and certify to the information called for in Section A.
2. Operator shall outline the dedicated acreage for *both* oil and gas wells on the plat in Section B.
3. A registered professional engineer or land surveyor registered in the State of New Mexico or approved by the Commission shall show on the plat the location of the well and certify this information in the space provided.
4. All distances shown on the plat must be from the outer boundaries of the Section.
5. If additional space is needed for listing owners and their respective interests as required in question 3 of Section A, please use space below.