

NEW MEXICO OIL CONSERVATION COMMISSION
Santa Fe, New Mexico

Form C-101
Revised (12/1/55)

NOTICE OF INTENTION TO DRILL

Notice must be given to the District Office of the Oil Conservation Commission and approval obtained before drilling or recompletion begins. If changes in the proposed plan are considered advisable, a copy of this notice showing such changes will be returned to the sender. Submit this notice in QUINTUPLICATE. One copy will be returned following approval. See additional instructions in Rules and Regulations of the Commission. If State Land submit 6 Copies Attach Form C-128 in triplicate to first 3 copies of form C-101

Hobbs, New Mexico

January 24, 1962

(Place)

(Date)

OIL CONSERVATION COMMISSION
SANTA FE, NEW MEXICO

Gentlemen:

You are hereby notified that it is our intention to commence the Drilling of a well to be known as

Continental Oil Company

(Company or Operator)

State DD-2

(Lease)

Well No. 1

in T 1

The well is

located 1980 feet from the

South

(Unit)

660

feet from the

West

line of Section 2, T 16

R. 31, NMPM.

(GIVE LOCATION FROM SECTION LINE)

North Square Lake-Graybow Pool,

Eddy

County

1980⁰ FSL & 660⁰ FWL Sec. 2

If State Land the Oil and Gas Lease is No.

If patented land the owner is.

Address.

We propose to drill well with drilling equipment as follows: Rotary

The status of plugging bond is.

Blanket bond on file

Drilling Contractor

Unknown

We intend to complete this well in the

Premier Sand

formation at an approximate depth of

3775

feet.

CASING PROGRAM

We propose to use the following strings of Casing and to cement them as indicated:

| Size of Hole | Size of Casing | Weight per Foot | New or Second Hand | Depth | Sacks Cement |
|--------------|----------------|-----------------|--------------------|-------|------------------|
| 8 3/4 | 7 5/8 | 24 | New | 430 | Circulated - 185 |
| 6 3/4 | 4 1/2 | 9.50 | New | 3920 | 250 |
| | | | | | |

If changes in the above plans become advisable we will notify you immediately.

ADDITIONAL INFORMATION (If recompletion give full details of proposed plan of work.)

RECEIVED

JAN 31 1962

O. C. C.
ARTESIA, OFFICE

Approved: JAN 31 1962, 19.....
Except as follows: ---

Sincerely yours,

Continental Oil Company

(Company or Operator)

By: *C. M. Adits*

Position:

District Superintendent

Name:

Send Communications regarding well to
Continental Oil Company

Address:

Box 427 - Hobbs, New Mexico

OIL CONSERVATION COMMISSION

By: *M. L. Amstutz*

12000 (6) SLO JAM File

| | |
|---------------------------|-----|
| NUMBER OF COPIES RECEIVED | |
| DISTRIBUTION | |
| SANTA FE | |
| FILE | |
| U.R.G.S. | |
| LAND OFFICE | |
| TRANSPORTER | OIL |
| | GAS |
| PRORATION OFFICE | |
| OPERATOR | |

NEW MEXICO OIL CONSERVATION COMMISSION
WELL LOCATION AND ACREAGE DEDICATION PLAT
 SEE INSTRUCTIONS FOR COMPLETING THIS FORM ON THE REVERSE SIDE

FORM C-128
 Revised 5/1/57

SECTION A

| | | | | |
|---|---------------------------------------|---|---------------------------------------|-----------------------|
| Operator Continental Oil Co. | | Lease State D-D 2 | | Well No. 1 |
| Unit Letter KT | Section 2 | Township T-16-S | Range R-31-E | County Eddy |
| Actual Footage Location of Well: 1980 feet from the South line and 660 feet from the West line | | | | |
| Ground Level Elev. 4412 | Producing Formation Premier | Pool North Square Lake - Grayburg | Dedicated Acreage: 40 Acres | |

1. Is the Operator the only owner in the dedicated acreage outlined on the plat below? YES NO ____ . ("Owner" means the person who has the right to drill into and to produce from any pool and to appropriate the production either for himself or for himself and another. (65-3-29 (e) NMSA 1935 Comp.)
2. If the answer to question one is "no," have the interests of all the owners been consolidated by communitization agreement or otherwise? YES ____ NO ____ . If answer is "yes," Type of Consolidation _____
3. If the answer to question two is "no," list all the owners and their respective interests below:

| Owner | Land Description |
|-------|------------------|
| | |

SECTION B

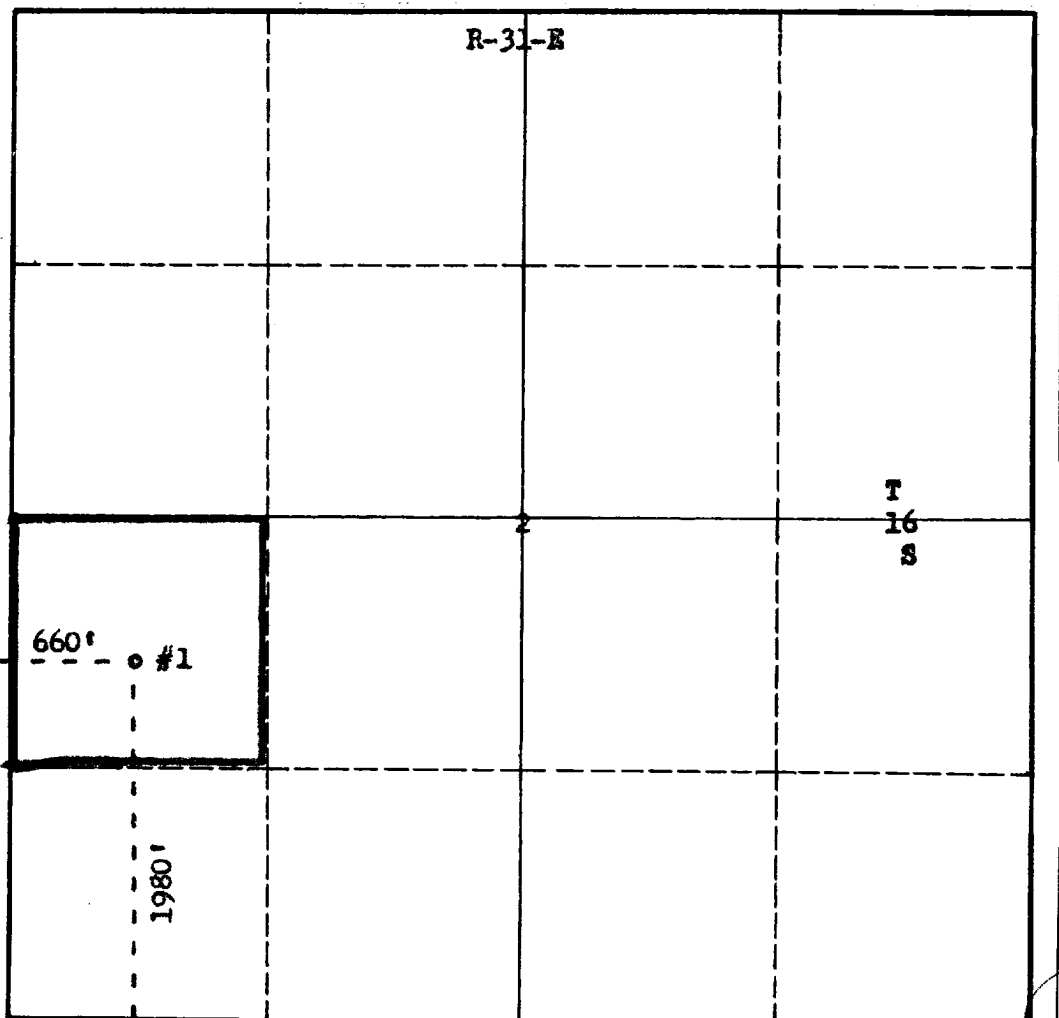

CERTIFICATION

I hereby certify that the information in SECTION A above is true and complete to the best of my knowledge and belief.

| |
|--------------------------------|
| Name |
| <i>C. J. G. G. G.</i> |
| Position |
| District Superintendent |
| Company |
| Continental Oil Company |
| Date |
| January 24, 1962 |

I hereby certify that the well location shown on the plat in SECTION B was plotted from field notes of actual surveys made by me or under my supervision, and that the same is true and correct to the best of my knowledge and belief.

| |
|---|
| Date Surveyed |
| January 22, 1962 |
| Registered Professional Engineer and/or Land Surveyor |
| <i>[Signature]</i> |

Certificate No. **3280**

