

NEW MEXICO OIL CONSERVATION COMMISSION
Santa Fe, New Mexico

RECEIVED
Revised (12/1/55)

OCT 31 1960

NOTICE OF INTENTION TO DRILL

Notice must be given to the District Office of the Oil Conservation Commission and approval obtained before drilling or recompletion begins. If changes in the proposed plan are considered advisable, a copy of this notice showing such changes will be returned to the sender. Submit this notice in QUINTUPLICATE. One copy will be returned following approval. See additional instructions in Rules and Regulations of the Commission. If State Land submit 6 Copies Attach Form C-128 in triplicate to first 3 copies of form C-101

Artesia, New Mexico

10-27-60

(Place)

(Date)

OIL CONSERVATION COMMISSION
SANTA FE, NEW MEXICO

Gentlemen:

You are hereby notified that it is our intention to commence the Drilling of a well to be known as

Continental Oil Company

(Company or Operator)

State T-3

Well No. 1

in 660

The well is

660

(Lease)

South

660

(Unit)

located 660 feet from the

East

line and

feet from the

line of Section 3

T 16-S

R

31-E

NMPM.

(GIVE LOCATION FROM SECTION LINE)

North Square Lake

Pool,

Eddy

County

If State Land the Oil and Gas Lease is No.

E 6484

If patented land the owner is

Address

We propose to drill well with drilling equipment as follows:

Rotary

The status of plugging bond is

Drilling Contractor

Blue Pacific Drilling Company

Box 832

Midland, Texas

We intend to complete this well in the

Grayburg

formation at an approximate depth of

4000

feet.

CASING PROGRAM

We propose to use the following strings of Casing and to cement them as indicated:

Size of Hole	Size of Casing	Weight per Foot	New or Second Hand	Depth	Sacks Cement
9 7/8	8 5/8	24#	New	200	140
7 7/8	5 1/2	14#	New	4000	1280

If changes in the above plans become advisable we will notify you immediately.

ADDITIONAL INFORMATION (If recompletion give full details of proposed plan of work.)

NMOC-6 HLJ WAN SLO File

OCT 31 1960

Approved _____, 19____
Except as follows:

OIL CONSERVATION COMMISSION

By

M. L. Armstrong

Oil and Gas Inspector

Sincerely yours,

Continental Oil Company

(Company or Operator)

By

CH. Lesser

Position

District Superintendent

Send Communications regarding well to

Name

Continental Oil Company

Address

Rowley Bldg., Artesia, N.M.

NEW MEXICO OIL CONSERVATION COMMISSION WELL LOCATION AND ACREAGE DEDICATION PLAT

RECEIVED

FORM C-128
Revised 5/1/57

OCT 31 1960

SEE INSTRUCTIONS FOR COMPLETING THIS FORM ON THE REVERSE SIDE

D. C. C.

ARTEZIA, OFFICE

Operator Continental Oil Company		Lease D & E State Y-3		Well No. 1
Unit Letter X	Section 2	Township 16 South	Range 31 East	County Eddy
Actual Footage Location of Well: 660 feet from the South line and 660 feet from the East line				
Ground Level Elev. 4299	Producing Formation Grayburg	Pool North Square Lake - JB	Dedicated Acreage: 40 Acres	

- Is the Operator the only owner in the dedicated acreage outlined on the plat below? YES ☒ NO ☐ ("Owner" means the person who has the right to drill into and to produce from any pool and to appropriate the production either for himself or for himself and another. (65-3-29 (e) NMSA 1935 Comp.)
- If the answer to question one is "no," have the interests of all the owners been consolidated by communitization agreement or otherwise? YES ☐ NO ☐ If answer is "yes," Type of Consolidation _____
- If the answer to question two is "no," list all the owners and their respective interests below:

Owner	Land Description

SECTION B

R 31 E

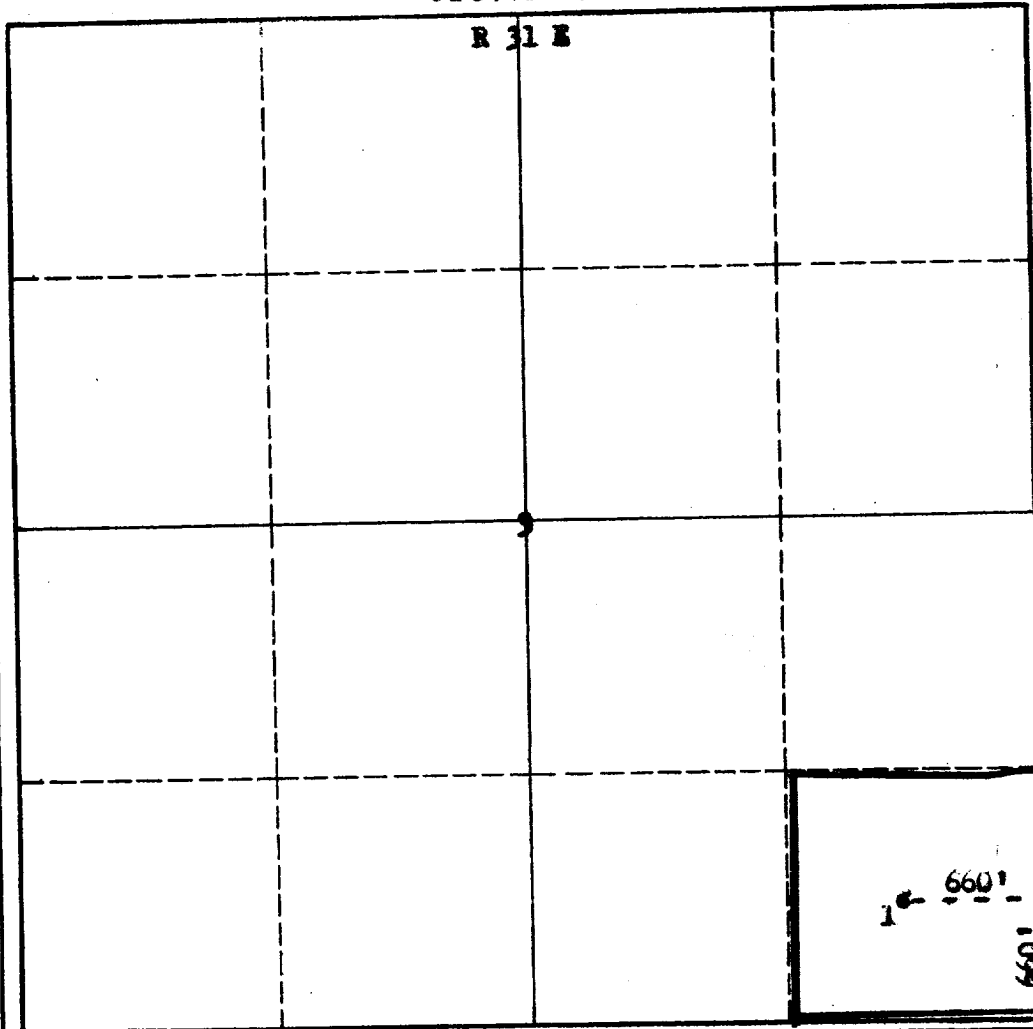

CERTIFICATION

I hereby certify that the information in SECTION A above is true and complete to the best of my knowledge and belief.

Name	CH Hesser
Position	District Superintendent
Company	Continental Oil Company
Date	10-27-60

I hereby certify that the well location shown on the plat in SECTION B was plotted from field notes of actual surveys made by me or under my supervision, and that the same is true and correct to the best of my knowledge and belief.

Date Surveyed	October, 24, 1960
Registered Professional Engineer and/or Land Surveyor	James M. Dixon

Certificate No.
N.M.L.S. No. 542

0 330 660 990 1320 1650 1980 2310 2640 2000 1500 1000 500 0

T
16
S

INSTRUCTIONS FOR COMPLETION OF FORM C-128

1. Operator shall furnish and certify to the information called for in Section A.
2. Operator shall outline the dedicated acreage for *both* oil and gas wells on the plat in Section B.
3. A registered professional engineer or land surveyor registered in the State of New Mexico or approved by the Commission shall show on the plat the location of the well and certify this information in the space provided.
4. All distances shown on the plat must be from the outer boundaries of the Section.
5. If additional space is needed for listing owners and their respective interests as required in question 3 of Section A, please use space below.

OIL CONSERVATION COMMISSION	
ARTESIA DISTRICT OFFICE	
No. Copies Received	6
DISTRIBUTION	
	NO RECORDS
OPERATOR	1
SANTA FE	1
PRORATION OFFICE	
STATE LAND OFFICE	1
U. S. G. S.	2
TRANSPORTER	
FILE	1
BUREAU OF MINES	