

(SUBMIT IN TRIPLICATE)

UNITED STATES
DEPARTMENT OF THE INTERIOR
GEOLOGICAL SURVEY

Land Office **New Mexico**
Lease No. **04431**
Unit **RECEIVED**

OCT 5 1961

O. C. C.
OFFICE

SUNDRY NOTICES AND REPORTS ON WELLS

NOTICE OF INTENTION TO DRILL.....	<input checked="" type="checkbox"/>	SUBSEQUENT REPORT OF WATER SHUT-OFF.....
NOTICE OF INTENTION TO CHANGE PLANS.....		SUBSEQUENT REPORT OF SHOOTING OR ACIDIZING.....
NOTICE OF INTENTION TO TEST WATER SHUT-OFF.....		SUBSEQUENT REPORT OF ALTERING CASING.....
NOTICE OF INTENTION TO RE-DRILL OR REPAIR WELL.....		SUBSEQUENT REPORT OF RE-DRILLING OR REPAIR.....
NOTICE OF INTENTION TO SHOOT OR ACIDIZE.....		SUBSEQUENT REPORT OF ABANDONMENT.....
NOTICE OF INTENTION TO PULL OR ALTER CASING.....		SUPPLEMENTARY WELL HISTORY.....
NOTICE OF INTENTION TO ABANDON WELL.....		

(INDICATE ABOVE BY CHECK MARK NATURE OF REPORT, NOTICE, OR OTHER DATA)

September 28, 1961

Federal "A"

Well No. **3-3** is located **360** ft. from **{NW}** line and **1900** ft. from **{E}** line of sec. **3**

SW 1/4 Sec. 3 **16S** **31E** **N.M.P.M.**
(1/4 Sec. and Sec. No.) (Twp.) (Range) (Meridian)

North Square Lake Grayburg **Madry** **New Mexico**
(Field) (County or Subdivision) (State or Territory)

The elevation of the derrick floor above sea level is **4253** ft.

DETAILS OF WORK

(State names of and expected depths to objective sands; show sizes, weights, and lengths of proposed casings; indicate drilling jobs, cementing points, and all other important proposed work)

RECEIVED

OCT 2 1961

We propose to drill a 3650' Grayburg sand test with rotary.

We will set approximately 890' of 8 5/8" surface casing into the Anhydrite and cement with 100 sacks.

We will run approximately 3650' of 4 1/2" casing as the oil string and cement with 200 sacks.

All casing will be run and cemented as as to meet with the U. S. Geological Survey's approval.

I understand that this plan of work must receive approval in writing by the Geological Survey before operations may be commenced.

Company **John H. Trigg**

Address **P. O. Box 520**

Roswell, New Mexico

By **John H. Trigg**
Title **Owner**

NEW MEXICO OIL CONSERVATION COMMISSION
WELL LOCATION AND ACREAGE DEDICATION PLAT

FORM C-128
 Revised 5/1/57

SEE INSTRUCTIONS FOR COMPLETING THIS FORM ON THE REVERSE SIDE

SECTION A

Operator John H. Trigg		Lease Federal "A"		Well No. 3-3	
Unit Letter W	Section 3	Township 16 South	Range 31 East	County Eddy	
Actual Footage Location of Well: 560 feet from the South line and 1980 feet from the East line					
Ground Level Elev. 4245	Producing Formation Grayburg Sand		Pool North Spence Lake Grayburg		Dedicated Acreage: 40 Acres

1. Is the Operator the only owner in the dedicated acreage outlined on the plat below? YES ☒ NO ☐ ("Owner" means the person who has the right to drill into and to produce from any pool and to appropriate the production either for himself or for himself and another. (65-3-29 (e) NMSA 1935 Comp.)
2. If the answer to question one is "no," have the interests of all the owners been consolidated by communitization agreement or otherwise? YES ☐ NO ☐ If answer is "yes," Type of Consolidation _____
3. If the answer to question two is "no," list all the owners and their respective interests below:

Owner	Land Description

SECTION B

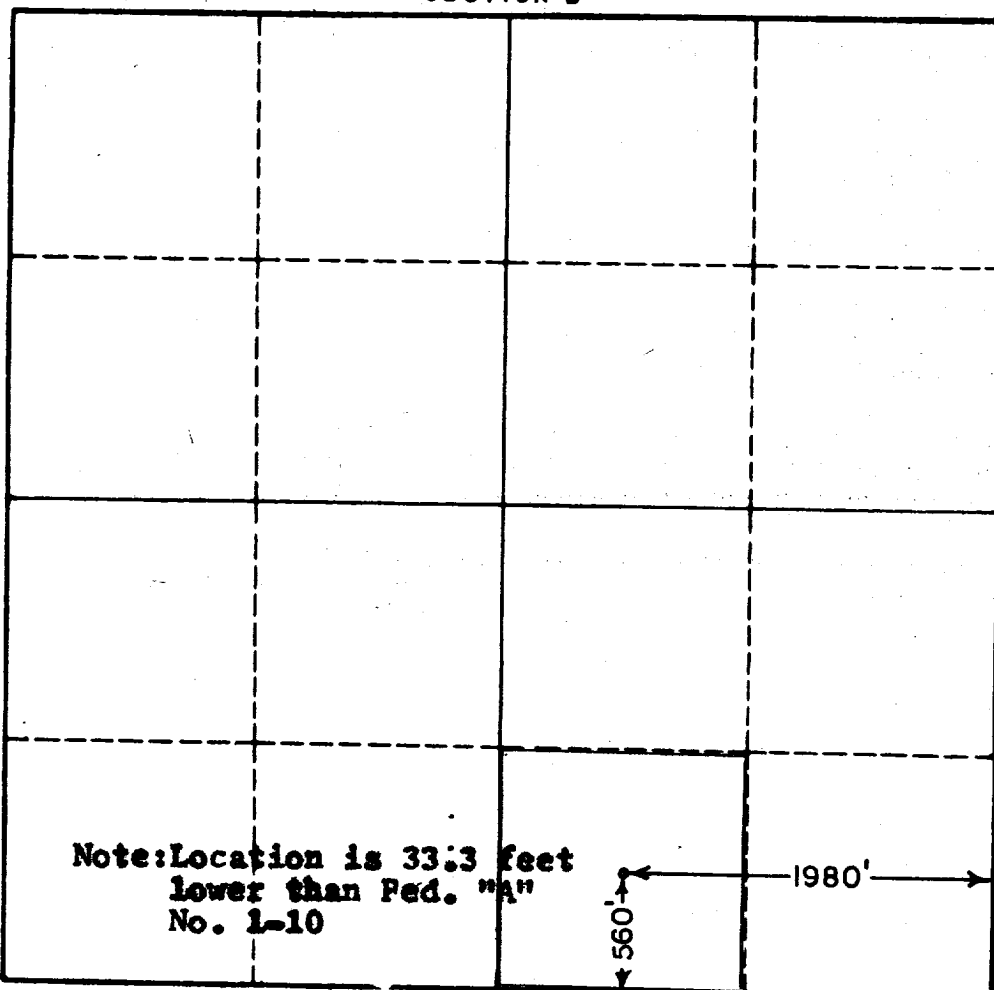

RECEIVED

OCT 3 1961

U. S. GEOLOGICAL SURVEY
 ARTESIA, NEW MEXICO

I hereby certify that the information in SECTION A above is true and complete to the best of my knowledge and belief.

Name John H. Trigg
Position Owner
Company John H. Trigg
Date September 24, 1961

I hereby certify that the well location shown in SECTION B was plotted from first hand or from surveys made by me or under my supervision, and that the same is true and correct to the best of my knowledge and belief.

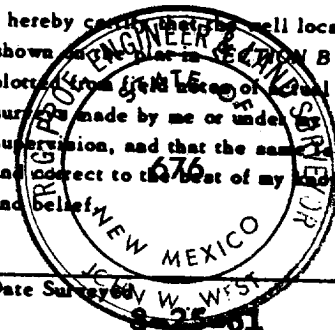

Date Surveyed 9-25-61
Registered Professional Engineer and/or Land Surveyor, JOHN W. WEST
Certificate No. John W. West
N. M. - P. E. & L. S. NO. 676