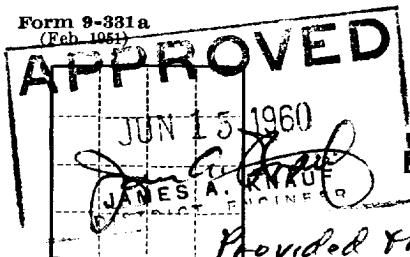

Form 9-331a  
(Feb. 1959)

(SUBMIT IN TRIPLICATE)

 UNITED STATES  
 DEPARTMENT OF THE INTERIOR  
 GEOLOGICAL SURVEY

 Land Office **Las Cruces**  
 Lease No. **RECEIVED**
Unit **JUN 20 1960**
**O. C. C.**  
**ARTESIA, OFFICE**

*Provided that the U.S.G.S. be notified prior to cementing the production string*

## SUNDRY NOTICES AND REPORTS ON WELLS

NOTICE OF INTENTION TO DRILL	<input checked="" type="checkbox"/>	SUBSEQUENT REPORT OF WATER SHUT-OFF	
NOTICE OF INTENTION TO CHANGE PLANS		SUBSEQUENT REPORT OF SHOOTING OR ACIDIZING	
NOTICE OF INTENTION TO TEST WATER SHUT-OFF		SUBSEQUENT REPORT OF ALTERING CASING	
NOTICE OF INTENTION TO RE-DRILL OR REPAIR WELL		SUBSEQUENT REPORT OF RE-DRILLING OR REPAIR	
NOTICE OF INTENTION TO SHOOT OR ACIDIZE		SUBSEQUENT REPORT OF ABANDONMENT	
NOTICE OF INTENTION TO PULL OR ALTER CASING		SUPPLEMENTARY WELL HISTORY	
NOTICE OF INTENTION TO ABANDON WELL			

(INDICATE ABOVE BY CHECK MARK NATURE OF REPORT, NOTICE, OR OTHER DATA)

June 14, 1960

Federal "PV"  
 Well No. **1-3** is located **1980** ft. from **NE** line and **640** ft. from **E** line of sec. **3**  
**NE/4SE/4** Sec. **3** **163** **31E** **N.M.P.M.**  
 (1/4 Sec. and Sec. No.) (Twp.) (Range) (Meridian)  
**Wildcat** **Elddy** **New Mexico**  
 (Field) (County or Subdivision) (State or Territory)

The elevation of the derrick floor above sea level is **4095** ft.

## DETAILS OF WORK

(State names of and expected depths to objective sands; show sizes, weights, and lengths of proposed casings; indicate mudding jobs, cementing points, and all other important proposed work)

We plan to drill a 3600' Grayburg sand test, using rotary tools.

We propose to set 150' of 8 3/8" surface casing with 75 sacks.

We plan to core the lower Grayburg sands, and set a 5 1/2" oil string on bottom with 100 sacks.

All casing will be run and cemented under methods approved by the U. S. Geological Survey.

I understand that this plan of work must receive approval in writing by the Geological Survey before operations may be commenced.

Company **John H. Trigg**Address **P. O. Box 5639****Doanell, New Mexico**By **John H. Trigg**  
Title **Owner**

# NEW MEXICO OIL CONSERVATION COMMISSION WELL LOCATION AND ACREAGE DEDICATION PLAT

FORM C-128  
Revised 5/1/57

**SEE INSTRUCTIONS FOR COMPLETING THIS FORM ON THE REVERSE SIDE**

## SECTION A

Operator <b>John H. Trigg</b>			Lease <b>Federal PV</b>		Well No. <b>1-3</b>
Unit Letter <b>Q</b>	Section <b>5</b>	Township <b>16 South</b>	Range <b>31 East</b>	County <b>Eddy County</b>	
Actual Footage Location of Well: <b>1980</b> feet from the <b>South</b> line and <b>660</b> feet from the <b>East</b> line					
Ground Level Elev. <b>4088</b>	Producing Formation <b>Grayburg Sand</b>		Pool <b>Undesignated</b>		Dedicated Acreage: <b>40</b> Acres

1. Is the Operator the only owner in the dedicated acreage outlined on the plat below? YES ☒ NO ☐ ("Owner" means the person who has the right to drill into and to produce from any pool and to appropriate the production either for himself or for himself and another. (61-3-29 (c) NMSA 1935 Comp.)
2. If the answer to question one is "no," have the interests of all the owners been consolidated by communization agreement or otherwise? YES ☐ NO ☐ . If answer is "yes," Type of Consolidation \_\_\_\_\_
3. If the answer to question two is "no," list all the owners and their respective interests below:

RECEIVED

Owner	Land Description
	JUN 15 1960 U. S. GEOLOGICAL SURVEY ARTESIA, NEW MEXICO

## SECTION B

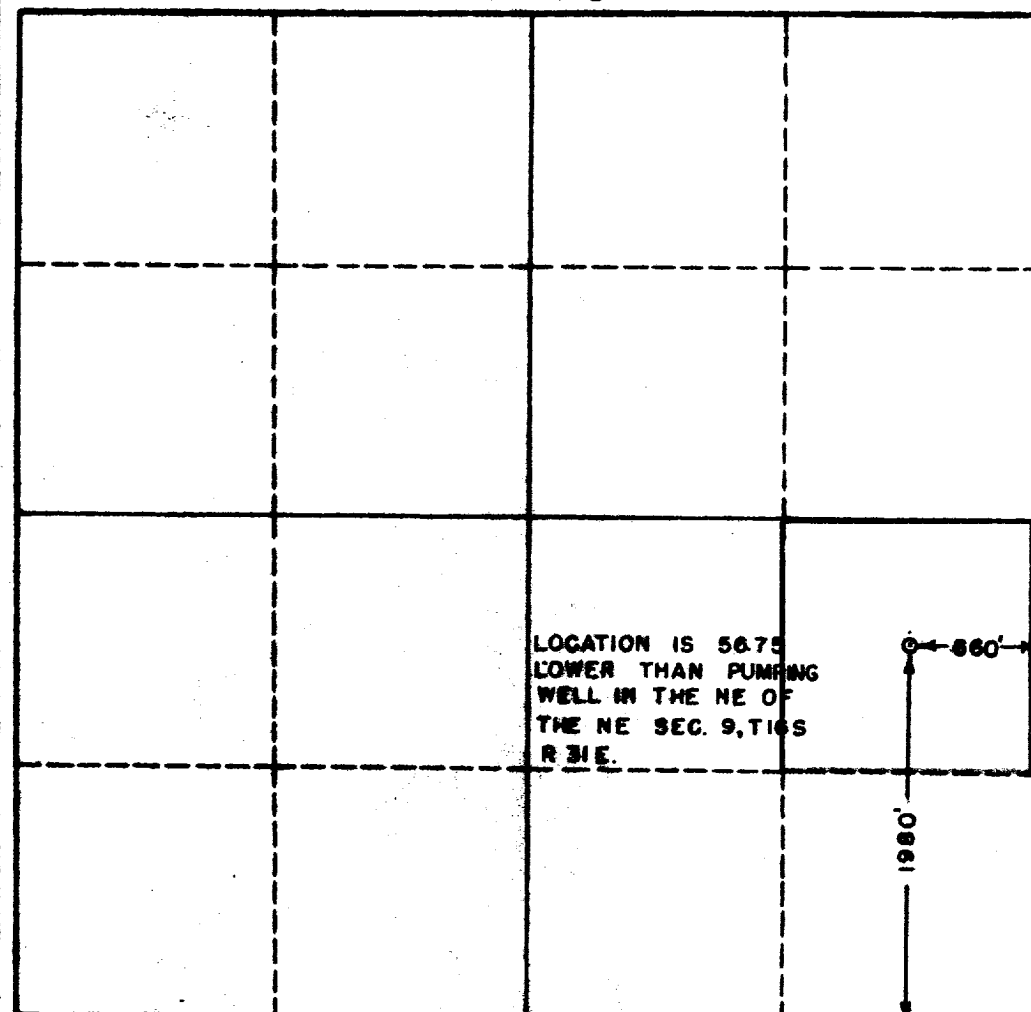

## CERTIFICATION

I hereby certify that the information in SECTION A above is true and complete to the best of my knowledge and belief.

Name <i>John H. Trigg</i>
Position Owner
Company John H. Trigg
Date June 14, 1960

I hereby certify that the well location shown on the plat in SECTION B was plotted from the actual survey made by me or under my supervision, and that the same is true and correct to the best of my knowledge and belief. 676

Date Surveyed JUN 15 1960
Registered Professional Engineer and/or Land Surveyor, JOHN W. WEST
Certificate No. N.M. - P.E. & L.S. NO. 676

0 300 600 900 1200 1500 1800 2100 2400 2700 3000 3300 3600 3900 4200 4500 4800 5100 5400 5700 6000 0