

C/S 7

Form 9-331
Dec. 1973

NM OIL CONS. COMMISSION
Drawer DD
Artesia, NM 88210

Form Approved
Budget Bureau No 42-R1424

UNITED STATES
DEPARTMENT OF THE INTERIOR
GEOLOGICAL SURVEY

SUNDRY NOTICES AND REPORTS ON WELLS

(Do not use this form for proposals to drill or to deepen or plug back to a different reservoir. Use Form 9-331-C for such proposals.)

1. oil well gas well other Water Injection Well

2. NAME OF OPERATOR
Mobil Producing TX. & N.M. Inc.

3. ADDRESS OF OPERATOR
Nine Greenway Plaza,
Suite 2700, Houston, TX 77046

4. LOCATION OF WELL (REPORT LOCATION CLEARLY. See space 17 below.)
AT SURFACE: 660' FNL & 2310' FWL S9, T16S, R31E
AT TOP PROD. INTERVAL: Same as surface
AT TOTAL DEPTH: Same as surface

16. CHECK APPROPRIATE BOX TO INDICATE NATURE OF NOTICE, REPORT, OR OTHER DATA

5. LEASE
NM - 026332

6. IF INDIAN, ALLOTTEE OR TRIBE NAME

7. UNIT AGREEMENT NAME
North East Square Lake Premier Unit

8. FARM OR LEASE NAME

9. WELL NO.
14

10. FIELD OR WILDCAT NAME
North Square Lake, G-SA

11. SEC., T., R., M., OR BLK. AND SURVEY OR AREA
Sec. 9, T-16S, R-31E

12. COUNTY OR PARISH 13. STATE
Eddy | New Mexico

14. API NO.

15. ELEVATIONS (SHOW DF, KDB, AND WD)
4100 GR, 4111 DF, 4112 KB

REQUEST FOR APPROVAL TO: SUBSEQUENT REPORT OF:

TEST WATER SHUT-OFF	<input type="checkbox"/>		<input type="checkbox"/>
FRACTURE TREAT	<input type="checkbox"/>		<input type="checkbox"/>
SHOOT OR ACIDIZE	<input type="checkbox"/>		<input type="checkbox"/>
REPAIR WELL	<input type="checkbox"/>		<input type="checkbox"/>
PULL OR ALTER CASING	<input type="checkbox"/>		<input type="checkbox"/>
MULTIPLE COMPLETE	<input type="checkbox"/>		<input type="checkbox"/>
CHANGE ZONES	<input type="checkbox"/>		<input type="checkbox"/>
ABANDON*	<input checked="" type="checkbox"/>		<input type="checkbox"/>
(other)	<input type="checkbox"/>		<input type="checkbox"/>

RECEIVED BY
FEB 01 1984
O. C. D.
ARTESIA, OFFICE

RECEIVED
DEC 14 10 08 AM '83
BUR. OF LAND MGMT
ROSEBUD DISTRICT

17. DESCRIBE PROPOSED OR COMPLETED OPERATIONS (Clearly state all pertinent details, and give pertinent dates, including estimated date of starting any proposed work. If well is directionally drilled, give subsurface locations and measured and true vertical depths for all markers and zones pertinent to this work.)*

- TD 3606, PBDT 3597, 3560-3565 Premier Perfs, Casing Record 8-5/8 @ 177, 3-1/2 @ 3606
- (1) Set cement retainer at 3550' and squeeze perfs at 3560-3565 with 30 sacks of class C neat cement.
 - (2) Spot 4 sacks of class C cement on cement retainer from 3550' to 3440'.
 - (3) Perforate with 4 JSPF at 2107'.
 - (4) Set cement retainer at 2100' and squeeze perfs at 2107' with 30 sacks class C neat cement.
 - (5) Spot 4 sacks of class C cement on cement retainer from 2100 to 1997.
 - (6) Perforate with 4 JSPF at 900'.
 - (7) Set cement retainer at 895' and squeeze perfs at 900' with 30 sacks of class C cement.
 - (8) Spot 35 sacks of class C neat cement on cement retainer from 895' to surface.
 - (9) Erect P&A marker and clean location.

Subsurface Safety Valve: Manu. and Type _____ Set @ _____ Ft.

18. I hereby certify that the foregoing is true and correct
SIGNED Paula A. Collins TITLE Authorized Agent DATE 12/12/83

APPROVED (This space for Federal or State office use)
(Sgd.) W. CHESTER TITLE _____ DATE _____

CONDITIONS OF APPROVAL IF ANY:

JAN 31 1984

*See instructions on Reverse Side

DATE 4-6-83 WELL NO. 1A W/W LEASE NORTHEAST SQ. LAKE FIELD NORTH SQ. LAKE 6/SA

LOCATION C-9-165-31E COUNTY EDDY STATE NM GL 4100'

ORIG. COMPL. DATE 3-13-62

SIGNED W.T. BURNETT

DF 4111'

FORM. JACO LAWLESS INC GULF FE FED #2

KB 4112'

ZERO 11' ASL

CURRENT

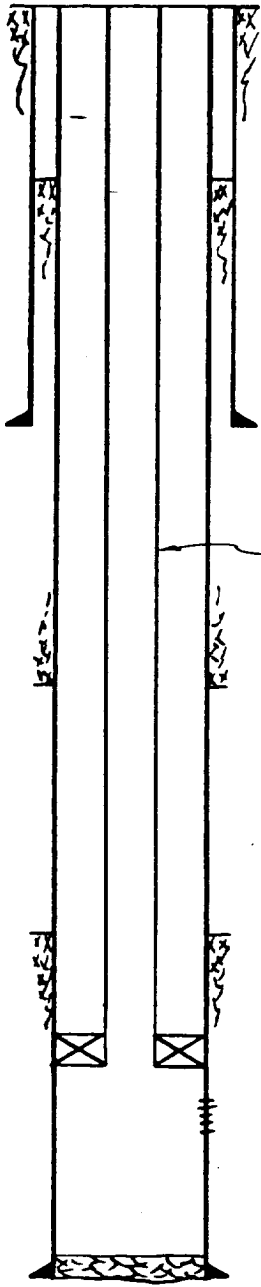

— TDC N/A

— 8 5/8" 24# J-55 CSG SET @ 177' w/ 100SX CMT.

— 109 JTS OF 2 1/4" IN CL TBG

— EST. TDC @ 2500'

— 3/4" JOHNSTON 101-5 TENSION PKR SET @ 3517' w/ 7PTS T

— PREMIER PERFS: 3560-65' FRACED W/ 20,000 GAL OIL & 40,000 GAL SAND

— 3/2" 8.5# CSG SET @ 3606' w/ 200 SX + 100 SX DOWN 760' OF 1" TBG OUTSIDE CSG.

TD 3606'
FBTD 3597'

DATE 10-25-82 WELL NO. 14W11W LEASE NE 20 Lake Premier Ut FIELD 29 Lake Griggs 2-1-1982

LOCATION C-9-160-31E
 660' FOL & 2310' FWL
 Eddy County, New Mexico

SIGNED W/L REEVES

G.L. 4100'
 D.F. 4111'
 K.B. 4112'
 ZERO 11' AGL

PROPOSED

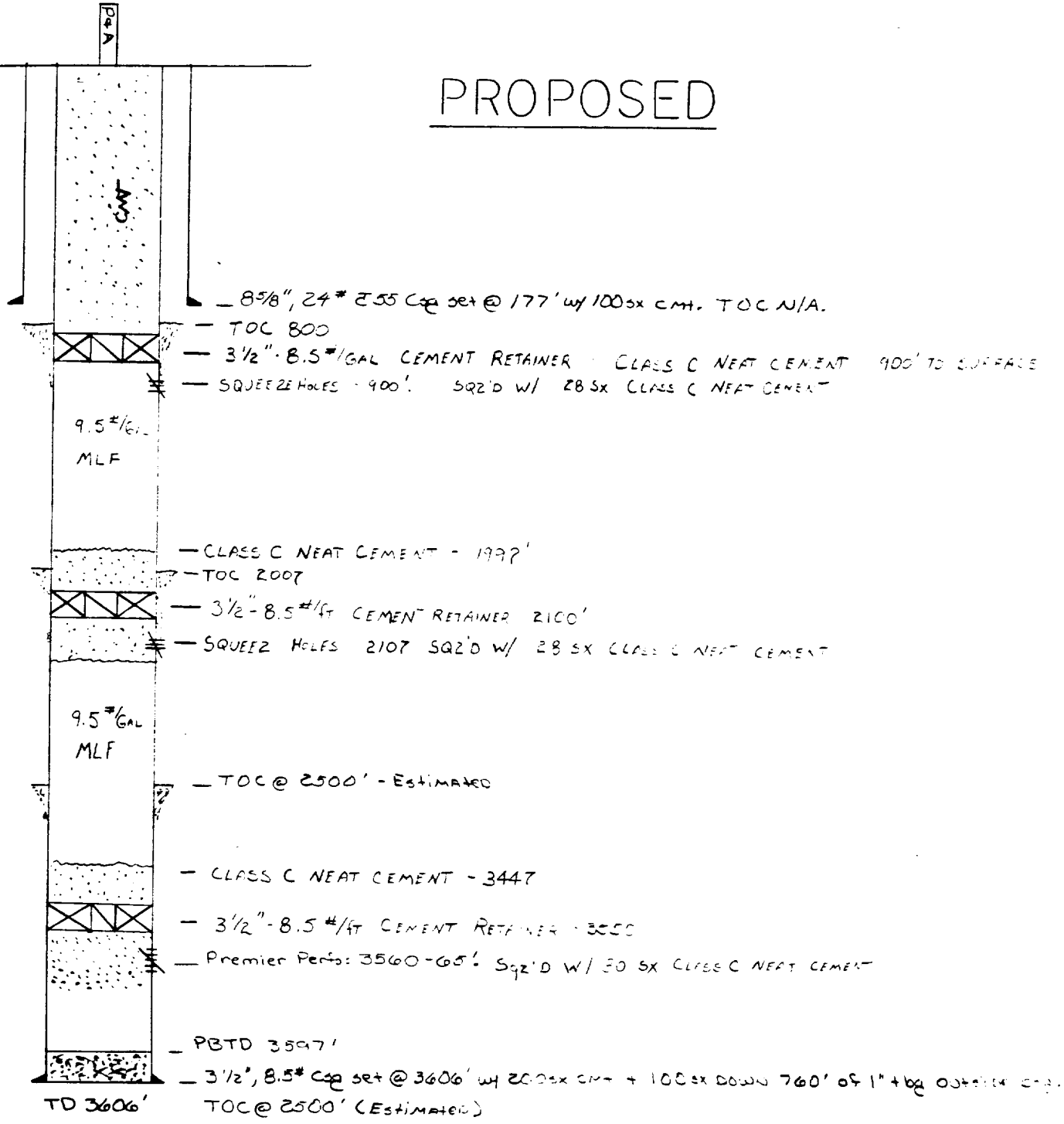

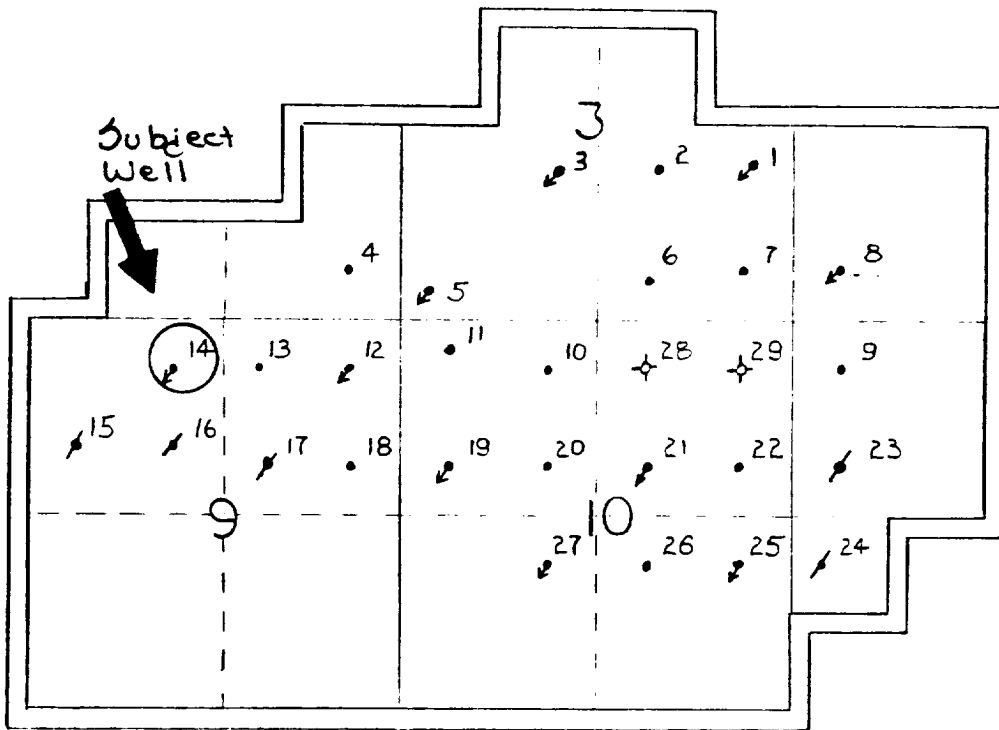

T
16
S

R31E

NESLU
EDDY CO, NM

STATEMENT OF SURFACE RESTORATION INTENTION
ATTACHMENT TO USGS FORM 9-331, SUNDRY NOTICE OF INTENT TO ABANDON

Applicable To: Mobil Producing Texas & New Mexico Inc.
Nine Greenway Plaza, Suite 2700
Houston, TX 77046

Lease Name: North East Square Lake Premier Unit

Well No: 14

Location: 660' FNL & 2310' FWL of Sec. 9, T-16S, R-31E

This is to advise your office that surface restoration associated with the above described proposed plugging and abandonment will be conducted in accordance with applicable rules and regulations of the United States Geological Survey and the New Mexico Oil Conservation Commission; and in accordance with any existent agreement with the surface landowner, or in a manner arrived at by agreement with the surface landowner.

Such restoration work will include:

Backfilling of all pits and cellar. Levelling or contouring the location site. Clearing the location area of junk.

FORM 9-331 Dated: 12/12/83