

**UNITED STATES
DEPARTMENT OF THE INTERIOR
GEOLOGICAL SURVEY**

SUNDRY NOTICES AND REPORTS ON WELLS

(Do not use this form for proposals to drill or to deepen or plug back to a different reservoir. Use Form 9-331-C for such proposals.)

1. ☒ Oil well ☐ Gas well ☐ other Water Injection Well

2. NAME OF OPERATOR
Mobil Producing TX. & N.M. Inc.

3. ADDRESS OF OPERATOR Nine Greenway Plaza,
Suite 2700, Houston, TX 77046

4. LOCATION OF WELL (REPORT LOCATION CLEARLY. See space 17 below.)
AT SURFACE: 1980'FWL & 2310'FSL S10,T16S,R31E
AT TOP PROD. INTERVAL: Same as surface
AT TOTAL DEPTH: Same as surface

15. CHECK APPROPRIATE BOX TO INDICATE NATURE OF NOTICE, REPORT, OR OTHER DATA

REQUEST FOR APPROVAL TO:

TEST WATER SHUT-OFF ☐
FRACTURE TREAT ☐
SHOOT OR ACIDIZE ☐
REPAIR WELL ☐
PULL OR ALTER CASING ☐
MULTIPLE COMPLETE ☐
CHANGE ZONES ☐
ABANDON* ☒
(other) ☐

SUBSEQUENT REPORT OF:

☐
☐
☐
☐
☐
☐
☐
☐
☐
☐

RECEIVED BY

FEB 01 1984

O. C. D.

ARTESIA, OFFICE

(NOTE: Report results of multiple completion on or zone change on Form 9-331-C)

17. DESCRIBE PROPOSED OR COMPLETED OPERATIONS (Clearly state all pertinent details, and give pertinent dates, including estimated date of starting any proposed work. If well is directionally drilled, give subsurface locations and measured and true vertical depths for all markers and zones pertinent to this work.)*

TD 3868, PBDT 3745, Premier Perfs 3676-3738, Casing Record 8-5/8 @ 210, 4-1/2 @ 3865

- (1) Set cement retainer at 3600' and squeeze perfs @ 3676-3738 with 30 sacks class C neat cement.
- (2) Spot 4 sacks of class C neat cement on top of retainer 3600' to 3539'.
- (3) Perforate w/ 4 JSPF @ 2230' and set a cement retainer at 2220'. Squeeze perfs with 30 sacks of class C neat cement.
- (4) Spot 4 sacks of class C neat cement on retainer 2220' to 2159'.
- (5) Perforate w/ 4 JSPF @ 850' and set a cement retainer at 840'. Squeeze perfs with 30 sacks of class C neat cement.
- (6) Spot 55 sacks of class C neat cement on retainer 840' to surface.
- (7) Erect P&A marker and clean location.

Subsurface Safety Valve: Manu. and Type _____ Set @ _____ Ft.

18. I hereby certify that the foregoing is true and correct

SIGNED Paula A. Collins TITLE Authorized Agent DATE 12/12/83

APPROVED

(This space for Federal or State office use)

(Orig. Sgd.) _____

APPROVED BY _____
CONDITIONS OF APPROVAL IF ANY:

TITLE _____ DATE _____

JAN 31 1984

DATE 4-5-83 WELL NO. 2 LEASE N/E Square Lake Pr. Unit FIELD NO. 50. Lake G/SA

LOCATION K-10-163-31E COUNTY Eddy STATE New Mexico GL 4191'

Orig. Comp. Date - 4/10/61

Formerly Std. of Tx Feb 15-10 #6 SIGNED M. W. DEER

DF 4199'

KB 4202'

ZERO 11' ASL

CURRENT

8 5/8", 36" csg set @ 210' w/ 1250x cmt.

117 JTS OF 2 3/8" CL TBS

TOC @ 3100' (Cmt Base Log).

4 1/2" JOHNSTON 101-S PC TENSION PKR SET @ 3631' w/ 14 PTS T

Perfs: 3667'-69'. 502'0 w/ 2320x cmt.

Premier Perfs: 3676-78, 82-93, 372A-38. 225 PF.

Perfs: 3760-62'. 502'0 w/ 700x cmt.

PBTD 3795'

4 1/2", 11.6" csg set @ 3865' w/ 4500x cmt.

TD 3868'

DATE 11/22/83 WELL NO. 27 LEASE NE Sp. Lake Premier U FIELD Sp. Lake Group A North

LOCATION K-10-165-31E

SIGNED W L REEVES

G.L. 4191'

D.F. 4199'

K.B. 4202'

ZERO 11' AGI

2310' FSL & 1980' FWL

Eddy County, New Mexico

PROPOSED

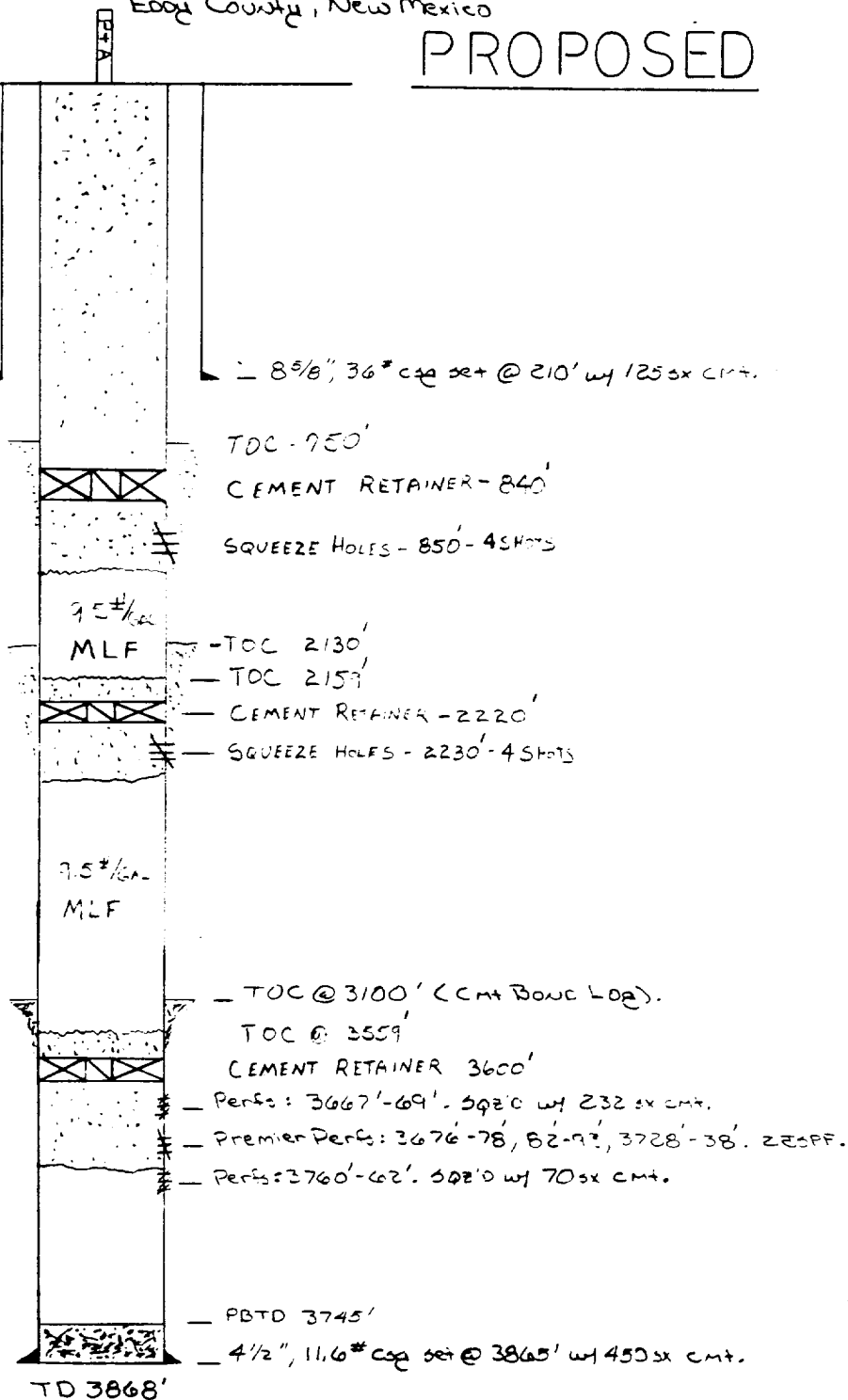

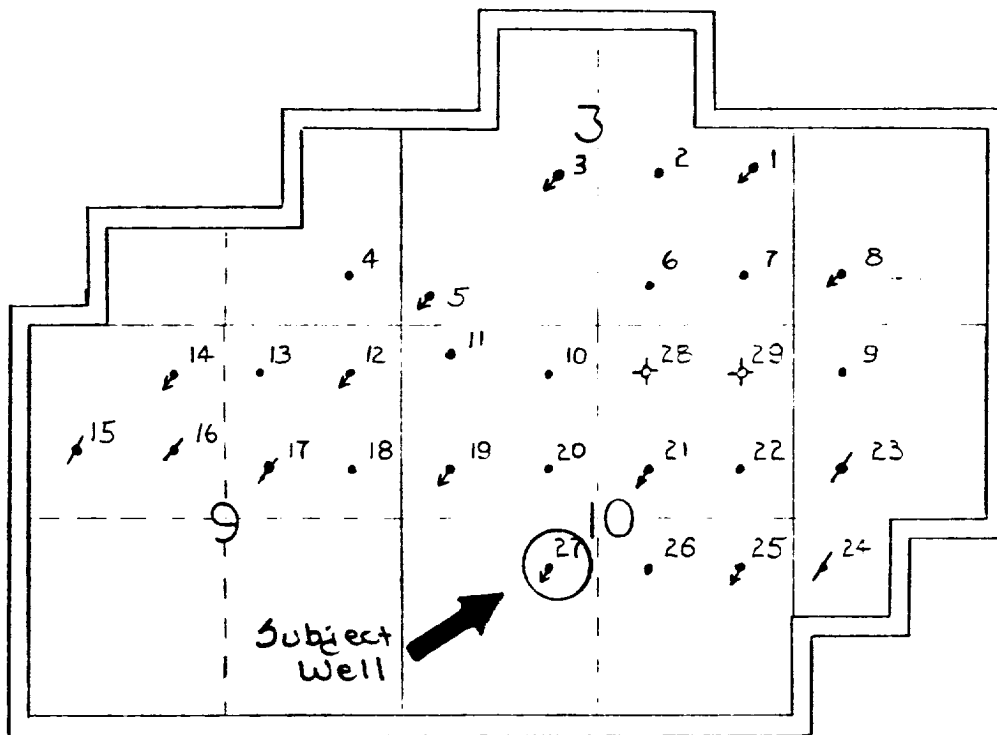

T
16
S

R31E

NESLU
EDDY CO, NM

STATEMENT OF SURFACE RESTORATION INTENTION
ATTACHMENT TO USGS FORM 9-331, SUNDRY NOTICE OF INTENT TO ABANDON

Applicable To: Mobil Producing Texas & New Mexico Inc.
Nine Greenway Plaza, Suite 2700
Houston, TX 77046

Lease Name: North East Square Lake Premier Unit

Well No: 27

Location: 1980' FWL & 2310' FSL of Sec. 10, T 16S, R 31E

This is to advise your office that surface restoration associated with the above described proposed plugging and abandonment will be conducted in accordance with applicable rules and regulations of the United States Geological Survey and the New Mexico Oil Conservation Commission; and in accordance with any existent agreement with the surface landowner, or in a manner arrived at by agreement with the surface landowner.

Such restoration work will include:

Backfilling of all pits and cellar. Levelling or contouring the location site. Clearing the location area of junk.

FORM 9-331 Dated: 12/12/83