

N. M. O. C. C.

Form 9-331a  
(Feb. 1951)

(SUBMIT IN TRIPLICATE)

Land Office New Mexico

Lease No. 100

Unit J

APR 12 1961

N. M. O. C. C.  
ARTESIA, OFFICE

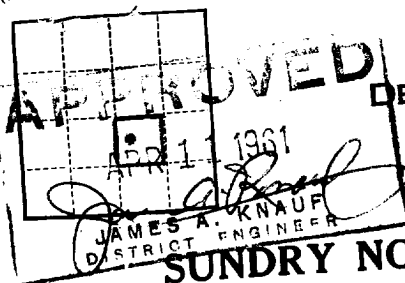

UNITED STATES  
DEPARTMENT OF THE INTERIOR  
GEOLOGICAL SURVEY

SUNDRY NOTICES AND REPORTS ON WELLS

NOTICE OF INTENTION TO DRILL	<input checked="" type="checkbox"/>	SUBSEQUENT REPORT OF WATER SHUT-OFF	
NOTICE OF INTENTION TO CHANGE PLANS		SUBSEQUENT REPORT OF SHOOTING OR ACIDIZING	
NOTICE OF INTENTION TO TEST WATER SHUT-OFF		SUBSEQUENT REPORT OF ALTERING CASING	
NOTICE OF INTENTION TO RE-DRILL OR REPAIR WELL		SUBSEQUENT REPORT OF RE-DRILLING OR REPAIR	
NOTICE OF INTENTION TO SHOOT OR ACIDIZE		SUBSEQUENT REPORT OF ABANDONMENT	
NOTICE OF INTENTION TO PULL OR ALTER CASING		SUPPLEMENTARY WELL HISTORY	
NOTICE OF INTENTION TO ABANDON WELL			

(INDICATE ABOVE BY CHECK MARK NATURE OF REPORT, NOTICE, OR OTHER DATA)

Well No. 5 is located 2310 ft. from N line and 1980 ft. from E line of sec. 10  
160 (Twp.) 31E (Range) 14N (Meridian)  
North Square Lake (30) (Field) Eddy (County or Subdivision) New Mexico (State or Territory)

The elevation of the derrick floor above sea level is 4229 ft.

DETAILS OF WORK

(State names of and expected depths to objective sands; show sizes, weights, and lengths of proposed casings; indicate mudding jobs, cementing points, and all other important proposed work)

Gackle Drilling Company will drill this well. Surface pipe will be set at 200' using 8-5/8", 36", J-55 new csg. Cement will be set to surface. After 24 hrs. test csg to 1000 PSI, drill out w/6-3/4" bit and drill to total depth of approx. 3900'. Premier sands will be cored. At total depth 4 1/2", 11.6" J-55 csg will be cemented using two stages, 1st stage thru shoe and 2nd stage thru collar at 1000'. 24 hrs and test 4 1/2" csg to 1500 Psi. Completion will be through perforations with free for stimulation.

RECEIVED

APR 11 1961

U. S. GEOLOGICAL SURVEY  
ARTESIA, NEW MEXICO

I understand that this plan of work must receive approval in writing by the Geological Survey before operations may be commenced.

Company Standard Oil Company of Texas, A Division of California Oil Company

Address Drawer "3"  
Monahans, Texas

By C. F. Dwyer  
Title District Engineer

NEW MEXICO OIL CONSERVATION COMMISSION  
WELL LOCATION AND ACREAGE DEDICATION PLAT

RECEIVED

FORM C-128  
Revised 5/1/57

SEE INSTRUCTIONS FOR COMPLETING THIS FORM ON THE REVERSE SIDE

D. C. C.

SECTION A

ARTESIA, OFFICE

Operator <b>Standard Oil Company of Texas, A Division of California Oil Company</b>		Lease <b>Natural 14-10</b>		Well No. <b>5</b>	
Unit Letter <b>J</b>	Section <b>10</b>	Township <b>16S</b>	Range <b>11E</b>	County <b>El Paso County</b>	
Actual Footage Location of Well: <b>2310'</b> North line and <b>1980'</b> East line					
Ground Level Elev. <b>4220</b>	Producing Formation <b>Premier (Grayburg)</b>		Pool <b>North Square Lake (Grayburg)</b>		Dedicated Acreage: <b>40</b> Acres

1. Is the Operator the only owner in the dedicated acreage outlined on the plat below? YES ☐ NO ☒. ("Owner" means the person who has the right to drill into and to produce from any pool and to appropriate the production either for himself or for himself and another. (65-3-29 (e) NMSA 1935 Comp.)
2. If the answer to question one is "no," have the interests of all the owners been consolidated by communitization agreement or otherwise? YES ☒ NO ☐. If answer is "yes," Type of Consolidation **Unitized**
3. If the answer to question two is "no," list all the owners and their respective interests below:

Owner	Land Description
	<b>APR 11 1961</b>
	<b>U. S. GEOLOGICAL SURVEY</b>
	<b>ARTESIA, NEW MEXICO</b>

SECTION B

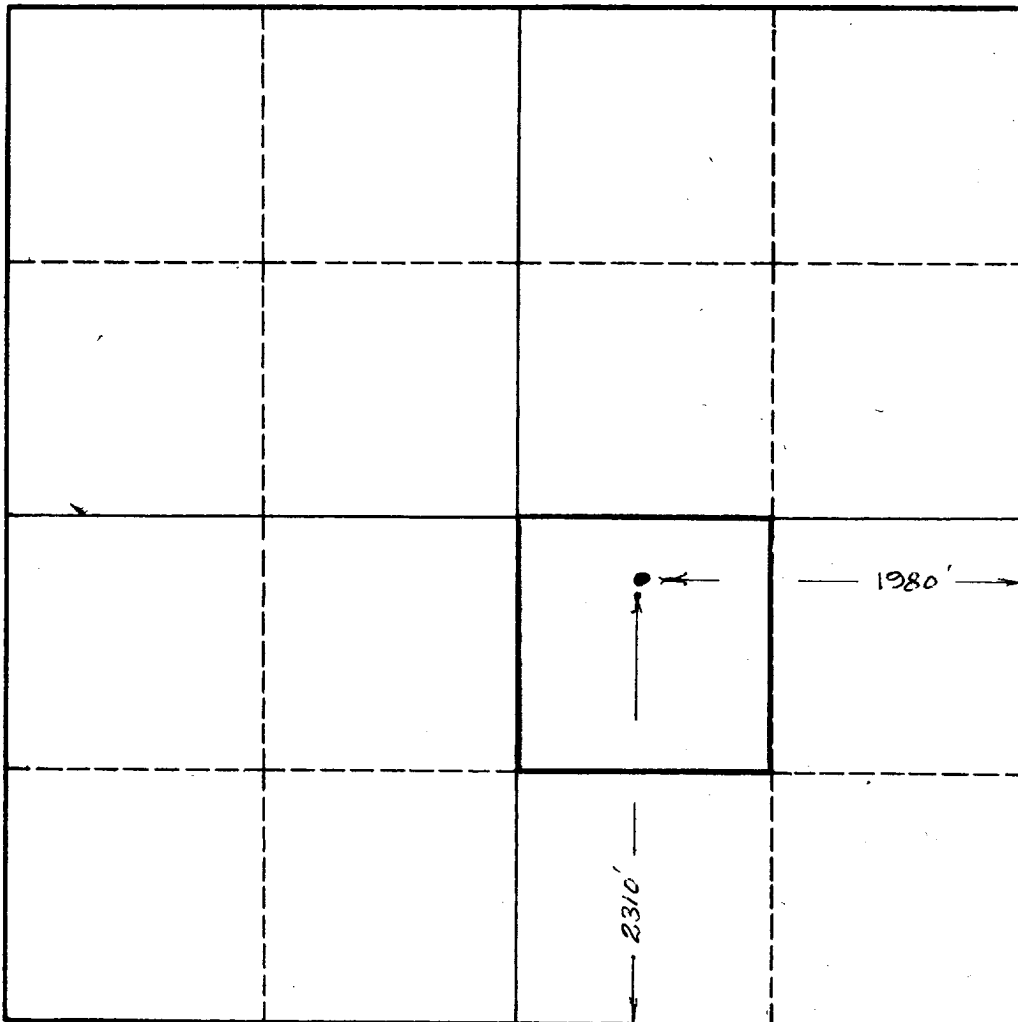

CERTIFICATION

I hereby certify that the information in SECTION A above is true and complete to the best of my knowledge and belief.

Name	<b>C. F. Dwyer</b>
Position	<b>C. F. DWYER</b>
Company	<b>STANDARD OIL CO. OF TEXAS</b>
Date	<b>4/10/61</b>

I hereby certify that the well location shown on the plat in SECTION B was plotted from field notes of actual surveys made by me or under my supervision, and that the same is true and correct to the best of my knowledge and belief.

Date Surveyed	<b>March 2, 1961</b>
<b>James W. Stansel</b>	
Registered Professional Engineer and/or Land Surveyor	

Certificate No.

0 330 660 990 1320 1650 1980 2310 2640 2000 1500 1000 500 0

### INSTRUCTIONS FOR COMPLETION OF FORM C-128

1. Operator shall furnish and certify to the information called for in Section A.
2. Operator shall outline the dedicated acreage for *both* oil and gas wells on the plat in Section B.
3. A registered professional engineer or land surveyor registered in the State of New Mexico or approved by the Commission shall show on the plat the location of the well and certify this information in the space provided.
4. All distances shown on the plat must be from the outer boundaries of the Section.
5. If additional space is needed for listing owners and their respective interests as required in question 3 of Section A, please use space below.