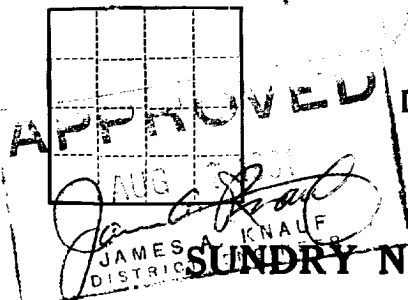

Form 9-331a  
(Feb. 1951)

(SUBMIT IN TRIPLICATE)

Land Office **New Mexico**Lease No. **04421**

Unit

UNITED STATES  
DEPARTMENT OF THE INTERIOR  
GEOLOGICAL SURVEY

## SUNDRY NOTICES AND REPORTS ON WELLS

 RECEIVED  
 AUG 1 1961  
 D. D. C.  
 ARTESIA, NEW MEXICO

NOTICE OF INTENTION TO DRILL	<input checked="" type="checkbox"/>	SUBSEQUENT REPORT OF WATER SHUT-OFF	
NOTICE OF INTENTION TO CHANGE PLANS		SUBSEQUENT REPORT OF SHOOTING OR ACIDIZING	
NOTICE OF INTENTION TO TEST WATER SHUT-OFF		SUBSEQUENT REPORT OF ALTERING CASING	
NOTICE OF INTENTION TO RE-DRILL OR REPAIR WELL		SUBSEQUENT REPORT OF RE-DRILLING OR REPAIR	
NOTICE OF INTENTION TO SHOOT OR ACIDIZE		SUBSEQUENT REPORT OF ABANDONMENT	
NOTICE OF INTENTION TO PULL OR ALTER CASING		SUPPLEMENTARY WELL HISTORY	
NOTICE OF INTENTION TO ABANDON WELL			

(INDICATE ABOVE BY CHECK MARK NATURE OF REPORT, NOTICE, OR OTHER DATA)

August 1

1961

Federal "A"

Well No. **1-10** is located **660** ft. from **N** line and **660** ft. from **E** line of sec. **10**
**NE 1/4 Sec. 10**  
 (1/4 Sec. and Sec. No.)

**16S**  
 (Twp.)

**31E**  
 (Range)

**N.M.P.M.**  
 (Meridian)

**North Square Lake Grayburg**  
 (Field)

**Eddy**  
 (County or Subdivision)

**New Mexico**  
 (State or Territory)
The elevation of the derrick floor above sea level is **4288** ft.

## DETAILS OF WORK

(State names of and expected depths to objective sands; show sizes, weights, and lengths of proposed casings; indicate mudlogging jobs, cementing points, and all other important proposed work)

We plan to drill a 3900' Grayburg test with rotary tools.

We propose to set 100' of used 8 5/8" surface casing and cement it with 25 sacks.

The oil string will be new 4 1/2" cemented through the pay sand at approximately 3930' with sufficient cement to circulate.

All casing will be run and cemented using methods approved by the U. S. Geological Survey.

I understand that this plan of work must receive approval in writing by the Geological Survey before operations may be commenced.

Company **John H. Trigg**Address **P. O. Box 520****Essex, New Mexico**

By

Title

Owner

RECEIVED

NEW MEXICO OIL CONSERVATION COMMISSION  
WELL LOCATION AND ACREAGE DEDICATION PLAT

AUG 10 1961  
FORM C-128  
Revised 5/1/57

SEE INSTRUCTIONS FOR COMPLETING THIS FORM ON THE REVERSE SIDE

SECTION A

Operator <b>John H. Trigg</b>			Lease <b>Federal "A"</b>		Well No. <b>1-10</b>
Unit Letter <b>A</b>	Section <b>10</b>	Township <b>16 South</b>	Range <b>31 East</b>	County <b>Eddy County</b>	
Actual Footage Location of Well: <b>660</b> feet from the <b>North</b> line and <b>660</b> feet from the <b>East</b> line					
Ground Level Elev. <b>4878</b>	Producing Formation <b>Graptolite Sand</b>		Pool <b>North Square Lake Graptolite</b>		Dedicated Acreage: <b>40</b> Acres

1. Is the Operator the only owner in the dedicated acreage outlined on the plat below? YES ☒ NO \_\_\_\_ ("Owner" means the person who has the right to drill into and to produce from any pool and to appropriate the production either for himself or for himself and another. (65-3-29 (e) NMSA 1935 Comp.)
2. If the answer to question one is "no," have the interests of all the owners been consolidated by communitization agreement or otherwise? YES \_\_\_\_ NO \_\_\_\_ . If answer is "yes," Type of Consolidation \_\_\_\_
3. If the answer to question two is "no," list all the owners and their respective interests below:

Owner	Land Description

SECTION B

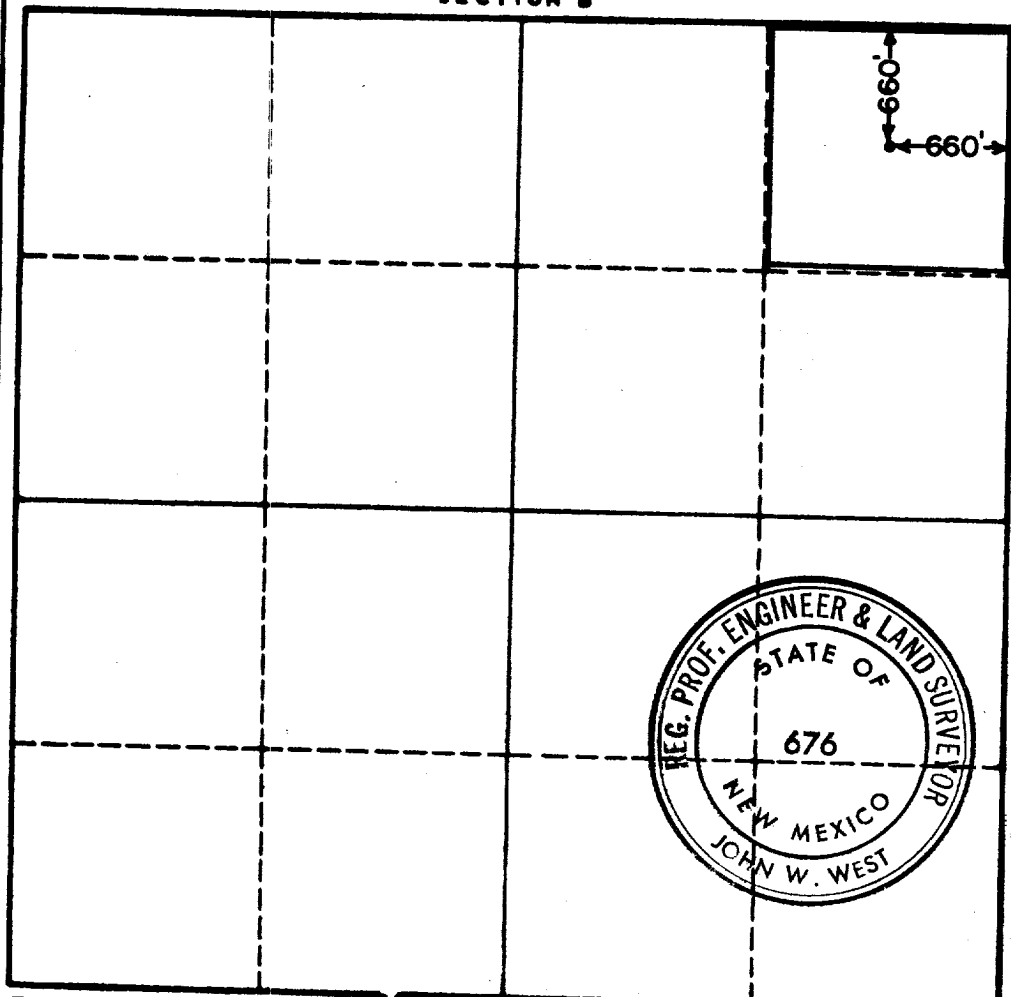

CERTIFICATION

I hereby certify that the information in SECTION A above is true and complete to the best of my knowledge and belief.

*John H. Trigg*  
Name

Position  
**Owner**

Company  
**John H. Trigg**

Date  
**August 1, 1961**

I hereby certify that the well location shown on the plat in SECTION B was plotted from field notes of actual surveys made by me or under my supervision, and that the same is true and correct to the best of my knowledge and belief.

Date Surveyed  
**6-28-61**

Registered Professional Engineer and/or Land Surveyor, **JOHN W. WEST**

*John W. West*  
Signature

Certificate No.  
**N.M. - P.E. & L.S. NO. 676**

